

# 2012 KX™ 65 PARTS DIAGRAM

Crankshaft/Piston(s)

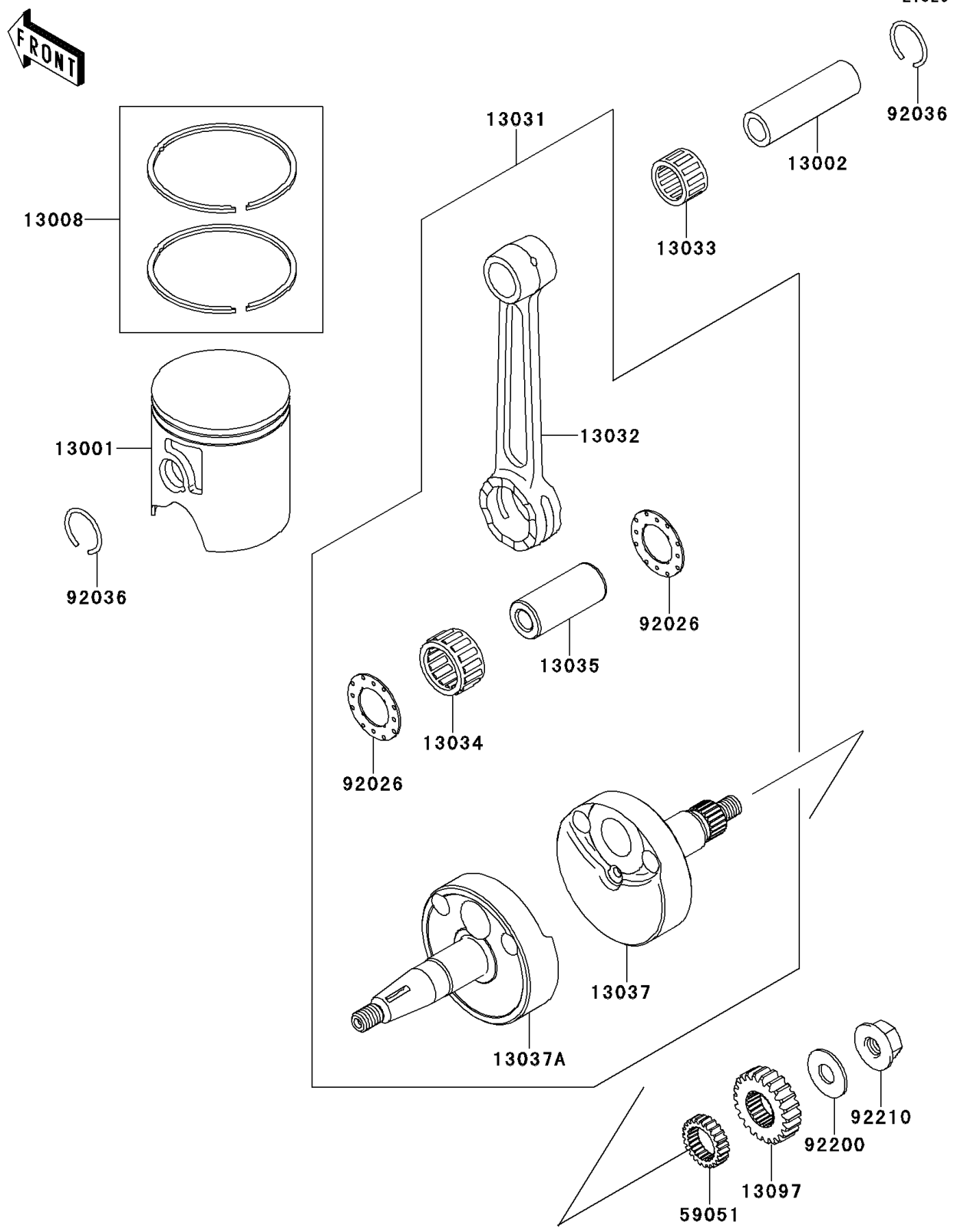

## 2012 KX™ 65 PARTS LIST

### Crankshaft/Piston(s)

| ITEM NAME                                    | PART NUMBER | QUANTITY |
|--|-------------|----------|
| PISTON-ENGINE,B (Ref # 13001)                | 13001-0040  | 1        |
| PIN-PISTON (Ref # 13002)                     | 13002-1119  | 1        |
| RING-SET-PISTON (Ref # 13008)                | 13008-1199  | 1        |
| CRANKSHAFT-COMP (Ref # 13031)                | 13031-0039  | 1        |
| ROD-CONNECTING (Ref # 13032)                 | 13032-1246  | 1        |
| BEARING-SMALL END (Ref # 13033)              | 13033-0002  | 1        |
| BEARING-BIG END,SKTZ 202714EGS (Ref # 13034) | 13034-0012  | 1        |
| PIN-CRANK (Ref # 13035)                      | 13035-1002  | 1        |
| CRANKSHAFT,RH (Ref # 13037)                  | 13037-0049  | 1        |
| CRANKSHAFT,LH (Ref # 13037A)                 | 13037-1615  | 1        |
| GEAR-PRIMARY SPUR,22T (Ref # 13097)          | 13097-0055  | 1        |
| GEAR-SPUR,PUMP,23T (Ref # 59051)             | 59051-1146  | 1        |
| SPACER (Ref # 92026)                         | 92026-1522  | 2        |
| RING-SNAP,PISTON PIN (Ref # 92036)           | 92036-007   | 2        |
| WASHER,10.2X25X1.5 (Ref # 92200)             | 92200-0213  | 1        |
| NUT,FLANGED,M10XL1.25 (Ref # 92210)          | 92210-0215  | 1        |