

2014 ZR800 (European) PARTS DIAGRAM

Fenders

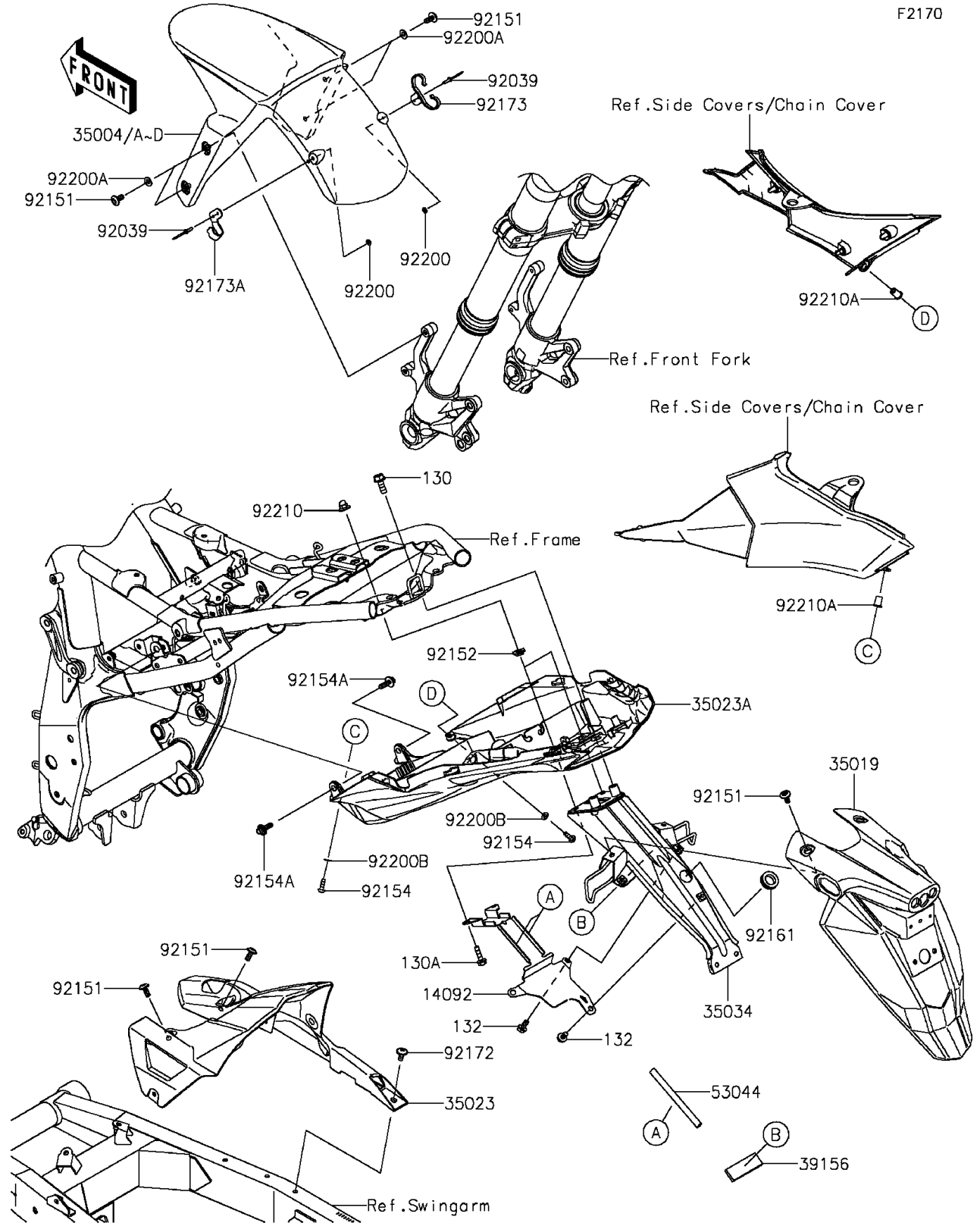

2014 ZR800 (European) PARTS LIST

Fenders

ITEM NAME	PART NUMBER	QUANTITY
BOLT-FLANGED,6X18 (Ref # 130)	130BA0618	2
BOLT-FLANGED,6X22 (Ref # 130A)	130BA0622	2
BOLT-FLANGED-SMALL,6X12 (Ref # 132)	132BA0612	3
COVER,HARNESS (Ref # 14092)	14092-0996	1
FENDER-FRONT,M.S.BLACK (Ref # 35004C)	35004-0322-660	1
FENDER-FRONT,M.F.S.BLACK (Ref # 35004D)	35004-0322-739	1
FLAP,RR (Ref # 35019)	35019-0556	1
FENDER-REAR,INNER (Ref # 35023)	35023-0343	1
FENDER-REAR (Ref # 35023A)	35023-0375	1
REINFORCE (Ref # 35034)	35034-0580	1
PAD,20X60X5 (Ref # 39156)	39156-0950	1
TRIM (Ref # 53044)	53044-0564	2
RIVET (Ref # 92039)	92039-1231	4
BOLT,SOCKET,6X14 (Ref # 92151)	92151-1654	8
COLLAR,6MM (Ref # 92152)	92152-1705	2
BOLT,SOCKET,5X16 (Ref # 92154)	92154-0026	2
BOLT,FLANGED,6X20 (Ref # 92154A)	92154-1268	2
DAMPER (Ref # 92161)	92161-0765	1
SCREW,6X14 (Ref # 92172)	92172-0004	1
CLAMP,FR FENDER,RH (Ref # 92173)	92173-0937	1
CLAMP,FR FENDER,LH (Ref # 92173A)	92173-0972	1
WASHER,3.5X8X1 (Ref # 92200)	92200-1251	4
WASHER,6.5X14X1 (Ref # 92200A)	92200-1388	4
WASHER,NYLON,5.3X11.5X0.5 (Ref # 92200B)	92200-1480	2
NUT,CAP,6MM (Ref # 92210)	92210-0170	2
NUT,WELL,5MM (Ref # 92210A)	92210-0498	2