

# 2012 VULCAN® 900 CLASSIC PARTS DIAGRAM

Valve(s)

E1210

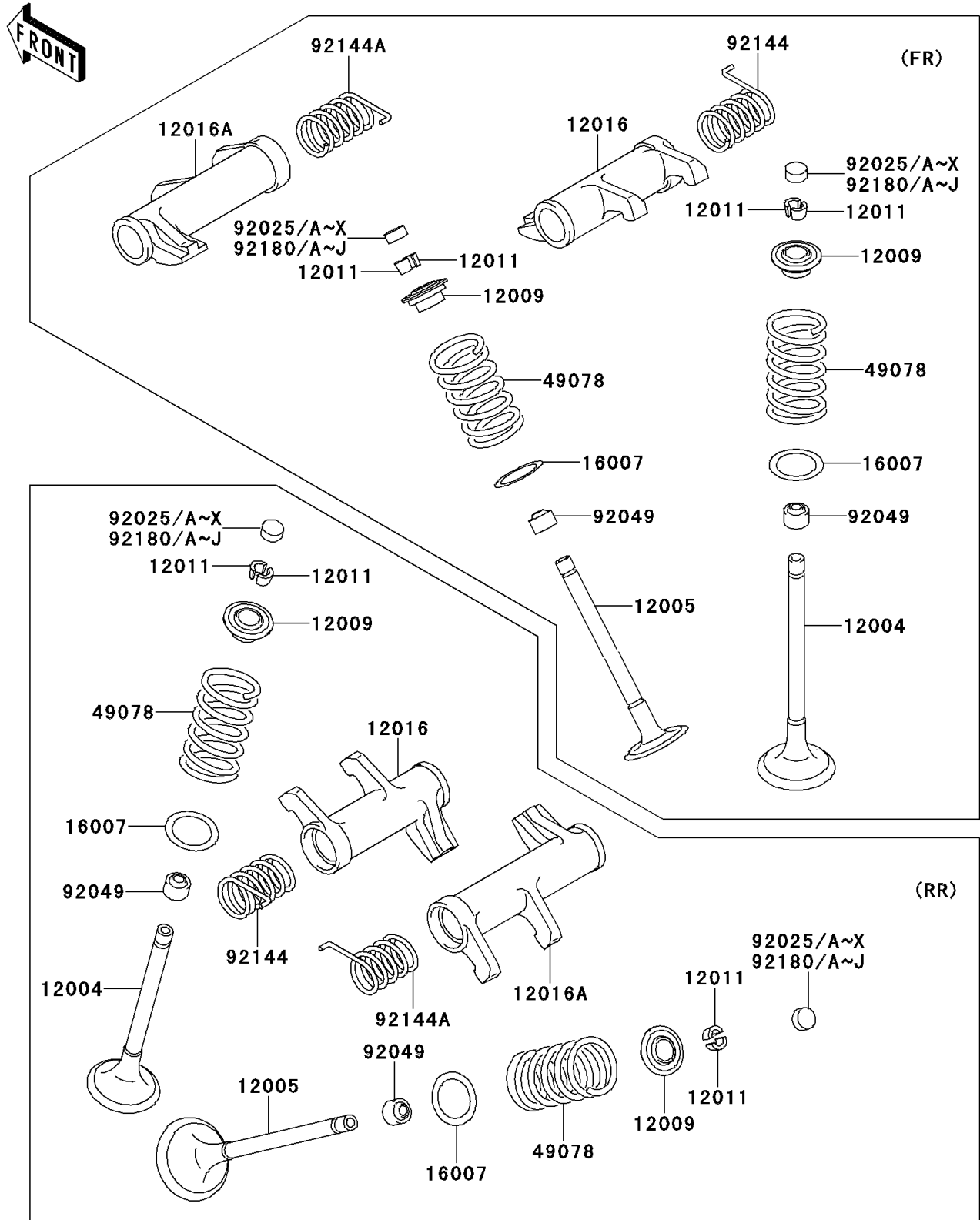

## 2012 VULCAN® 900 CLASSIC PARTS LIST

Valve(s)

| ITEM NAME                               | PART NUMBER | QUANTITY |
|---|-------------|----------|
| VALVE-INTAKE (Ref # 12004)              | 12004-1139  | 4        |
| VALVE-EXHAUST (Ref # 12005)             | 12005-1225  | 4        |
| RETAINER-VALVE SPRING (Ref # 12009)     | 12009-3701  | 8        |
| COLLET (Ref # 12011)                    | 12011-1051  | 16       |
| ARM-ROCKER,INTAKE (Ref # 12016)         | 12016-0019  | 2        |
| ARM-ROCKER,EXHAUST (Ref # 12016A)       | 12016-0020  | 2        |
| SEAT-SPRING,17.5X23.8X0.5 (Ref # 16007) | 16007-1178  | 8        |
| SPRING-ENGINE VALVE,OUTER (Ref # 49078) | 49078-1090  | 8        |
| SHIM,T=2.00 (Ref # 92025)               | 92025-1870  | AR       |
| SHIM,T=2.05 (Ref # 92025A)              | 92025-1871  | AR       |
| SHIM,T=2.10 (Ref # 92025B)              | 92025-1872  | AR       |
| SHIM,T=2.15 (Ref # 92025C)              | 92025-1873  | AR       |
| SHIM,T=2.20 (Ref # 92025D)              | 92025-1874  | AR       |
| SHIM,T=2.25 (Ref # 92025E)              | 92025-1875  | AR       |
| SHIM,T=2.30 (Ref # 92025F)              | 92025-1876  | AR       |
| SHIM,T=2.35 (Ref # 92025G)              | 92025-1877  | AR       |
| SHIM,T=2.40 (Ref # 92025H)              | 92025-1878  | 8        |
| SHIM,T=2.45 (Ref # 92025I)              | 92025-1879  | AR       |
| SHIM,T=2.50 (Ref # 92025J)              | 92025-1880  | AR       |
| SHIM,T=2.55 (Ref # 92025K)              | 92025-1881  | AR       |
| SHIM,T=2.60 (Ref # 92025L)              | 92025-1882  | AR       |
| SHIM,T=2.65 (Ref # 92025M)              | 92025-1883  | AR       |
| SHIM,T=2.70 (Ref # 92025N)              | 92025-1884  | AR       |
| SHIM,T=2.75 (Ref # 92025O)              | 92025-1885  | AR       |
| SHIM,T=2.80 (Ref # 92025P)              | 92025-1886  | AR       |
| SHIM,T=2.85 (Ref # 92025Q)              | 92025-1887  | AR       |
| SHIM,T=2.90 (Ref # 92025R)              | 92025-1888  | AR       |
| SHIM,T=2.95 (Ref # 92025S)              | 92025-1889  | AR       |
| SHIM,T=3.00 (Ref # 92025T)              | 92025-1890  | AR       |

## 2012 VULCAN® 900 CLASSIC PARTS LIST

Valve(s)

| ITEM NAME                                | PART NUMBER | QUANTITY |
|--|-------------|----------|
| SHIM,T=2.425 (Ref # 92025U)              | 92025-1982  | AR       |
| SHIM,T=2.475 (Ref # 92025V)              | 92025-1983  | AR       |
| SHIM,T=2.525 (Ref # 92025W)              | 92025-1984  | AR       |
| SHIM,T=2.575 (Ref # 92025X)              | 92025-1985  | AR       |
| SEAL-OIL,VSB58.558 (Ref # 92049)         | 92049-1218  | 8        |
| SPRING,ROCKER ARM,INTAKE (Ref # 92144)   | 92144-1899  | 2        |
| SPRING,ROCKER ARM,EXHAUST (Ref # 92144A) | 92144-1900  | 2        |
| SHIM,T=2.375 (Ref # 92180)               | 92180-1058  | AR       |
| SHIM,T=2.625 (Ref # 92180A)              | 92180-1059  | AR       |
| SHIM,T=2.675 (Ref # 92180B)              | 92180-1194  | AR       |
| SHIM,T=2.725 (Ref # 92180C)              | 92180-1195  | AR       |
| SHIM,T=2.775 (Ref # 92180D)              | 92180-1196  | AR       |
| SHIM,T=1.95 (Ref # 92180E)               | 92180-1208  | AR       |
| SHIM,T=1.90 (Ref # 92180F)               | 92180-1209  | AR       |
| SHIM,T=1.85 (Ref # 92180G)               | 92180-1210  | AR       |
| SHIM,T=1.80 (Ref # 92180H)               | 92180-1211  | AR       |
| SHIM,T=1.75 (Ref # 92180I)               | 92180-1212  | AR       |
| SHIM,T=1.70 (Ref # 92180J)               | 92180-1213  | AR       |