

# 2009 Vulcan® 1700 Nomad™ PARTS DIAGRAM

Fuel Tank

F2410

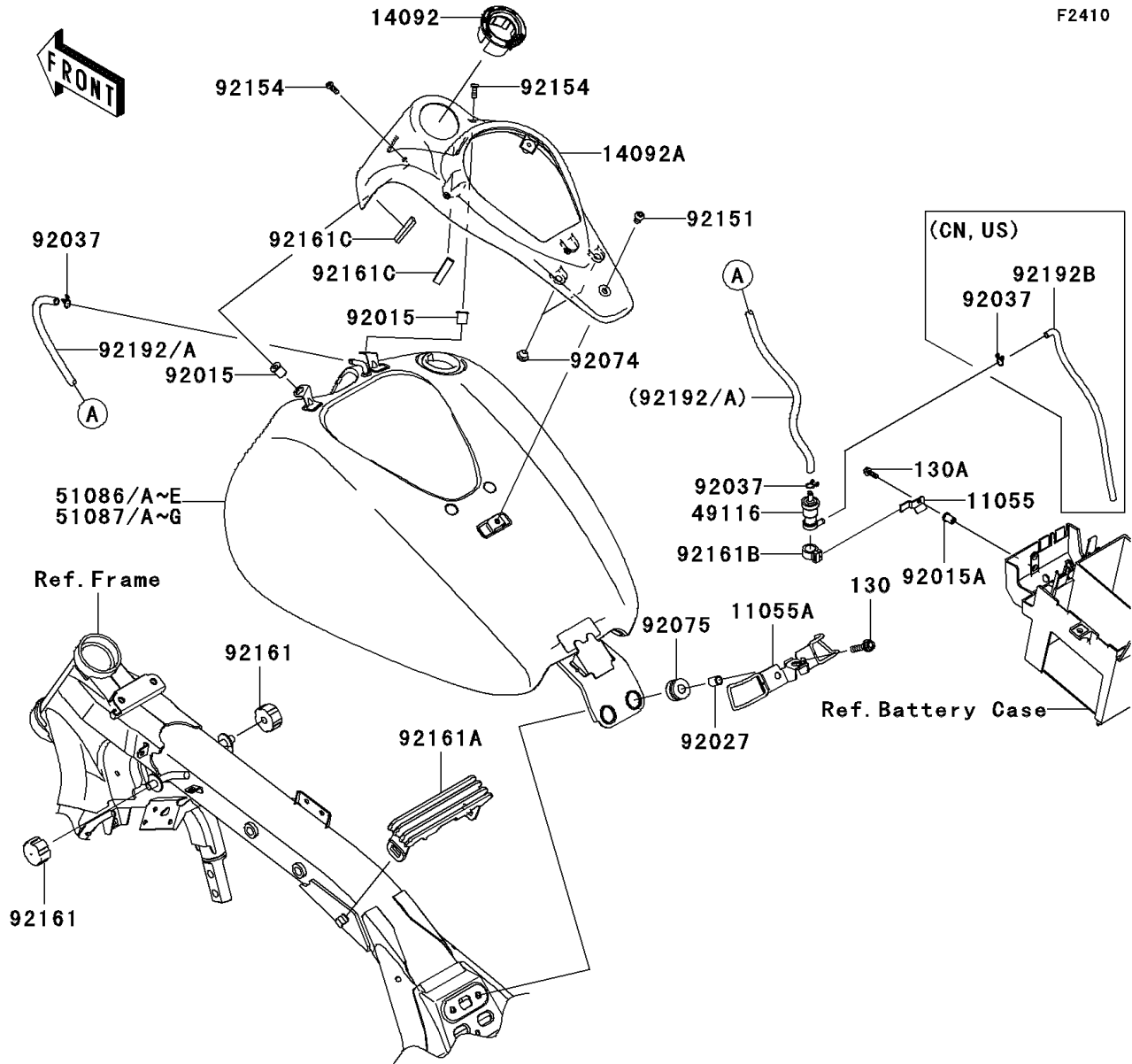

(51086/C)	Red/Beige	(51086D/E)	Titanium/Black	(51087D/F)	Red/Silver
(51086A/B)	Black	(51087/B)	Ebony/Gray	(51087E/G)	Black/Boulogne
(51086/A~C)	(C9F/C9FA)	(51087A/C)	Blue/Silver	(51087D~G)	(CCF)
<p>WD</p>		<p>WD</p>		<p>WD</p>	

## 2009 Vulcan® 1700 Nomad™ PARTS LIST

### Fuel Tank

ITEM NAME	PART NUMBER	QUANTITY
BRACKET,CHECK VALVE (Ref # 11055)	11055-1512	1
BRACKET,SEAT (Ref # 11055A)	11055-1552	1
COVER,IGNITION SWITCH (Ref # 14092)	14092-0046	1
COVER,METER (Ref # 14092A)	14092-0117	1
VALVE-ASSY,CHECK (Ref # 49116)	49116-0014	1
NUT (Ref # 92015)	92015-1700	2
NUT,WELL,5MM (Ref # 92015A)	92015-1757	1
COLLAR,8.8X12X17 (Ref # 92027)	92027-034	2
PLUG,7X2 (Ref # 92074)	92074-028	2
DAMPER (Ref # 92075)	92075-1736	2
BOLT,SOCKET,6X10 (Ref # 92151)	92151-1449	1
BOLT,SOCKET,6X16 (Ref # 92154)	92154-0242	2
BOLT-FLANGED,8X30 (Ref # 130)	130BA0830	2
BOLT-FLANGED,5X16 (Ref # 130A)	130BB0516	1
DAMPER,FUEL TANK (Ref # 92161)	92161-0293	2
DAMPER,FUEL TANK (Ref # 92161A)	92161-0577	1
DAMPER,CHECK VALVE (Ref # 92161B)	92161-0744	1
DAMPER,TANK COVER (Ref # 92161C)	92161-0804	2
TANK-COMP-FUEL,M.D,BLACK (Ref # 51086A)	51086-5086-17K	1
TANK-COMP-FUEL,M.D.BLACK (Ref # 51086B)	51086-5219-17K	1
CLAMP,TUBE (Ref # 92037)	92037-147	2
CLAMP,TUBE (Ref # 92037)	92037-147	3
TUBE,5X10X980 (Ref # 92192)	92192-0829	1
TUBE,5X10X980 (Ref # 92192A)	92192-0830	1
TUBE (Ref # 92192B)	92192-0837	1