

1990 Ninja® ZX™-6 PARTS DIAGRAM

Cylinder Head

E1111

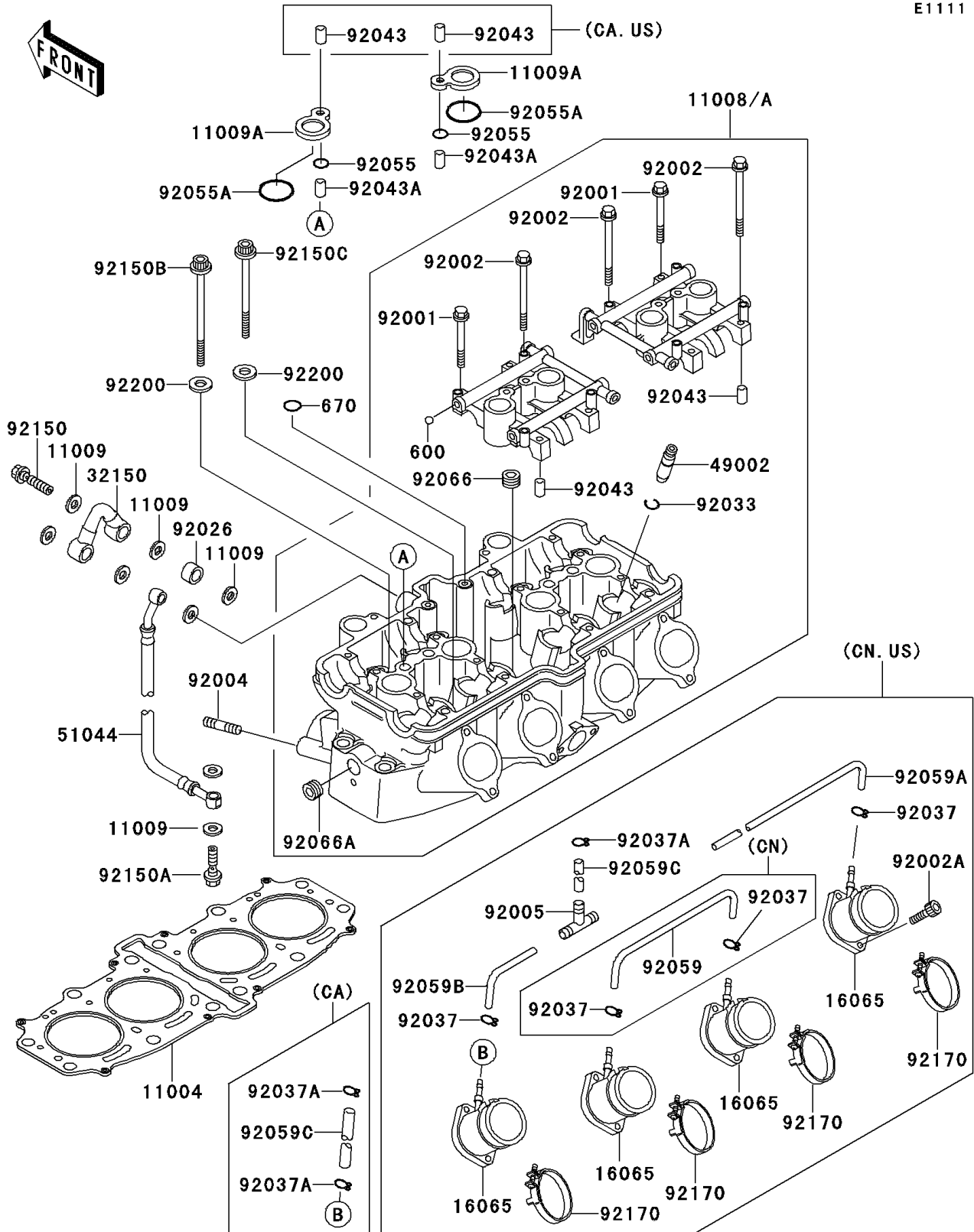

1990 Ninja® ZX™-6 PARTS LIST

Cylinder Head

ITEM NAME	PART NUMBER	QUANTITY
GASKET-HEAD (Ref # 11004)	11004-1206	1
GASKET,10X14.5X1.5 (Ref # 11009)	11009-1105	8
GASKET,SPARK PLUG (Ref # 11009A)	11009-1854	4
HOLDER-CARBURETOR (Ref # 16065)	16065-1213	4
PIPE,HEAD (Ref # 32150)	32150-1621	1
GUIDE-VALVE (Ref # 49002)	49002-1107	AR
TUBE-ASSY,HEAD-OIL PAN (Ref # 51044)	51044-1121	1
BOLT,FLANGED,6X38 (Ref # 92001)	92001-1105	12
BOLT,6X46 (Ref # 92002)	92001-1872	4
BOLT,6X16 (Ref # 92002A)	92002-1143	8
STUD,8X18 (Ref # 92004)	92004-1186	8
SPACER,10.5X15.1X10 (Ref # 92026)	92026-1393	1
RING-SNAP (Ref # 92033)	92033-1247	16
RING-O (Ref # 92055A)	92055-1470	4
TUBE,4X9X500,WHITE (Ref # 92059C)	92059-1533	1
PLUG (Ref # 92066)	92066-1253	4
PLUG (Ref # 92066A)	92066-1346	2
BALL-STEEL,9/32" (Ref # 600)	600A0900	12
O RING,8MM (Ref # 670)	670D1508	2
BOLT,BANJO,10X37 (Ref # 92150)	92150-1122	2
BOLT,BANJO,10X23 (Ref # 92150A)	92150-1123	1
BOLT,10X165 (Ref # 92150B)	92150-1368	2
BOLT,10X151 (Ref # 92150C)	92150-1369	10
CLAMP (Ref # 92170)	92170-1146	4
WASHER,10.5X19X2.3 (Ref # 92200)	92200-1042	12
HEAD-COMP-CYLINDER (Ref # 11008)	11008-1241	1
HEAD-COMP-CYLINDER (Ref # 11008A)	11008-1242	1
FITTING,TUBE,T-TYPE (Ref # 92005)	92005-1017	1
CLAMP (Ref # 92037)	92037-1610	2

1990 Ninja® ZX™-6 PARTS LIST

Cylinder Head

ITEM NAME	PART NUMBER	QUANTITY
CLAMP (Ref # 92037)	92037-1610	4
CLAMP (Ref # 92037A)	92037-1712	1
CLAMP (Ref # 92037A)	92037-1712	2
PIN,6.2X8X14 (Ref # 92043)	92043-1263	4
PIN,6.2X8X14 (Ref # 92043)	92043-1263	8
PIN,8.2X10X14 (Ref # 92043A)	92043-1264	4
RING-O,11.5X1.5 (Ref # 92055)	92055-1469	4
TUBE,4X9X155 (Ref # 92059)	92059-1033	1
TUBE,4X9X230 (Ref # 92059A)	92059-1068	1
TUBE,4X9X80 (Ref # 92059B)	92059-1365	1