

1988 Tecate 4 PARTS DIAGRAM

Front Master Cylinder

F2291-0180

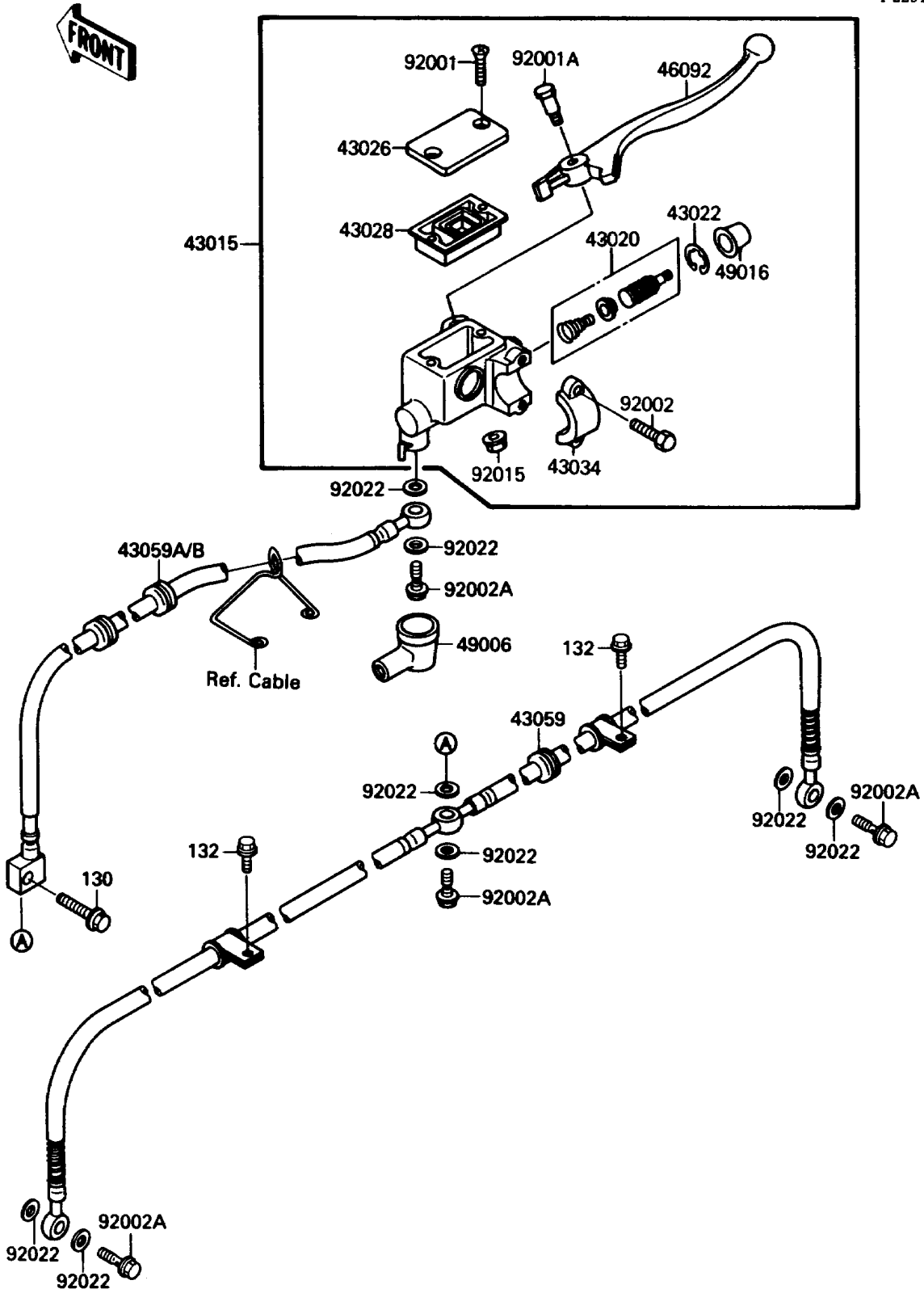

1988 Tecate 4 PARTS LIST

Front Master Cylinder

| ITEM NAME | PART NUMBER | QUANTITY |
|--|-------------|----------|
| CYLINDER-ASSY-MASTER,FR (Ref # 43015) | 43015-1360 | 1 |
| PISTON-COMP-BRAKE (Ref # 43020) | 43020-1031 | 1 |
| STOPPER-BRAKE,PISTON (Ref # 43022) | 43022-1010 | 1 |
| CAP-BRAKE (Ref # 43026) | 43026-1022 | 1 |
| DIAPHRAGM (Ref # 43028) | 43028-1061 | 1 |
| HOLDER-BRAKE,MASTER CYLINDER (Ref # 43034) | 43034-1016 | 1 |
| HOSE-BRAKE,FR (Ref # 43059) | 43059-1389 | 1 |
| HOSE-BRAKE,FR (Ref # 43059B) | 43059-1425 | 1 |
| LEVER-GRIP,FRONT BRAKE (Ref # 46092) | 46092-1144 | 1 |
| BOOT,DUST (Ref # 49006) | 49006-1040 | 1 |
| COVER-SEAL,MASTER CYLINDER (Ref # 49016) | 49016-1044 | 1 |
| SCREW,5MM (Ref # 92001) | 92001-1727 | 1 |
| BOLT,FRONT BRAKE LEVER (Ref # 92001A) | 92001-1728 | 1 |
| BOLT (Ref # 92002) | 92002-1860 | 1 |
| BOLT,OIL,L=23 (Ref # 92002A) | 92002-1888 | 1 |
| NUT,FLANGED,6MM (Ref # 92015) | 92015-1233 | 1 |
| WASHER,10.5X15X1.5 (Ref # 92022) | 43067-001 | 1 |
| BOLT-FLANGED,8X25 (Ref # 130) | 130G0825 | 1 |
| BOLT-FLANGED-SMALL (Ref # 132) | 132G0610 | 1 |