

1994 Ninja® ZX™ -9R PARTS DIAGRAM

Generator Shaft

E1324

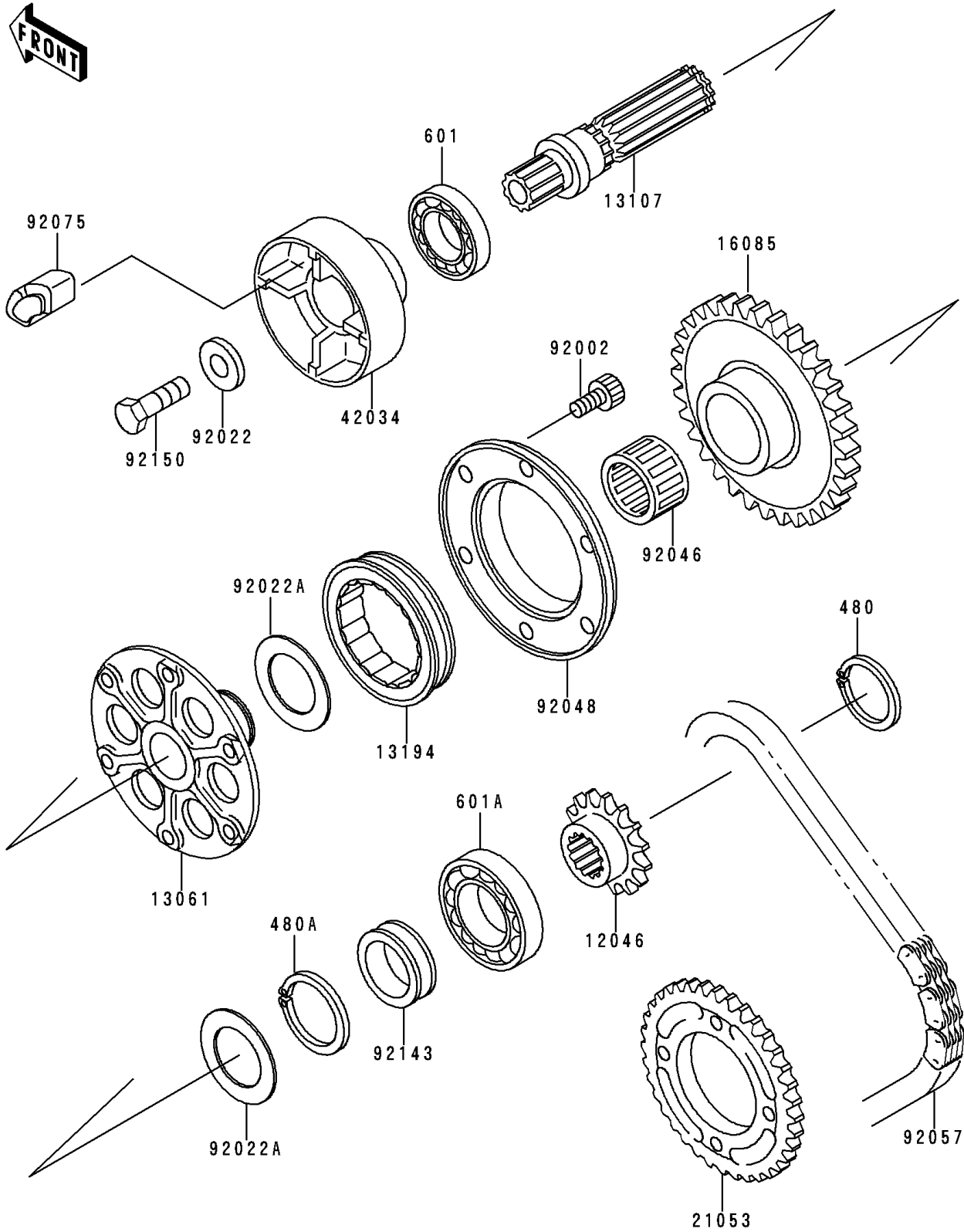

1994 Ninja® ZX™ -9R PARTS LIST

Generator Shaft

| ITEM NAME | PART NUMBER | QUANTITY |
|---|-------------|----------|
| CIRCLIP-TYPE-C,20MM (Ref # 480) | 480J2000 | 1 |
| CIRCLIP-TYPE-C,25MM (Ref # 480A) | 480J2500 | 1 |
| BEARING-BALL,#6203 (Ref # 601) | 601A6203 | 1 |
| BEARING-BALL,#6204 (Ref # 601A) | 601B6204 | 1 |
| SPROCKET,DRIVEN,GENERATOR (Ref # 12046) | 12046-1127 | 1 |
| BOSS,ONEWAY CLUTCH (Ref # 13061) | 13061-1197 | 1 |
| SHAFT,ONEWAY CLUTCH (Ref # 13107) | 13107-1277 | 1 |
| CLUTCH-ONEWAY (Ref # 13194) | 13194-1095 | 1 |
| GEAR,ONEWAY CLUTCH (Ref # 16085) | 16085-1173 | 1 |
| SPROCKET-ASSY (Ref # 21053) | 21053-1063 | 1 |
| COUPLING (Ref # 42034) | 42034-1055 | 1 |
| BOLT,SOCKET,6X12 (Ref # 92002) | 92002-1796 | 6 |
| WASHER,8X22X3 (Ref # 92022) | 92022-1518 | 1 |
| WASHER,25.3X32X0.5 (Ref # 92022A) | 92022-225 | 2 |
| BEARING-NEEDLE,K253020S (Ref # 92046) | 92046-1022 | 1 |
| RACE,ONEWAY CLUTCH (Ref # 92048) | 92048-1068 | 1 |
| CHAIN,GENERATOR,81RH2515M (Ref # 92057) | 92057-1322 | 1 |
| DAMPER,COUPLING (Ref # 92075) | 92075-1790 | 4 |
| COLLAR (Ref # 92143) | 92143-1466 | 1 |
| BOLT (Ref # 92150) | 92150-1488 | 1 |