

2024 MULE PRO-FXT™ 1000 PLATINUM RANCH EDITION PARTS

DIAGRAM

F2261

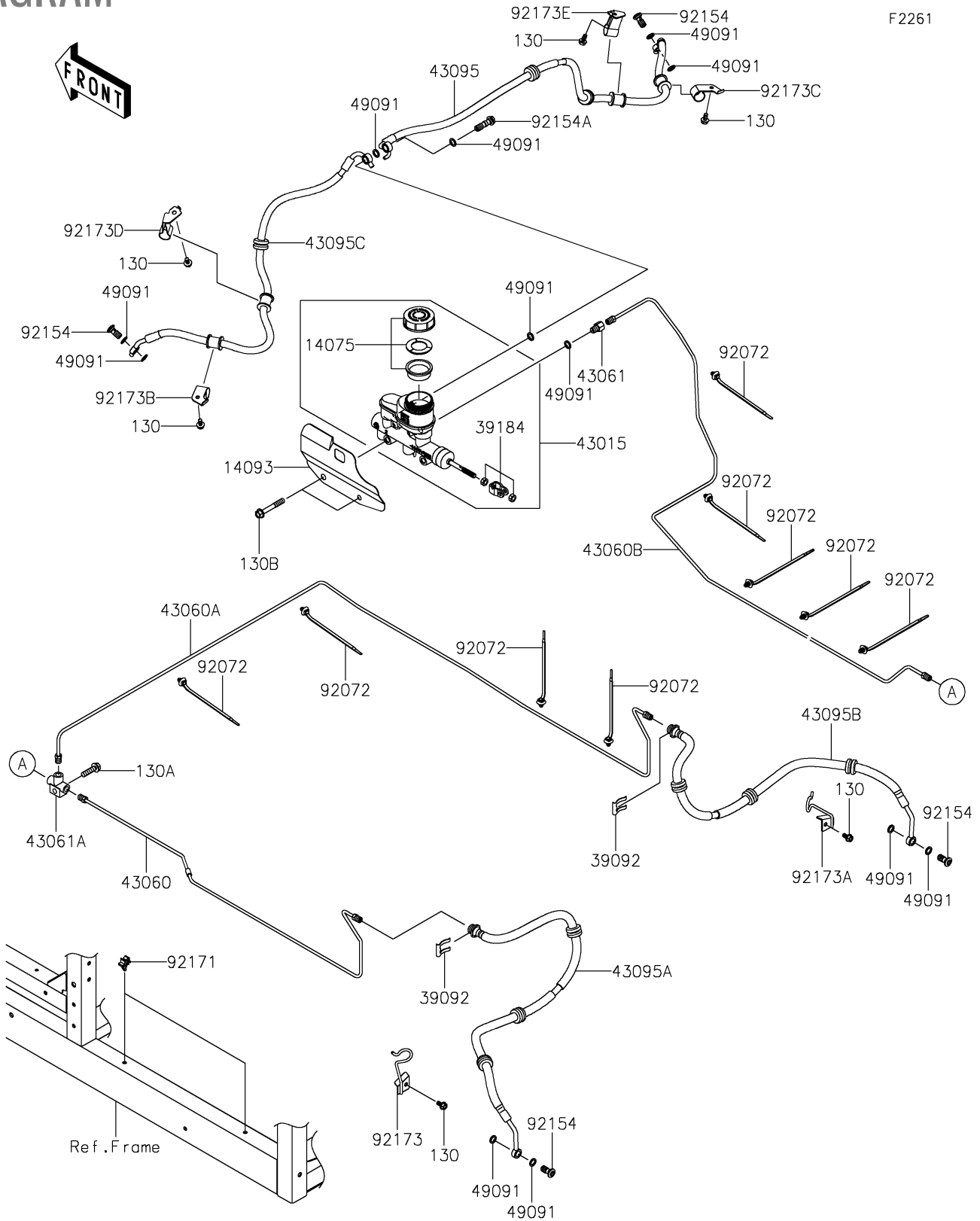

2024 MULE PRO-FXT™ 1000 PLATINUM RANCH EDITION PARTS LIST

Master Cylinder

ITEM NAME	PART NUMBER	QUANTITY
CAP-ASSY (Ref # 14075)	14075-0038	1
COVER,M/C BODY (Ref # 14093)	14093-1357	1
PIN-HAIR (Ref # 39092)	39092-1052	2
BRACKET-ASSY (Ref # 39184)	39184-0031	1
CYLINDER-ASSY-MASTER (Ref # 43015)	43015-0595	1
PIPE-BRAKE,LH (Ref # 43060)	43060-0318	1
PIPE-BRAKE,RH (Ref # 43060A)	43060-0319	1
PIPE-BRAKE (Ref # 43060B)	43060-0360	1
JOINT-BRAKE,M/C (Ref # 43061)	43061-0302	1
JOINT-BRAKE (Ref # 43061A)	43061-1063	1
HOSE-BRAKE,1068.5MM (Ref # 43095)	43095-1883	1
HOSE-BRAKE,857MM (Ref # 43095A)	43095-1884	1
HOSE-BRAKE,777MM (Ref # 43095B)	43095-1885	1
HOSE-BRAKE,738.5MM (Ref # 43095C)	43095-1886	1
WASHER-SEAL,10.1X14.5X1.5 (Ref # 49091)	49091-0001	12
BAND,OS170-FT7(BLACK) (Ref # 92072)	92072-1414	9
BOLT,HEXALOBULAR,10X21 (Ref # 92154)	92154-1328	4
BOLT,OIL,10X34.5 (Ref # 92154A)	92154-1398	1
CLAMP (Ref # 92171)	92171-0805	2
CLAMP (Ref # 92173)	92173-1217	1
CLAMP (Ref # 92173A)	92173-1218	1
CLAMP (Ref # 92173B)	92173-2571	1
CLAMP (Ref # 92173C)	92173-2572	1
CLAMP (Ref # 92173D)	92173-2651	1
CLAMP (Ref # 92173E)	92173-2652	1
BOLT-FLANGED,6X12 (Ref # 130)	130BA0612	6
BOLT-FLANGED,8X30 (Ref # 130A)	130BA0830	1
BOLT-FLANGED,8X55 (Ref # 130B)	130BA0855	2