

2021 TERYX4™ S CAMO PARTS DIAGRAM

Transmission

E1361

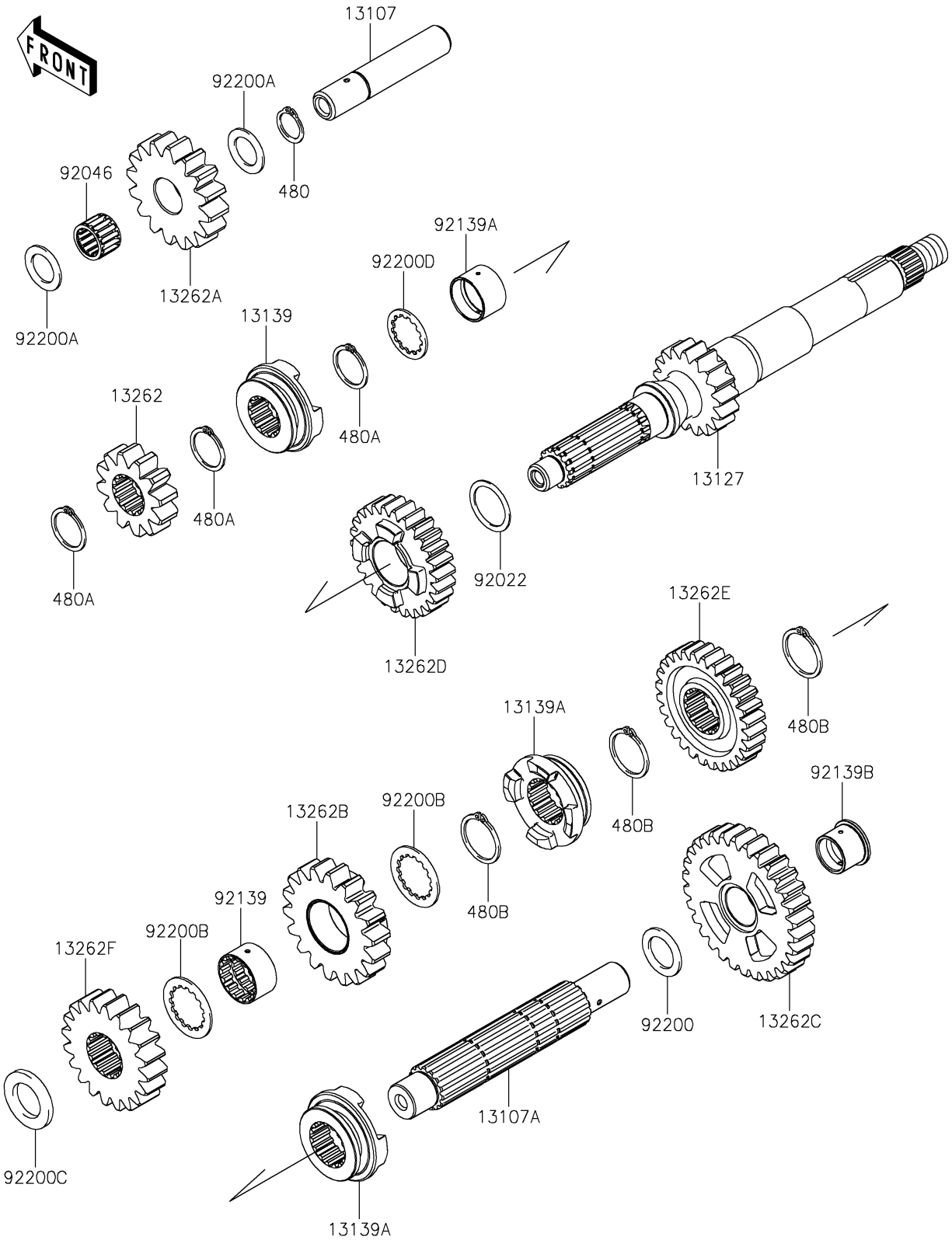

2021 TERYX4™ S CAMO PARTS LIST

Transmission

| ITEM NAME | PART NUMBER | QUANTITY |
|--|-------------|----------|
| SHAFT,REVERSE (Ref # 13107) | 13107-0715 | 1 |
| SHAFT,COUNTER (Ref # 13107A) | 13107-0716 | 1 |
| SHAFT-TRANSMISSION INPUT,17T (Ref # 13127) | 13127-0654 | 1 |
| SHIFTER,INPUT HI (Ref # 13139) | 13139-0624 | 1 |
| SHIFTER,OUTPUT (Ref # 13139A) | 13139-0625 | 2 |
| GEAR,INPUT REVERSE,12T (Ref # 13262) | 13262-0861 | 1 |
| GEAR,REVERSE IDLE,16T (Ref # 13262A) | 13262-0862 | 1 |
| GEAR,OUTPUT REVERSE,18T (Ref # 13262B) | 13262-0865 | 1 |
| GEAR,OUTPUT LOW,31T (Ref # 13262C) | 13262-0867 | 1 |
| GEAR,INPUT HI,26T (Ref # 13262D) | 13262-1551 | 1 |
| GEAR,OUTPUT HI,28T (Ref # 13262E) | 13262-1552 | 1 |
| GEAR,OUTPUT,19T (Ref # 13262F) | 13262-1553 | 1 |
| WASHER,25.3X32X1 (Ref # 92022) | 92022-1800 | 1 |
| BEARING-NEEDLE,182216E03 C3 (Ref # 92046) | 92046-0605 | 1 |
| BUSHING,25X28.3X16.7 (Ref # 92139) | 92139-0107 | 1 |
| BUSHING,25X28X17.8 (Ref # 92139A) | 92139-0280 | 1 |
| BUSHING,20X24X18.7 (Ref # 92139B) | 92139-0707 | 1 |
| WASHER,20.2X30X1.8 (Ref # 92200) | 92200-0221 | 1 |
| WASHER,18.2X28X1.5 (Ref # 92200A) | 92200-0716 | 2 |
| WASHER,28.5X38X1.5 (Ref # 92200B) | 92200-0717 | 2 |
| WASHER,22.2X36X3.6 (Ref # 92200C) | 92200-0718 | 1 |
| WASHER,25.2X31.0X1.5 (Ref # 92200D) | 92200-1239 | 1 |
| CIRCLIP-TYPE-C,18MM (Ref # 480) | 480J1800 | 1 |
| CIRCLIP-TYPE-C,24MM (Ref # 480A) | 480J2400 | 3 |
| CIRCLIP-TYPE-C,28MM (Ref # 480B) | 480J2800 | 3 |