

2025 MULE PRO-FXT 1000 LE Ranch Edition PARTS DIAGRAM

Transmission

E1361

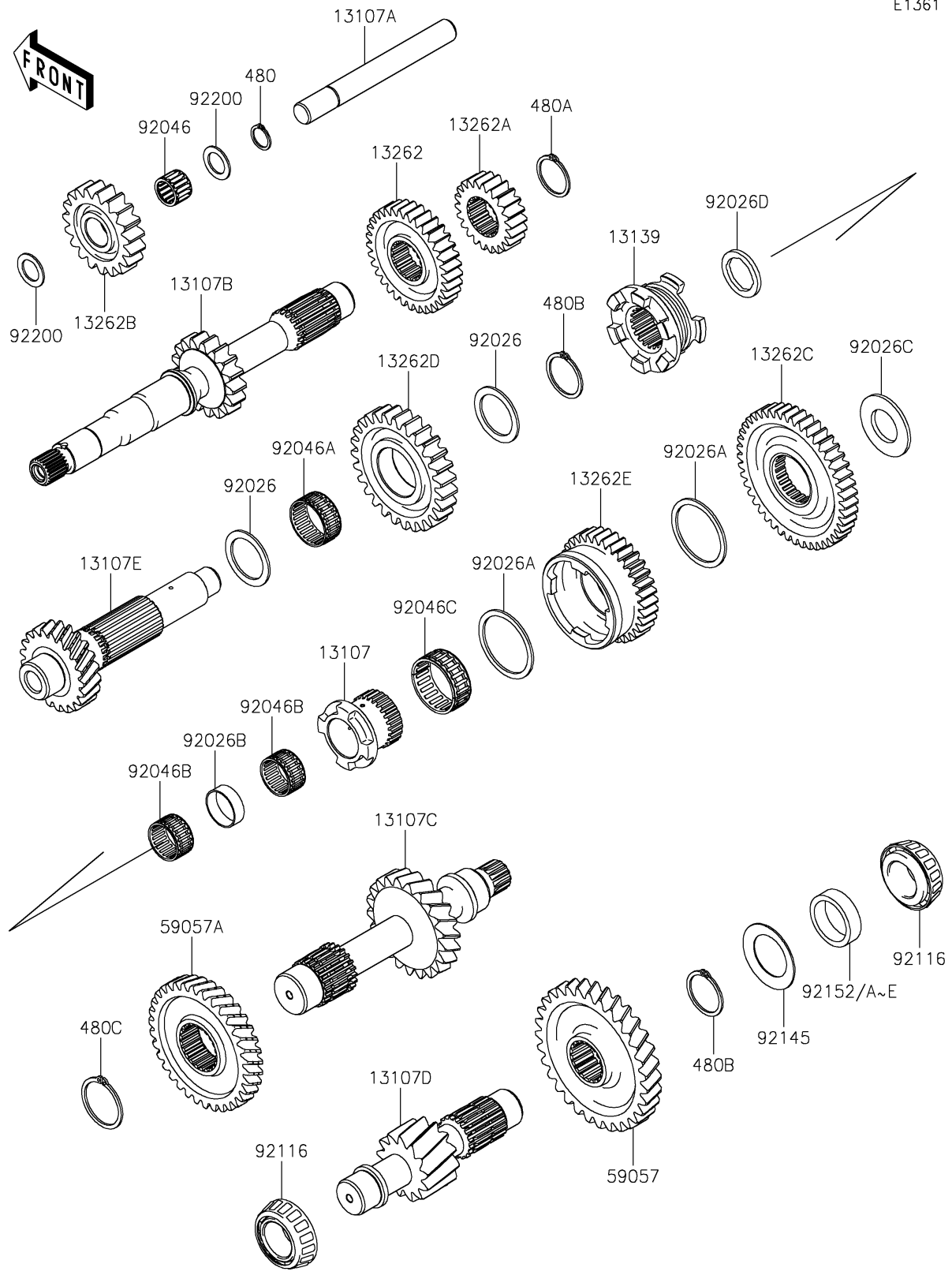

2025 MULE PRO-FXT 1000 LE Ranch Edition PARTS LIST

Transmission

| ITEM NAME | PART NUMBER | QUANTITY |
|--|-------------|----------|
| SHAFT (Ref # 13107) | 13107-0779 | 1 |
| SHAFT,IDLE REV (Ref # 13107A) | 13107-0780 | 1 |
| SHAFT,INPUT,17T (Ref # 13107B) | 13107-0782 | 1 |
| SHAFT,3RD,21T (Ref # 13107C) | 13107-0784 | 1 |
| SHAFT,4TH,13T (Ref # 13107D) | 13107-0785 | 1 |
| SHAFT,COUNTER,21T (Ref # 13107E) | 13107-0968 | 1 |
| SHIFTER (Ref # 13139) | 13139-0022 | 1 |
| GEAR,INPUT HI,33T (Ref # 13262) | 13262-1085 | 1 |
| GEAR,INPUT LOW,22T (Ref # 13262A) | 13262-1086 | 1 |
| GEAR,IDLE REV,19T (Ref # 13262B) | 13262-1087 | 1 |
| GEAR,COUNTER LOW,45T (Ref # 13262C) | 13262-1088 | 1 |
| GEAR,COUNTER REV,27T (Ref # 13262D) | 13262-1089 | 1 |
| GEAR,COUNTER HI,34T (Ref # 13262E) | 13262-1090 | 1 |
| GEAR-HELICAL,31T (Ref # 59057) | 59057-0013 | 1 |
| GEAR-HELICAL,3RD,34T (Ref # 59057A) | 59057-0041 | 1 |
| SPACER,35.2X47X2 (Ref # 92026) | 92026-0765 | 2 |
| SPACER,49.2X58X2 (Ref # 92026A) | 92026-0766 | 2 |
| SPACER,29.4X31.8X10 (Ref # 92026B) | 92026-0767 | 1 |
| SPACER (Ref # 92026C) | 92026-0768 | 1 |
| SPACER,28.2X39X3.6 (Ref # 92026D) | 92026-0795 | 1 |
| BEARING-NEEDLE,FMJ-182417 (Ref # 92046) | 92046-0040 | 1 |
| BEARING-NEEDLE,35X40X17 (Ref # 92046A) | 92046-0611 | 1 |
| BEARING-NEEDLE,KT283317C3 (Ref # 92046B) | 92046-0621 | 2 |
| BEARING-NEEDLE,HIGH GEAR (Ref # 92046C) | 92046-1276 | 1 |
| BEARING-ROLLER (Ref # 92116) | 92116-0014 | 2 |
| SPRING (Ref # 92145) | 92145-1575 | 1 |
| COLLAR,L=12.1 (Ref # 92152) | 92152-1815 | AR |
| COLLAR,L=12.3 (Ref # 92152A) | 92152-1816 | AR |
| COLLAR,L=12.5 (Ref # 92152B) | 92152-1817 | AR |

2025 MULE PRO-FXT 1000 LE Ranch Edition PARTS LIST

Transmission

| ITEM NAME | PART NUMBER | QUANTITY |
|----------------------------------|-------------|----------|
| COLLAR,L=12.7 (Ref # 92152C) | 92152-1818 | AR |
| COLLAR,L=12.9 (Ref # 92152D) | 92152-1819 | AR |
| COLLAR,L=13.1 (Ref # 92152E) | 92152-1820 | AR |
| WASHER,18.2X28X1.5 (Ref # 92200) | 92200-0716 | 2 |
| CIRCLIP-TYPE-C,18MM (Ref # 480) | 480J1800 | 1 |
| CIRCLIP-TYPE-C,32MM (Ref # 480A) | 480J3200 | 1 |
| CIRCLIP (Ref # 480B) | 480J3500 | 2 |
| CIRCLIP (Ref # 480C) | 480J4000 | 1 |