

1997 Ninja® ZX™-6R PARTS DIAGRAM

Fuel Tank(ZX600-F3)

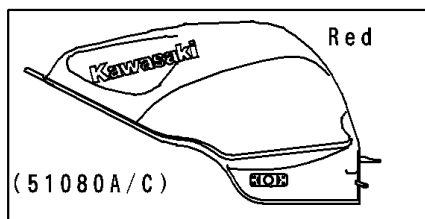
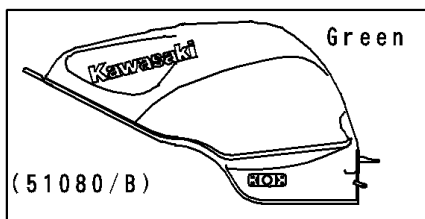
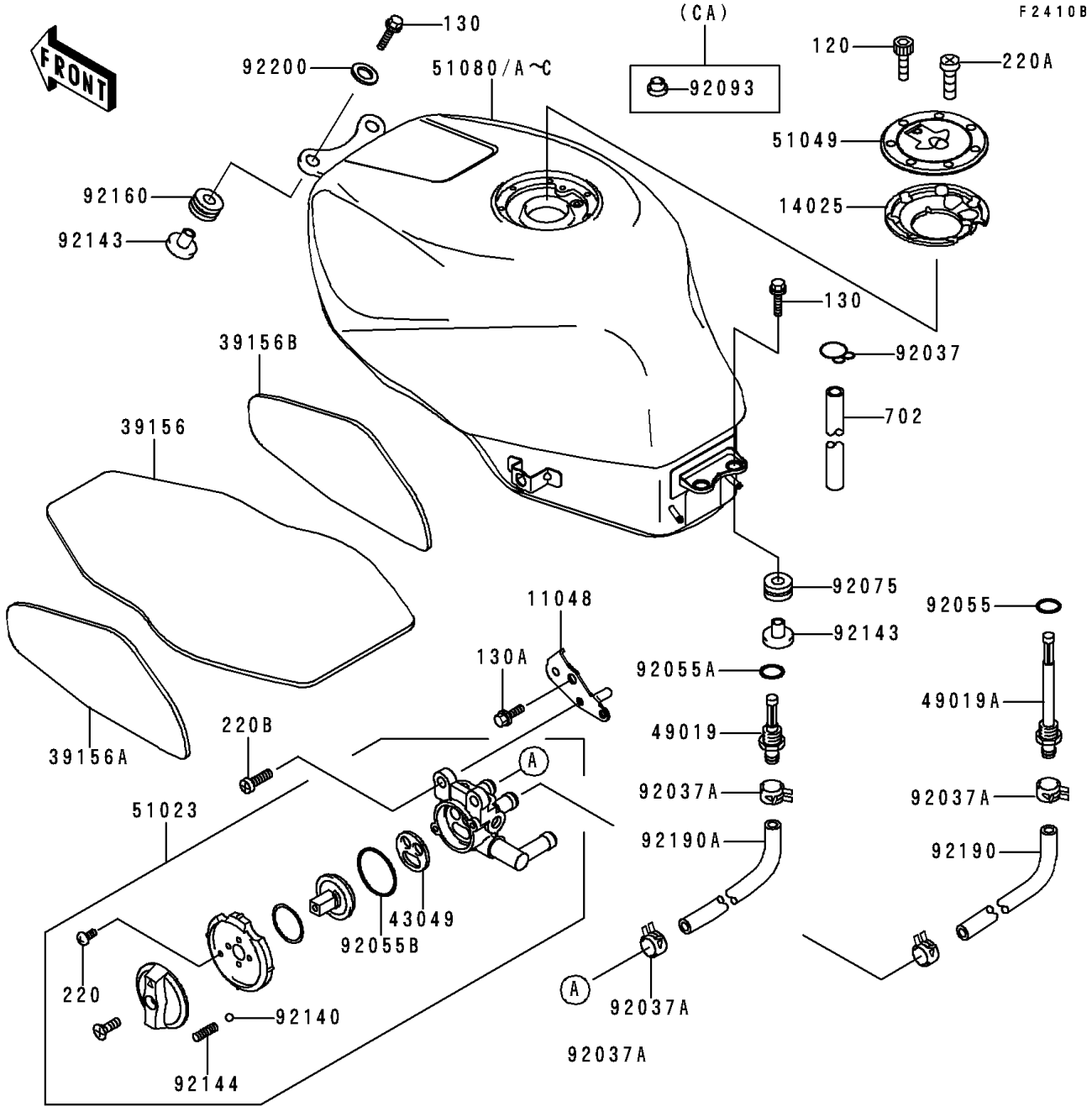

1997 Ninja® ZX™-6R PARTS LIST

Fuel Tank(ZX600-F3)

ITEM NAME	PART NUMBER	QUANTITY
BRACKET,FUEL TAP (Ref # 11048)	11048-1940	1
COVER,TANK CAP (Ref # 14025)	14025-1913	1
PAD,FUEL TANK,CNT (Ref # 39156)	39156-1448	1
PAD,FUEL TANK,LH (Ref # 39156A)	39156-1479	1
PAD,FUEL TANK,RH (Ref # 39156B)	39156-1480	1
PACKING,TAP VALVE (Ref # 43049)	43049-1066	1
FILTER-FUEL (Ref # 49019)	49019-1070	1
FILTER-FUEL,"ON" (Ref # 49019A)	49019-1079	1
TAP-ASSY,FUEL (Ref # 51023)	51023-1217	1
CAP-TANK,FUEL (Ref # 51049)	51049-1091	1
CLAMP,TUBE (Ref # 92037)	92037-010	1
CLAMP (Ref # 92037A)	92037-1181	4
BOLT-SOCKET (Ref # 120)	120S0512	7
BOLT-FLANGED,6X30,BLACK (Ref # 130)	130J0630	4
BOLT-FLANGED (Ref # 130A)	130J0812	1
SCREW-PAN-CROS (Ref # 220)	220B0308	2
SCREW-PAN-CROS (Ref # 220A)	220C0508	1
SCREW-PAN-CROS,6X8 (Ref # 220B)	220C0608	2
TUBE-RUBBER,6X520 (Ref # 702)	702A06520	1
RING-O,ID=9.5 (Ref # 92055)	92055-1386	1
RING-O,11.5X1.5 (Ref # 92055A)	92055-1387	1
RING-O,TAP LEVER (Ref # 92055B)	92055-1419	1
DAMPER (Ref # 92075)	92075-209	2
BALL,STAINLESS,5/32" (Ref # 92140)	92140-1051	1
COLLAR (Ref # 92143)	92143-1515	4
SPRING,FUEL TAP KNOB (Ref # 92144)	92144-1212	1
DAMPER (Ref # 92160)	92160-1162	2
TUBE,FUEL,"ON" (Ref # 92190)	92190-1586	1
TUBE,FUEL,"RES" (Ref # 92190A)	92190-1587	1

1997 Ninja® ZX™ -6R PARTS LIST

Fuel Tank(ZX600-F3)

ITEM NAME	PART NUMBER	QUANTITY
WASHER,6.5X22X1.6 (Ref # 92200)	92200-1087	2
TANK-COMP-FUEL,L.GREEN (Ref # 51080)	51080-5373-7F	1
TANK-COMP-FUEL,C.P.RED (Ref # 51080A)	51080-5374-A5	1
TANK-COMP-FUEL,L.GREEN (Ref # 51080B)	51080-5379-7F	1
TANK-COMP-FUEL,C.P.RED (Ref # 51080C)	51080-5380-A5	1
SEAL,FUEL TANK CAP (Ref # 92093)	92093-1030	1