

2000 Ninja® ZX™-6 PARTS DIAGRAM

Air Duct

E1131

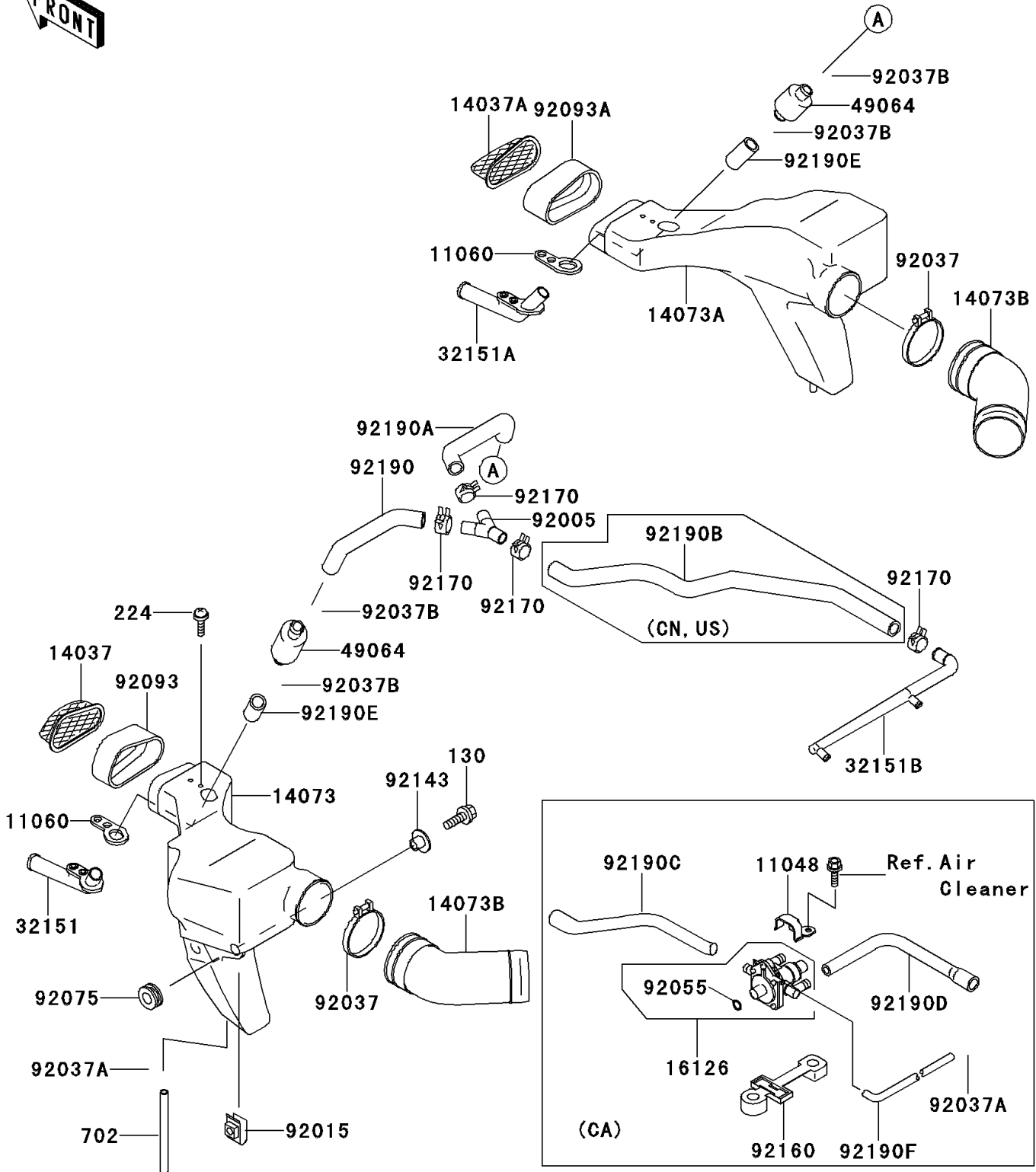

2000 Ninja® ZX™-6 PARTS LIST

Air Duct

ITEM NAME	PART NUMBER	QUANTITY
GASKET (Ref # 11060)	11060-1343	2
SCREEN,AIR DUCT,LH (Ref # 14037)	14037-1166	1
SCREEN,AIR DUCT,RH (Ref # 14037A)	14037-1167	1
DUCT,AIR INTAKE,LH (Ref # 14073)	14073-1549	1
DUCT,AIR INTAKE,RH (Ref # 14073A)	14073-1550	1
DUCT,DUCT-AIR FILTER (Ref # 14073B)	14073-1574	2
PIPE,LH (Ref # 32151)	32151-1462	1
PIPE,RH (Ref # 32151A)	32151-1463	1
PIPE (Ref # 32151B)	32151-1540	1
FILTER-AIR (Ref # 49064)	49064-1055	2
FITTING,Y-TIPE (Ref # 92005)	92005-1250	1
NUT,6MM (Ref # 92015)	92015-1602	2
CLAMP,AIR FILTER (Ref # 92037)	92037-1409	2
CLAMP,TUBE (Ref # 92037B)	92037-213	4
DAMPER (Ref # 92075)	92075-1634	2
SEAL,LH (Ref # 92093)	92093-1347	1
SEAL,RH (Ref # 92093A)	92093-1348	1
COLLAR,L=9.6 (Ref # 92143)	92143-1016	2
CLAMP (Ref # 92170)	92170-1060	4
TUBE,14X20X158,LH (Ref # 92190)	92190-1413	1
TUBE,14X20X158,RH (Ref # 92190A)	92190-1414	1
BOLT-FLANGED,6X25 (Ref # 130)	130H0625	2
SCREW-PAN-WP-CROS,5X12 (Ref # 224)	224C0512	4
TUBE-RUBBER,7X10X120 (Ref # 702)	702A07120	2
TUBE,14X20X28 (Ref # 92190E)	92190-1429	2
BRACKET,VALVE (Ref # 11048)	11048-1179	1
VALVE,CANISTER (Ref # 16126)	16126-1274	1
CLAMP (Ref # 92037A)	92037-1712	2
CLAMP (Ref # 92037A)	92037-1712	3

2000 Ninja® ZX™-6 PARTS LIST

Air Duct

ITEM NAME	PART NUMBER	QUANTITY
RING-O (Ref # 92055)	92055-1524	1
DAMPER (Ref # 92160)	92160-1431	1
TUBE,14X20X525 (Ref # 92190B)	92190-1415	1
TUBE,VALVE-FITTING (Ref # 92190C)	92190-1422	1
TUBE,VALVE-FITTING (Ref # 92190D)	92190-1423	1
TUBE,4X9X276 (Ref # 92190F)	92190-1444	1