

2023 KLR® 650 PARTS DIAGRAM

Transmission

E1361

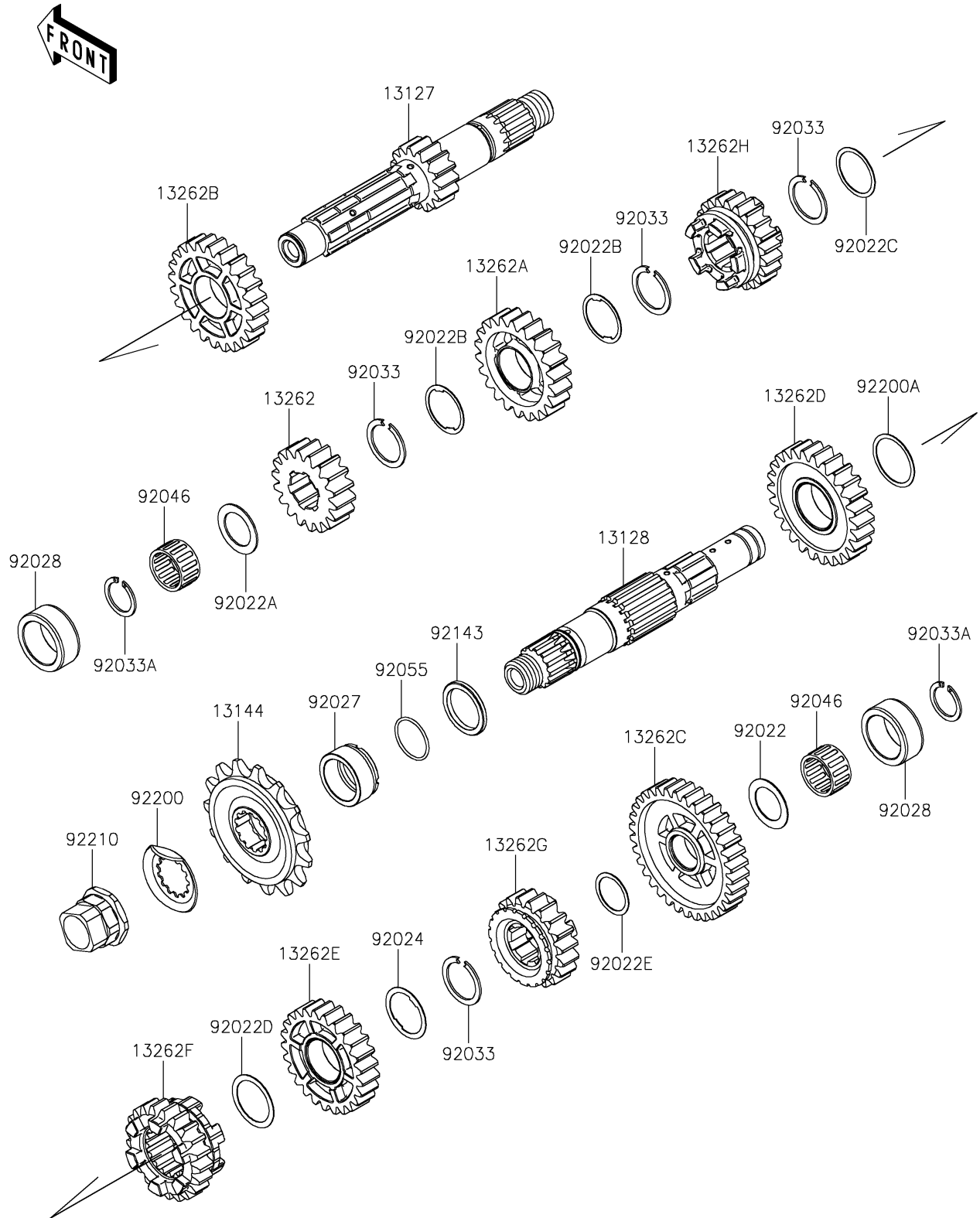

2023 KLR® 650 PARTS LIST

Transmission

ITEM NAME	PART NUMBER	QUANTITY
SHAFT-TRANSMISSION INPUT,15T (Ref # 13127)	13127-0711	1
SHAFT-TRANSMISSION OUTPUT (Ref # 13128)	13128-0727	1
SPROCKET-OUTPUT,15T (Ref # 13144)	13144-0597	1
GEAR,INPUT 2ND,18T (Ref # 13262)	13262-1489	1
GEAR,INPUT 4TH,22T (Ref # 13262A)	13262-1491	1
GEAR,INPUT TOP,24T (Ref # 13262B)	13262-1492	1
GEAR,OUTPUT LOW,34T (Ref # 13262C)	13262-1493	1
GEAR,OUTPUT 2ND,26T (Ref # 13262D)	13262-1494	1
GEAR,OUTPUT 3RD,25T (Ref # 13262E)	13262-1495	1
GEAR,OUTPUT 4TH,21T (Ref # 13262F)	13262-1618	1
GEAR,OUTPUT TOP,19T (Ref # 13262G)	13262-1619	1
GEAR,INPUT 3RD,22T (Ref # 13262H)	13262-1620	1
WASHER,20.3X30X0.7,STEEL (Ref # 92022)	92022-1026	1
WASHER,20.5X30X1,STEEL (Ref # 92022A)	92022-112	1
WASHER,TOOTHED,25.3X29.5X0.5 (Ref # 92022B)	92022-1482	2
WASHER,25.3X30X0.5 (Ref # 92022C)	92022-159	1
WASHER,25.3X32X0.5 (Ref # 92022D)	92022-225	1
WASHER,20.5X25.5X0.5 (Ref # 92022E)	92022-252	1
WASHER,TOOTHED,22.5X31X0.5 (Ref # 92024)	92024-038	1
COLLAR,25X32X15.3 (Ref # 92027)	92027-1800	1
BUSHING,26X35X14 (Ref # 92028)	92028-131	2
RING-SNAP,24MM (Ref # 92033)	92033-026	4
RING-SNAP,18MM (Ref # 92033A)	92033-029	2
BEARING-NEEDLE,KT202614 (Ref # 92046)	92046-1170	2
RING-O,21.5X1.5 (Ref # 92055)	92055-0196	1
COLLAR,25X32X3.0 (Ref # 92143)	92143-1721	1
WASHER (Ref # 92200)	92200-0851	1
WASHER,2ND GEAR (Ref # 92200A)	92200-1170	1
NUT,M20 (Ref # 92210)	92210-0605	1