

# 2025 KLR650 Adventure ABS PARTS DIAGRAM

## Rear Master Cylinder

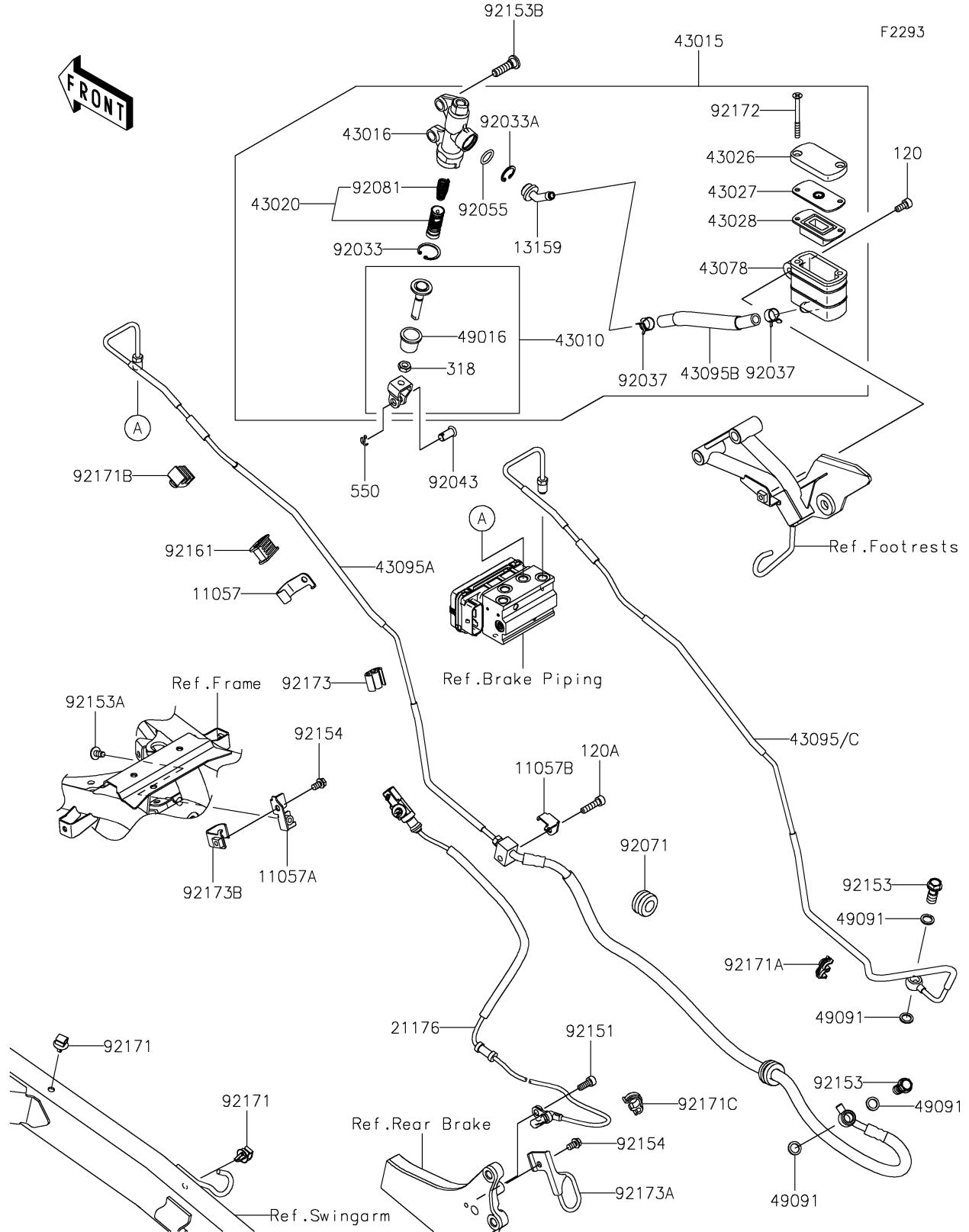

## 2025 KLR650 Adventure ABS PARTS LIST

### Rear Master Cylinder

ITEM NAME	PART NUMBER	QUANTITY
BRACKET,BRAKE HOSE (Ref # 11057)	11057-4377	1
BRACKET,CLAMP SUPPORT (Ref # 11057A)	11057-7882	1
BRACKET,HOSE-BRAKE (Ref # 11057B)	11057-7883	1
CONNECTOR (Ref # 13159)	13159-0008	1
SENSOR,SPEED,RR (Ref # 21176)	21176-0995	1
ROD-ASSY-BRAKE (Ref # 43010)	43010-0031	1
CYLINDER-ASSY-MASTER,RR (Ref # 43015)	43015-0794	1
CYLINDER-MASTER,RR (Ref # 43016)	43016-1208	1
PISTON-COMP-BRAKE (Ref # 43020)	43020-1057	1
CAP-BRAKE (Ref # 43026)	43026-0014	1
PLATE-DIAPHRAGM (Ref # 43027)	43027-0006	1
DIAPHRAGM (Ref # 43028)	43028-0009	1
RESERVOIR (Ref # 43078)	43078-0056	1
HOSE-BRAKE,ABS UNIT-RR CALIPER (Ref # 43095A)	43095-1856	1
HOSE-BRAKE (Ref # 43095B)	43095-1857	1
HOSE-BRAKE,RR M/C-ABS UNIT (Ref # 43095C)	43095-1967	1
COVER-SEAL,BRAKE PISTON (Ref # 49016)	49016-1103	1
WASHER-SEAL,10.1X14.5X1.5 (Ref # 49091)	49091-0001	4
RING-SNAP,20.9X24.6X1.2 (Ref # 92033)	92033-0079	1
RING-SNAP,20.5MM (Ref # 92033A)	92033-1186	1
CLAMP (Ref # 92037)	92037-1710	2
PIN,8X17 (Ref # 92043)	92043-0104	1
RING-O,14.8X2.4 (Ref # 92055)	92055-0741	1
GROMMET,12.2X26X16 (Ref # 92071)	92071-0785	1
SPRING,MASTER CYLINDER (Ref # 92081)	92081-1737	1
BOLT (Ref # 92151)	92151-1166	1
BOLT,OIL,L=23 (Ref # 92153)	92153-0627	2
BOLT,SOCKET,6X12 (Ref # 92153A)	92153-1617	1
BOLT,SOCKET,8X30 (Ref # 92153B)	92153-1624	2

## 2025 KLR650 Adventure ABS PARTS LIST

### Rear Master Cylinder

ITEM NAME	PART NUMBER	QUANTITY
BOLT,FLANGED,6X10 (Ref # 92154)	92154-0950	2
DAMPER (Ref # 92161)	92161-2387	1
CLAMP (Ref # 92171)	92171-0640	2
CLAMP (Ref # 92171A)	92171-0817	1
CLAMP (Ref # 92171B)	92171-0818	1
CLAMP,BRAKE HOSE (Ref # 92171C)	92171-1819	1
SCREW (Ref # 92172)	92172-0383	2
CLAMP,METAL PIPE (Ref # 92173)	92173-0986	1
CLAMP (Ref # 92173A)	92173-2454	1
CLAMP (Ref # 92173B)	92173-2517	1
BOLT-SOCKET,6X14 (Ref # 120)	120CA0614	1
BOLT-SOCKET,6X25 (Ref # 120A)	120CB0625	1
NUT-HEX-SMALL,8MM (Ref # 318)	318BA0800	1
PIN-COTTER,2.0X15 (Ref # 550)	550AA2015	1