

2024 KLR® 650 ADVENTURE ABS PARTS DIAGRAM

Valve(s)

E1210

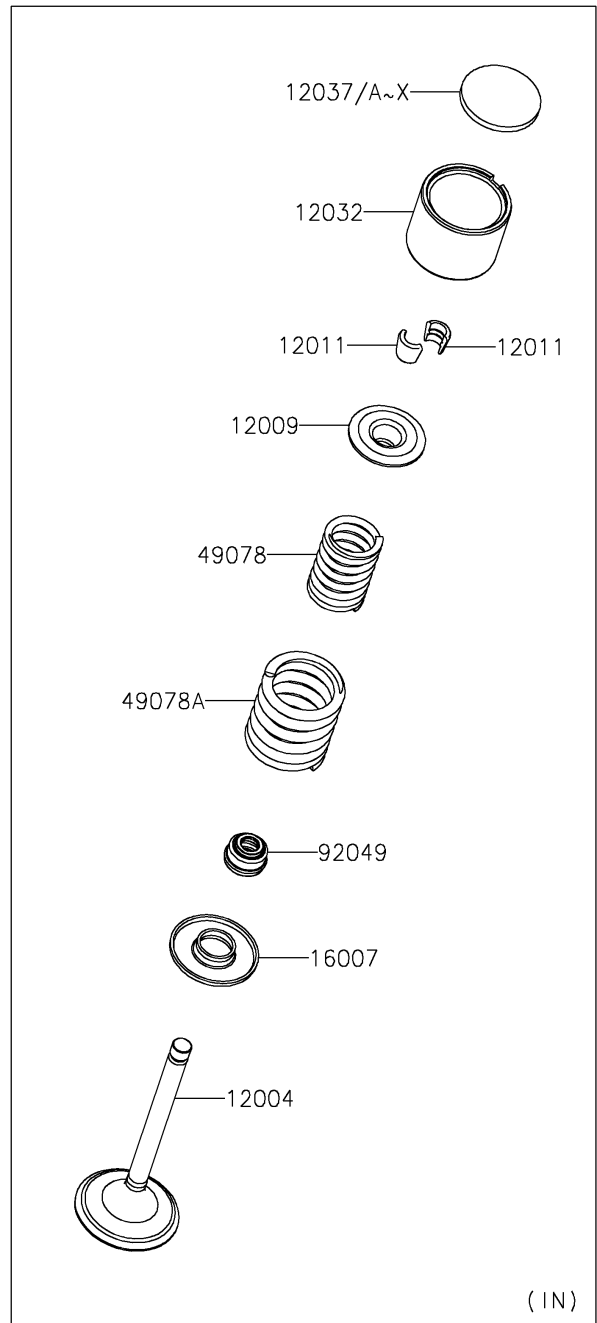
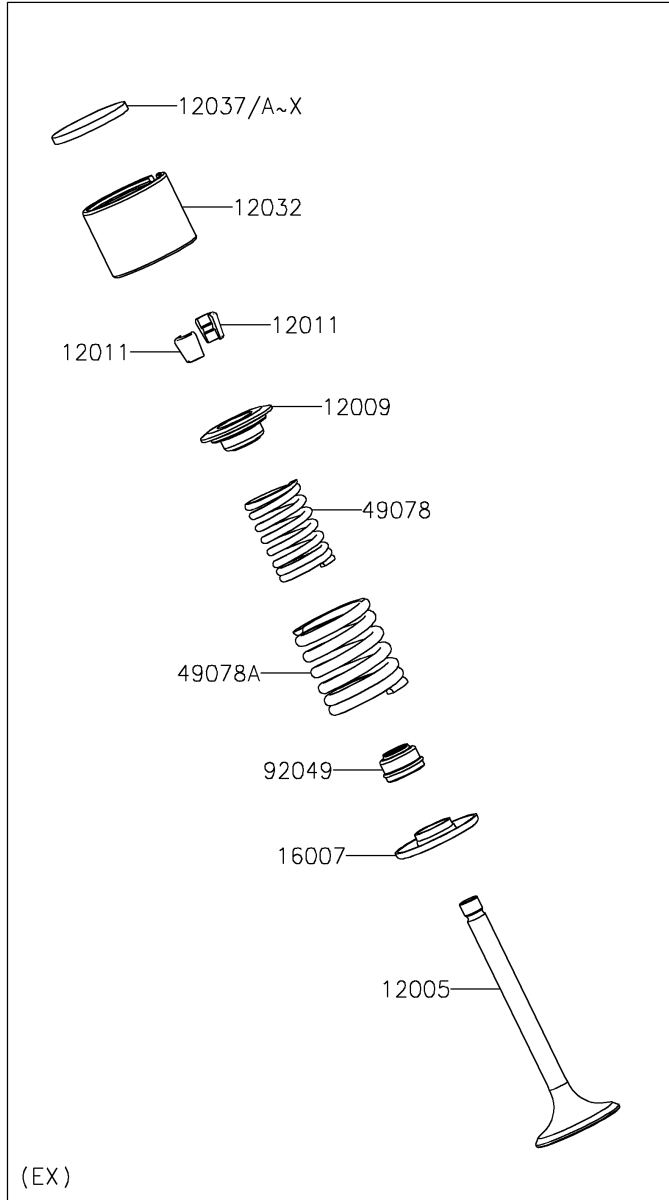

2024 KLR® 650 ADVENTURE ABS PARTS LIST

Valve(s)

| ITEM NAME | PART NUMBER | QUANTITY |
|-------------------------------------|-------------|----------|
| VALVE-INTAKE (Ref # 12004) | 12004-0727 | 2 |
| VALVE-EXHAUST (Ref # 12005) | 12005-0740 | 2 |
| RETAINER-VALVE SPRING (Ref # 12009) | 12009-005 | 4 |
| COLLET,RETAINER (Ref # 12011) | 12011-004 | 8 |
| TAPPET (Ref # 12032) | 12032-1002 | 4 |
| SHIM,T=2.00 (Ref # 12037) | 12037-001 | AR |
| SHIM,T=2.05 (Ref # 12037A) | 12037-002 | AR |
| SHIM,T=2.10 (Ref # 12037B) | 12037-003 | AR |
| SHIM,T=2.15 (Ref # 12037C) | 12037-004 | AR |
| SHIM,T=2.20 (Ref # 12037D) | 12037-005 | AR |
| SHIM,T=2.25 (Ref # 12037E) | 12037-006 | AR |
| SHIM,T=2.30 (Ref # 12037F) | 12037-007 | AR |
| SHIM,T=2.35 (Ref # 12037G) | 12037-008 | AR |
| SHIM,T=2.40 (Ref # 12037H) | 12037-009 | AR |
| SHIM,T=2.45 (Ref # 12037I) | 12037-010 | AR |
| SHIM,T=2.50 (Ref # 12037J) | 12037-011 | AR |
| SHIM,T=2.55 (Ref # 12037K) | 12037-012 | AR |
| SHIM,T=2.60 (Ref # 12037L) | 12037-013 | AR |
| SHIM,T=2.65 (Ref # 12037M) | 12037-014 | AR |
| SHIM,T=2.70 (Ref # 12037N) | 12037-015 | AR |
| SHIM,T=2.75 (Ref # 12037O) | 12037-016 | AR |
| SHIM,T=2.80 (Ref # 12037P) | 12037-017 | AR |
| SHIM,T=2.85 (Ref # 12037Q) | 12037-018 | AR |
| SHIM,T=2.90 (Ref # 12037R) | 12037-019 | AR |
| SHIM,T=2.95 (Ref # 12037S) | 12037-020 | AR |
| SHIM,T=3.00 (Ref # 12037T) | 12037-021 | AR |
| SHIM,T=3.05 (Ref # 12037U) | 12037-022 | AR |
| SHIM,T=3.10 (Ref # 12037V) | 12037-023 | AR |
| SHIM,T=3.15 (Ref # 12037W) | 12037-024 | AR |

2024 KLR® 650 ADVENTURE ABS PARTS LIST

Valve(s)

| ITEM NAME | PART NUMBER | QUANTITY |
|--|-------------|----------|
| SHIM,T=3.20 (Ref # 12037X) | 12037-025 | AR |
| SEAT-SPRING,VALVE (Ref # 16007) | 16007-1024 | 4 |
| SPRING-ENGINE VALVE,INNER (Ref # 49078) | 49078-1065 | 4 |
| SPRING-ENGINE VALVE,OUTER (Ref # 49078A) | 49078-1066 | 4 |
| SEAL-OIL,RV37129.5 (Ref # 92049) | 92049-016 | 4 |