

1991 Ninja® 600R PARTS DIAGRAM

Secondary Shaft

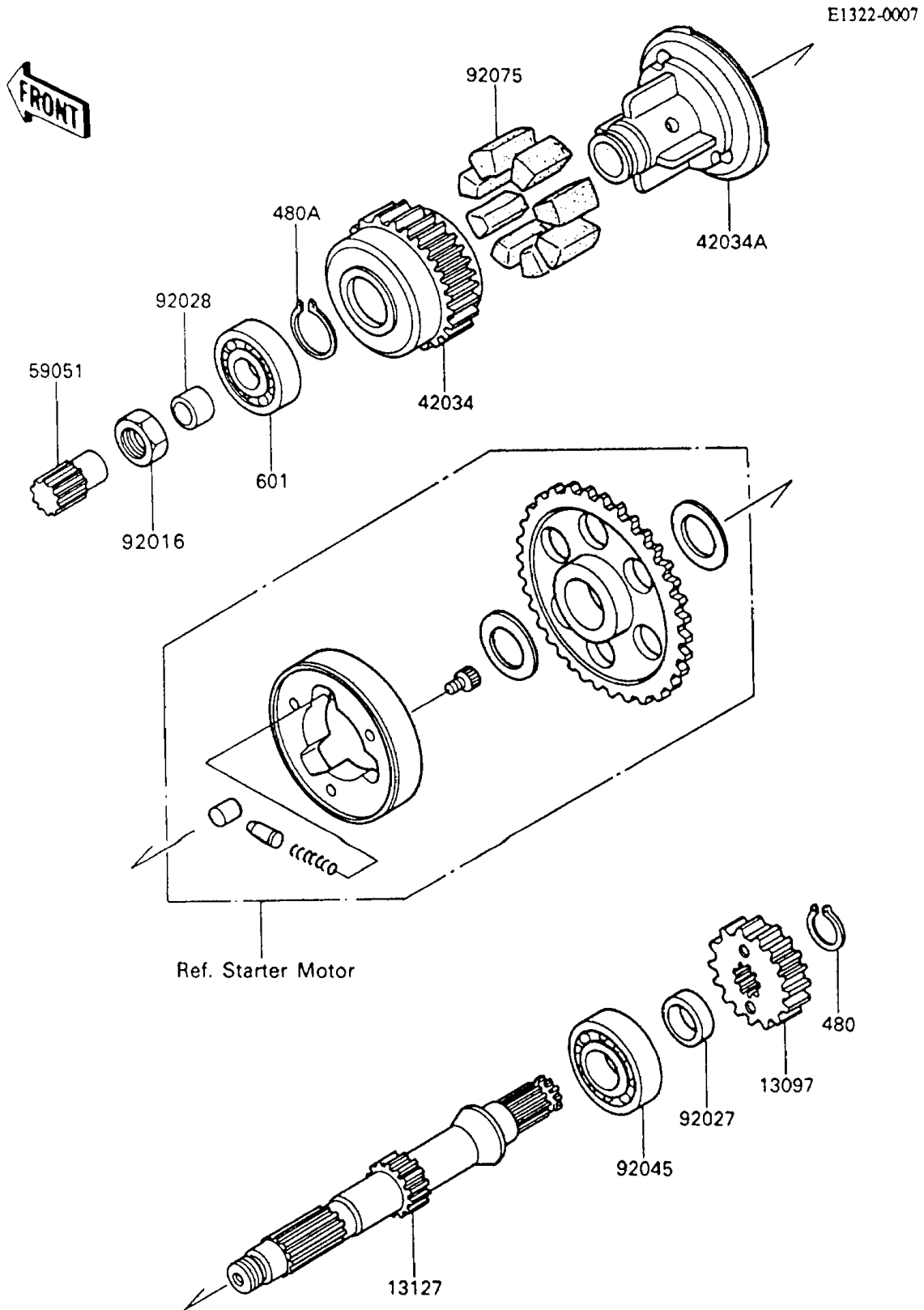

1991 Ninja® 600R PARTS LIST

Secondary Shaft

| ITEM NAME | PART NUMBER | QUANTITY |
|---|-------------|----------|
| GEAR-PRIMARY SPUR,28T (Ref # 13097) | 13097-1141 | 1 |
| SHAFT,SECONDARY (Ref # 13127) | 13127-1123 | 1 |
| COUPLING,OUTER,SECONDARY SHAFT (Ref # 42034) | 42034-1004 | 1 |
| COUPLING,INNER,SECONDARY SHAFT (Ref # 42034A) | 42034-1005 | 1 |
| GEAR-SPUR,10T,SECONDARY (Ref # 59051) | 59051-1137 | 1 |
| NUT,20MM (Ref # 92016) | 92016-028 | 1 |
| COLLAR,22X34X7.3 (Ref # 92027) | 92027-1438 | 1 |
| BUSHING,20X25X16.6 (Ref # 92028) | 92028-1037 | 1 |
| BEARING-BALL,#63/22X (Ref # 92045) | 92045-1017 | 1 |
| DAMPER,COUPLING (Ref # 92075) | 92075-1070 | 1 |
| CIRCLIP-TYPE-C,22MM (Ref # 480) | 480J2200 | 1 |
| CIRCLIP-TYPE-C,28MM (Ref # 480A) | 480J2800 | 1 |
| BEARING-BALL,#6205C3 (Ref # 601) | 601B6205 | 1 |