

2000 Ninja® ZX™-12R PARTS DIAGRAM

Chassis Electrical Equipment

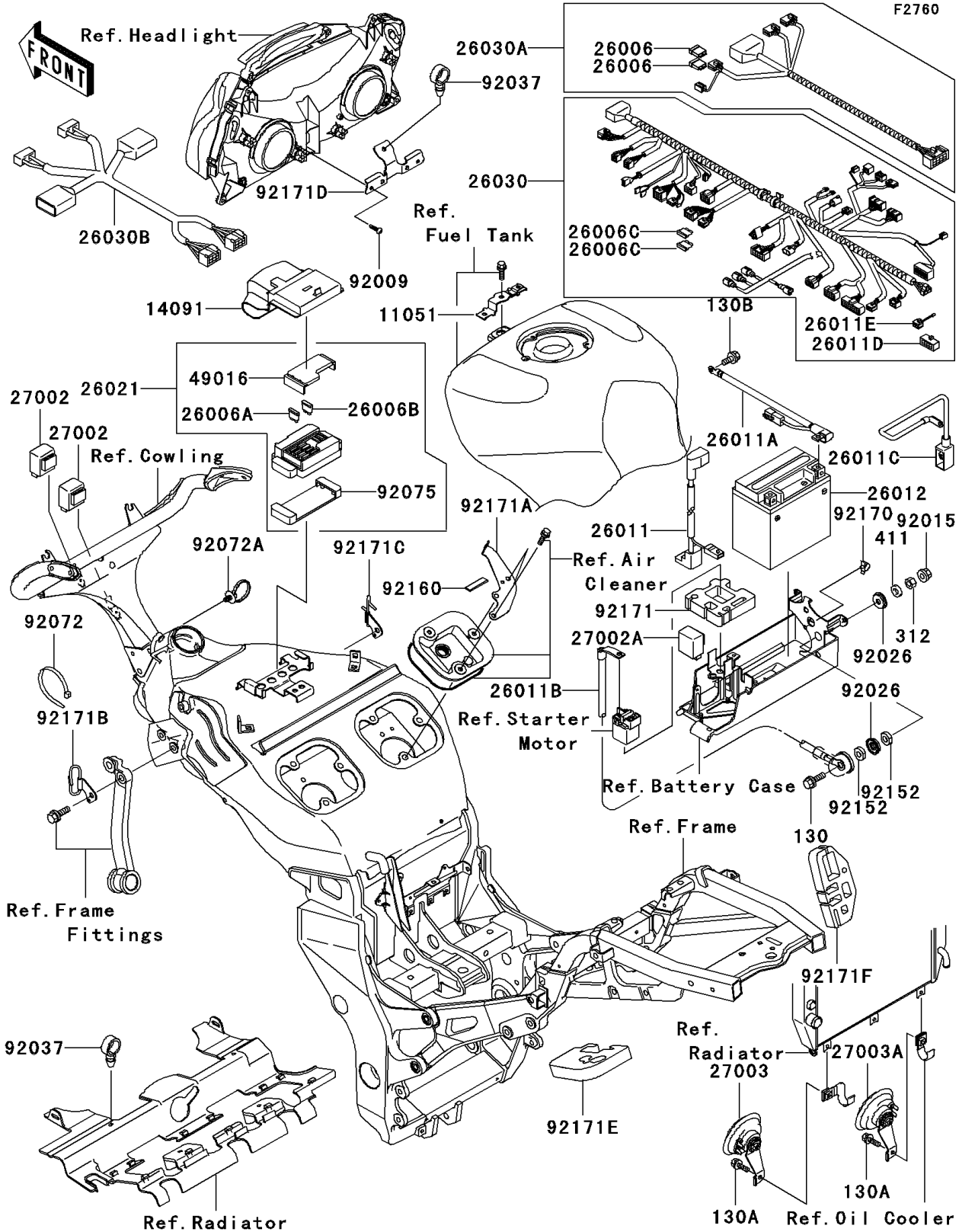

2000 Ninja® ZX™-12R PARTS LIST

Chassis Electrical Equipment

ITEM NAME	PART NUMBER	QUANTITY
BOLT-FLANGED,6X30 (Ref # 130)	130H0630	1
BRACKET,FUSE (Ref # 11051)	11051-1474	1
COVER,JUNCTION BOX (Ref # 14091)	14091-1280	1
FUSE,20A-Y (Ref # 26006)	26006-1051	2
FUSE,30A-G (Ref # 26006A)	26006-1067	1
FUSE,10A-R (Ref # 26006B)	26006-1068	8
FUSE,15A (Ref # 26006C)	26006-1075	2
WIRE-LEAD,BATTERY(+) (Ref # 26011)	26011-1730	1
WIRE-LEAD,BATTERY(-) (Ref # 26011A)	26011-1731	1
WIRE-LEAD,SUB (Ref # 26011B)	26011-1762	1
WIRE-LEAD,(+),JUMP START (Ref # 26011C)	26011-1772	1
WIRE-LEAD,SETTING(A) (Ref # 26011D)	26011-1773	1
WIRE-LEAD,DIAGNOSIS (Ref # 26011E)	26011-1774	1
BATTERY,YTX14-BS,12V 12AH (Ref # 26012)	26012-1334	1
JUNCTION BOX (Ref # 26021)	26021-1089	1
HARNESS,MAIN (Ref # 26030)	26030-1677	1
HARNESS,SUB (Ref # 26030A)	26030-1752	1
HARNESS,FR (Ref # 26030B)	26030-1779	1
RELAY-ASSY,STARTER CIRCUIT (Ref # 27002)	27002-1086	2
RELAY-ASSY,TURN SIGNAL (Ref # 27002A)	27002-1101	1
HORN,LH (Ref # 27003)	27003-1418	1
HORN,RH (Ref # 27003A)	27003-1419	1
COVER-SEAL,FUSE (Ref # 49016)	49016-1177	1
SCREW,TAPPING,5X14 (Ref # 92009)	92009-1197	2
NUT,FLANGED,6MM (Ref # 92015)	92015-1367	1
SPACER (Ref # 92026)	92026-1575	2
CLAMP,HOSE (Ref # 92037)	92037-1827	2
BAND,L=202 (Ref # 92072)	92072-1195	1
BAND (Ref # 92072A)	92072-1392	1

2000 Ninja® ZX™-12R PARTS LIST

Chassis Electrical Equipment

ITEM NAME	PART NUMBER	QUANTITY
DAMPER,JUNCTION BOX (Ref # 92075)	92075-1688	1
COLLAR (Ref # 92152)	92152-1252	2
DAMPER (Ref # 92160)	92160-1099	1
CLAMP,HARNESS (Ref # 92170)	92170-1494	1
CLAMP,HARNESS (Ref # 92171)	92171-1110	1
CLAMP,HARNESS (Ref # 92171A)	92171-1129	1
CLAMP,H/P L HARNESS (Ref # 92171B)	92171-1207	1
CLAMP,H/P R HARNESS (Ref # 92171C)	92171-1208	1
CLAMP,HEAD LAMP COUPLER (Ref # 92171D)	92171-1211	1
CLAMP,HARNESS (Ref # 92171E)	92171-1255	1
CLAMP,HARNESS (Ref # 92171F)	92171-1256	1
BOLT-FLANGED (Ref # 130A)	130J0612	2
BOLT-FLANGED,6X10 (Ref # 130B)	130V0610	1
NUT-HEX (Ref # 312)	312H0600	1
WASHER-PLAIN,6MM (Ref # 411)	411E0600	1