

1996 GPZ 1100 ABS PARTS DIAGRAM

Front Fork

F2340

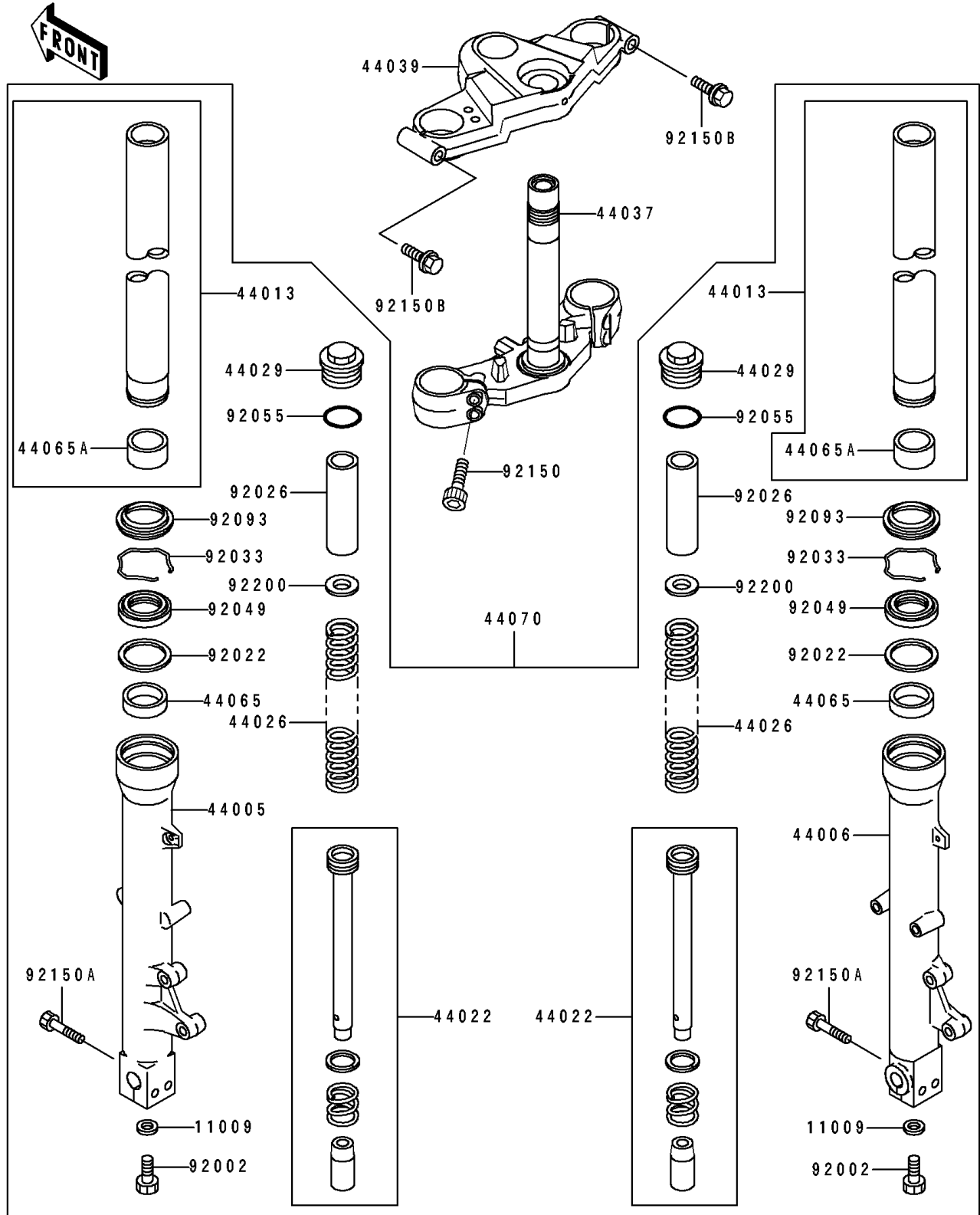

1996 GPZ 1100 ABS PARTS LIST

Front Fork

| ITEM NAME | PART NUMBER | QUANTITY |
|--|-------------|----------|
| GASKET,FORK DRAIN PLUG (Ref # 11009) | 11009-1553 | 2 |
| PIPE-LEFT FORK OUTER (Ref # 44005) | 44005-1351 | 1 |
| PIPE-RIGHT FORK OUTER (Ref # 44006) | 44006-1349 | 1 |
| PIPE-FORK INNER (Ref # 44013) | 44013-1408 | 2 |
| CYLINDER-FORK (Ref # 44022) | 44022-1305 | 2 |
| SPRING-FRONT FORK (Ref # 44026) | 44026-1578 | 2 |
| SEAT-FORK SPRING (Ref # 44029) | 44029-1147 | 2 |
| HOLDER-FORK UNDER (Ref # 44037) | 44037-1336 | 1 |
| HOLDER-FORK UPPER (Ref # 44039) | 44039-1258 | 1 |
| BUSHING-FRONT FORK (Ref # 44065) | 44065-1085 | 2 |
| BUSHING-FRONT FORK,INNER PIPE (Ref # 44065A) | 44065-1086 | 2 |
| DAMPER-ASSY,FORK (Ref # 44070) | 44070-1408 | 1 |
| BOLT,FORK DRAIN (Ref # 92002) | 92002-1650 | 2 |
| WASHER,FORK OUTER TUBE (Ref # 92022) | 92022-1298 | 2 |
| SPACER,FORK,L=183 (Ref # 92026) | 92026-1465 | 2 |
| RING-SNAP (Ref # 92033) | 92033-1036 | 2 |
| SEAL-OIL,FORK OUTER TUBE (Ref # 92049) | 92049-1356 | 2 |
| RING-O (Ref # 92055) | 92055-1321 | 2 |
| SEAL,FORK OUTER TUBE (Ref # 92093) | 92093-1359 | 2 |
| BOLT,SOCKET,8X25 (Ref # 92150) | 92150-1172 | 4 |
| BOLT,SOCKET,8X40 (Ref # 92150A) | 92150-1194 | 4 |
| BOLT,FLANGED,10X45 (Ref # 92150B) | 92150-1210 | 2 |
| WASHER (Ref # 92200) | 92200-1191 | 2 |