

1993 Ninja® ZX™-11 PARTS DIAGRAM

Cowling(ZX1100-D1)

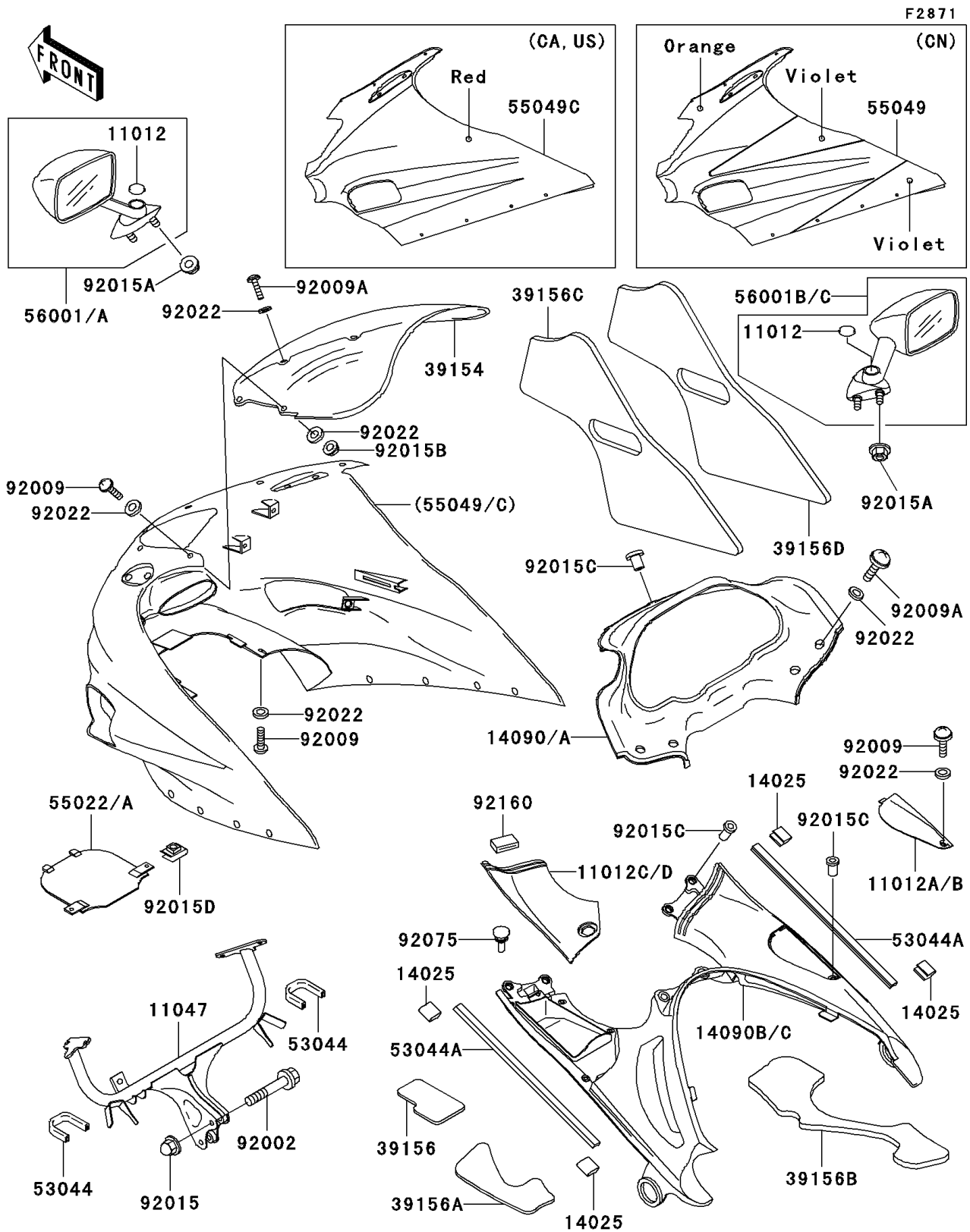

1993 Ninja® ZX™-11 PARTS LIST

Cowling(ZX1100-D1)

ITEM NAME	PART NUMBER	QUANTITY
CAP,MIRROR,BLACK (Ref # 11012)	11012-1751-6Z	1
BRACKET,UPP COWLING (Ref # 11047)	11047-1920	1
COVER,TRIM END (Ref # 14025)	14025-1756	1
WINDSHIELD (Ref # 39154)	39154-1122	1
PAD,INNER COWLING,LH,FR (Ref # 39156)	39156-1329	1
PAD,INNER COWLING,LH,RR (Ref # 39156A)	39156-1330	1
PAD,INNER COWLING,RH (Ref # 39156B)	39156-1331	1
PAD,UPP COWLING,LH (Ref # 39156C)	39156-1332	1
PAD,UPP COWLING,RH (Ref # 39156D)	39156-1333	1
TRIM,L=100 (Ref # 53044)	53044-1200	1
TRIM,L=385 (Ref # 53044A)	53044-1255	1
BOLT,8X35 (Ref # 92002)	92002-1198	1
SCREW,5X16 (Ref # 92009)	92009-1654	1
SCREW,5X25 (Ref # 92009A)	92009-1657	1
NUT,CAP,8MM,BLACK (Ref # 92015)	92015-1174	1
NUT,FLANGED,6MM,BLACK (Ref # 92015A)	92015-1233	1
NUT,LOCK 5MM (Ref # 92015B)	92015-1263	1
NUT,WELL,5MM (Ref # 92015C)	92015-1757	1
NUT,5MM (Ref # 92015D)	92015-1798	1
WASHER,NYLON,5.3X11.5X1.5 (Ref # 92022)	92022-1521	1
DAMPER (Ref # 92075)	92075-1808	1
DAMPER (Ref # 92160)	92160-1190	1
CAP,INNER COWLING,RH,GRAY (Ref # 11012A)	11012-1832-11	1
CAP,INNER COWLING,RH,GRAY (Ref # 11012B)	11012-1832-12	1
CAP,INNER COWLING,LH,GRAY (Ref # 11012C)	11012-1833-11	1
CAP,INNER COWLING,LH,GRAY (Ref # 11012D)	11012-1833-12	1
COVER,INNER COWLING,FR,GRAY (Ref # 14090)	14090-1273-11	1
COVER,INNER COWLING,FR,GRAY (Ref # 14090A)	14090-1273-12	1
COVER,INNER COWLING,RR,GRAY (Ref # 14090B)	14090-1274-11	1

1993 Ninja® ZX™-11 PARTS LIST

Cowling(ZX1100-D1)

ITEM NAME	PART NUMBER	QUANTITY
COVER,INNER COWLING,RR,GRAY (Ref # 14090C)	14090-1274-12	1
COVER-HEAD LAMP,C.S.ORANGE (Ref # 55022)	55022-1074-RK	1
COVER-HEAD LAMP,C.W.RED (Ref # 55022A)	55022-1074-TF	1
COWLING.,UPP,VIOLET/ORANGE (Ref # 55049)	55049-5170-VR	1
COWLING.,UPP,C.W.RED (Ref # 55049C)	55049-5182-TF	1
MIRROR-ASSY,LH,C.W.RED (Ref # 56001)	56001-1390-H3	1
MIRROR-ASSY,LH,C.S.ORANGE (Ref # 56001A)	56001-1390-RK	1
MIRROR-ASSY,RH,C.W.RED (Ref # 56001B)	56001-1391-H3	1
MIRROR-ASSY,RH,C.S.ORANGE (Ref # 56001C)	56001-1391-RK	1