

1989 Ninja® ZX™-10 PARTS DIAGRAM

Transmission

E1361-0199

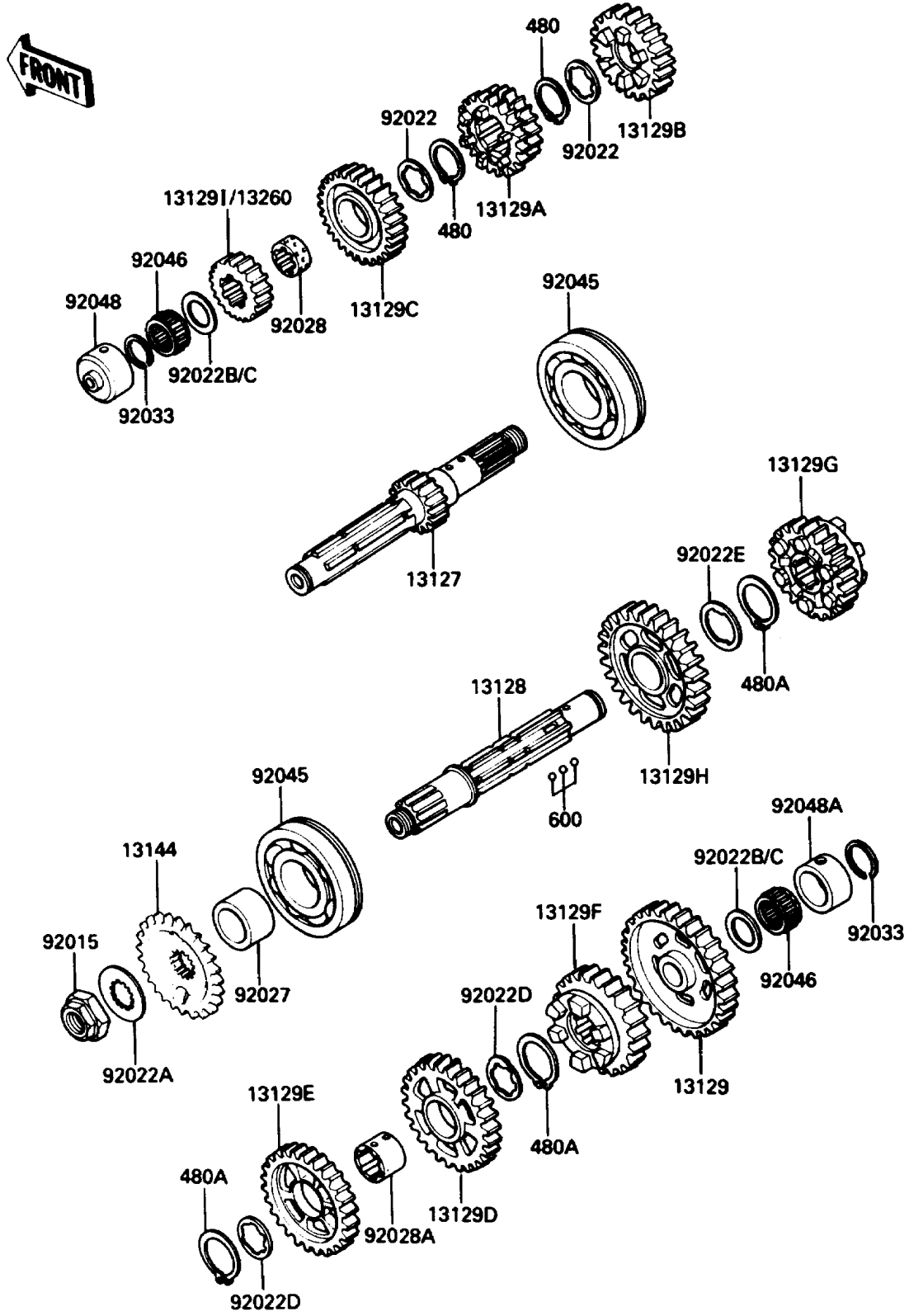

1989 Ninja® ZX™-10 PARTS LIST

Transmission

ITEM NAME	PART NUMBER	QUANTITY
CIRCLIP-TYPE-C,28MM (Ref # 480)	480J2800	2
CIRCLIP (Ref # 480A)	480J2900	3
BALL-STEEL,5/32" (Ref # 600)	600A0500	3
SHAFT-TRANSMISSION INPUT,15T (Ref # 13127)	13127-1146	1
SHAFT-TRANSMISSION OUTPUT (Ref # 13128)	13128-1113	1
GEAR,OUTPUT LOW,42T (Ref # 13129)	13129-1534	1
GEAR,INPUT 3RD&4TH,24T&22T (Ref # 13129A)	13129-1664	1
GEAR,INPUT 5TH,26T (Ref # 13129B)	13129-1665	1
GEAR,INPUT TOP,28T (Ref # 13129C)	13129-1666	1
GEAR,OUTPUT 3RD,35T (Ref # 13129D)	13129-1669	1
GEAR,OUTPUT 4TH,32T (Ref # 13129E)	13129-1670	1
GEAR,OUTPUT 5TH,30T (Ref # 13129F)	13129-1671	1
GEAR,OUTPUT TOP,29T (Ref # 13129G)	13129-1672	1
GEAR,OUTPUT 2ND,38T (Ref # 13129H)	13129-1934	1
SPROCKET-OUTPUT,17T (Ref # 13144)	13144-1146	1
NUT,20MM (Ref # 92015)	92015-1210	1
WASHER,TOOTHED,26X35.5X1.5 (Ref # 92022)	92022-1077	2
WASHER,TOOTHED,23.9X45X1.0 (Ref # 92022A)	92022-1336	1
WASHER,22.3X35X1.6 (Ref # 92022B)	92022-212	2
WASHER,22.3X35X1.2 (Ref # 92022C)	92022-213	AR
WASHER,TOOTHED,30.3X40X1.5 (Ref # 92022D)	92024-043	2
WASHER,TOOTHED,30.5X38X1 (Ref # 92022E)	92024-069	1
COLLAR,28X40X23.5 (Ref # 92027)	92027-1711	1
BUSHING,TOP GEAR (Ref # 92028)	92028-1124	1
BUSHING,OUTPUT 3RD&4TH (Ref # 92028A)	92028-1363	1
RING-SNAP,20X25.5X1.2 (Ref # 92033)	92033-025	2
BEARING-BALL (Ref # 92045)	92045-1186	2
BEARING-NEEDLE,FWF-223014 (Ref # 92046)	92046-031	2
RACE,INPUT SHAFT (Ref # 92048)	92048-1052	1

1989 Ninja® ZX™-10 PARTS LIST

Transmission

ITEM NAME	PART NUMBER	QUANTITY
RACE,30X38X15 (Ref # 92048A)	92048-1053	1
GEAR,INPUT 2ND,19T (Ref # 13129I)	13129-1953	1
GEAR,INPUT 2ND,19T (Ref # 13260)	13260-1065	1