

1989 Ninja® ZX™-10 PARTS DIAGRAM

Balancer

E1323-0011

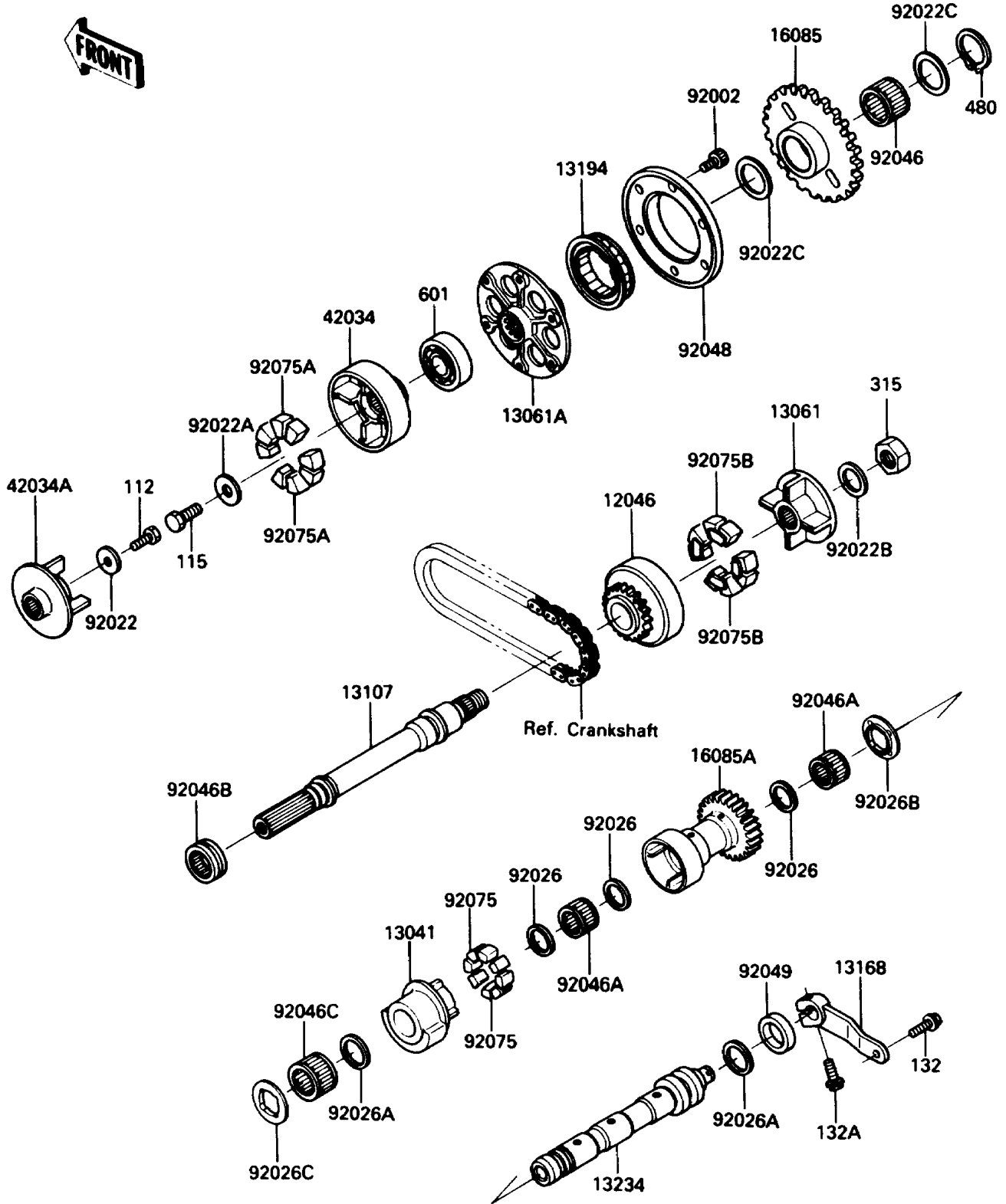

1989 Ninja® ZX™-10 PARTS LIST

Balancer

ITEM NAME	PART NUMBER	QUANTITY
BOLT-UPSET (Ref # 112)	112G0616	1
BOLT-SMALL-UPSET (Ref # 115)	115G0820	1
BOLT-FLANGED-SMALL (Ref # 132)	132J0616	1
BOLT-FLANGED-SMALL (Ref # 132A)	132J0620	1
NUT-HEX-FINE (Ref # 315)	315G1600	1
CIRCLIP-TYPE-C,25MM (Ref # 480)	480J2500	1
BEARING-BALL,#6203 (Ref # 601)	601A6203	1
SPROCKET,GENERATOR (Ref # 12046)	12046-1083	1
BALANCER (Ref # 13041)	13041-1092	1
BOSS,SPROCKET (Ref # 13061)	13061-1183	1
BOSS (Ref # 13061A)	13061-1264	1
SHAFT (Ref # 13107)	13107-1108	1
LEVER,BALANCER (Ref # 13168)	13168-1236	1
CLUTCH-ONEWAY (Ref # 13194)	13194-1067	1
SHAFT-COMP,BALANCER (Ref # 13234)	13234-1072	1
GEAR,ONEWAY CLUTCH (Ref # 16085)	16085-1173	1
GEAR,BALANCER (Ref # 16085A)	16085-1214	1
COUPLING (Ref # 42034)	42034-1055	1
COUPLING (Ref # 42034A)	42034-1056	1
BOLT,SOCKET,6X12 (Ref # 92002)	92002-1796	6
WASHER,6X19.5X2 (Ref # 92022)	92022-1517	1
WASHER,8X22X3 (Ref # 92022A)	92022-1518	1
WASHER,16X26X2 (Ref # 92022B)	92022-1519	1
WASHER,25.3X32X0.5 (Ref # 92022C)	92022-225	2
SPACER,21.3X24.3X1.5 (Ref # 92026)	92026-1213	3
SPACER,21.3X26X1 (Ref # 92026A)	92026-1223	2
SPACER (Ref # 92026B)	92026-1265	1
SPACER (Ref # 92026C)	92026-1271	1
BEARING-NEEDLE,K253020S (Ref # 92046)	92046-1022	1

1989 Ninja® ZX™-10 PARTS LIST

Balancer

ITEM NAME	PART NUMBER	QUANTITY
BEARING-NEEDLE,K21X25X17V2 (Ref # 92046A)	92046-1105	2
BEARING-NEEDLE,RNA4903 (Ref # 92046B)	92046-1109	1
BEARING-NEEDLE (Ref # 92046C)	92046-1155	1
RACE,ONEWAY CLUTCH (Ref # 92048)	92048-1068	1
SEAL-OIL,S192705 (Ref # 92049)	92049-1174	1
DAMPER,BALANCER (Ref # 92075)	92075-1709	8
DAMPER,COUPLING (Ref # 92075A)	92075-1790	4
DAMPER,COUPLING (Ref # 92075B)	92075-1810	4