

2005 ZR-7S (Canada Only) PARTS DIAGRAM

Turn Signals

F2730

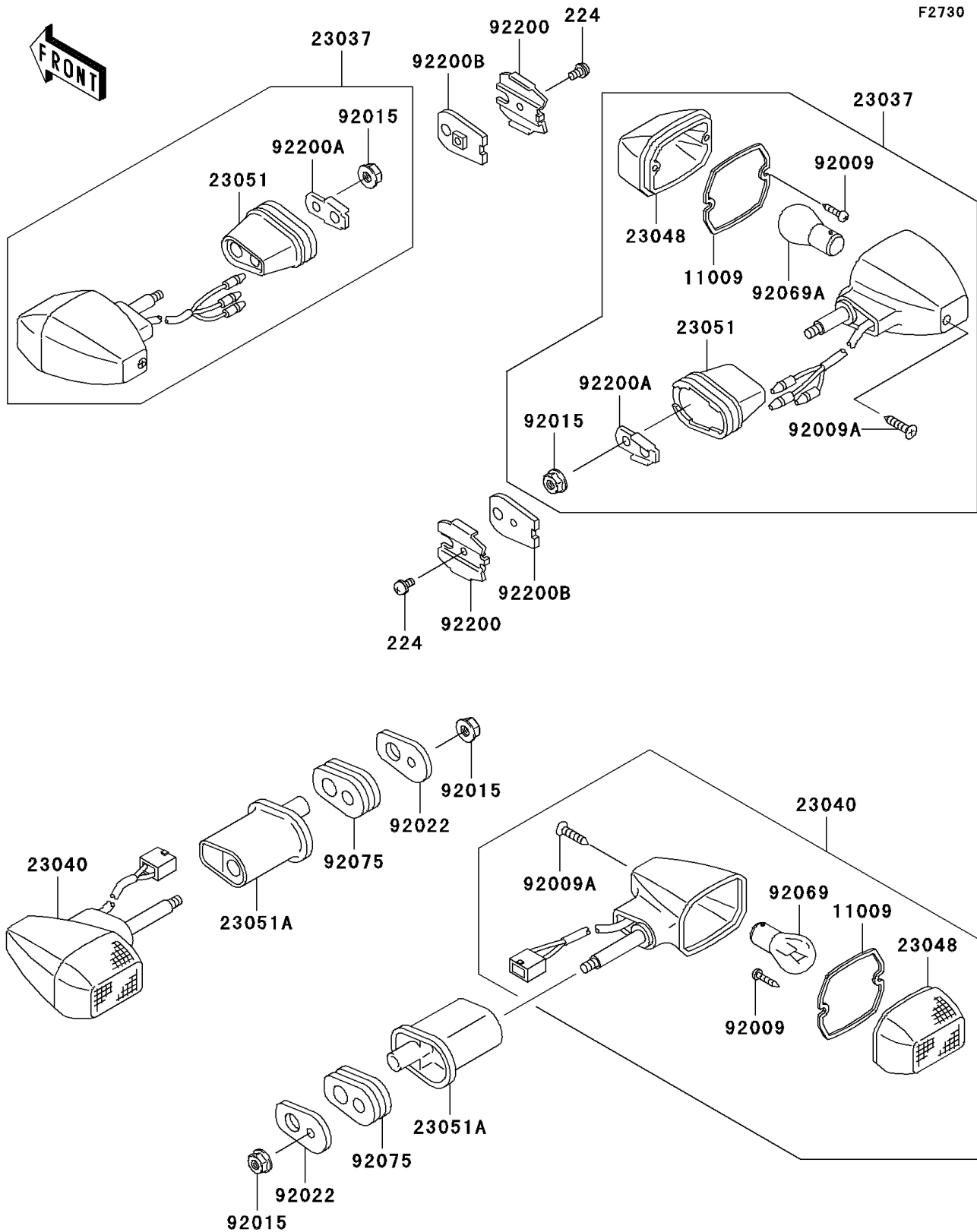

2005 ZR-7S (Canada Only) PARTS LIST

Turn Signals

| ITEM NAME | PART NUMBER | QUANTITY |
|---------------------------------------|-------------|----------|
| SCREW-PAN-WP-CROS,4X8 (Ref # 224) | 224C0408 | 2 |
| GASKET,SIGNAL LAMP (Ref # 11009) | 11009-1402 | 4 |
| LAMP-ASSY-SIGNAL,FR (Ref # 23037) | 23037-1299 | 2 |
| LAMP-SIGNAL,RR (Ref # 23040) | 23040-1285 | 2 |
| LENS-SIGNAL LAMP (Ref # 23048) | 23048-1054 | 4 |
| BRACKET-SIGNAL LAMP,FR (Ref # 23051) | 23051-1207 | 2 |
| BRACKET-SIGNAL LAMP (Ref # 23051A) | 23051-1248 | 2 |
| SCREW,TAPPING,3X16 (Ref # 92009) | 92009-1115 | 8 |
| SCREW,TAPPING,4X20 (Ref # 92009A) | 92009-1304 | 4 |
| NUT,FLANGED,6MM (Ref # 92015) | 92015-1367 | 4 |
| WASHER,SIGNAL LAMP (Ref # 92022) | 92022-1672 | 2 |
| BULB,12V 32CP(23W) (Ref # 92069) | 92069-055 | 2 |
| BULB,12V 32/3CP(23/8W) (Ref # 92069A) | 92069-060 | 2 |
| DAMPER,SIGNAL LAMP (Ref # 92075) | 92075-1698 | 2 |
| WASHER,SIGNAL LAMP (Ref # 92200) | 92200-1016 | 2 |
| WASHER (Ref # 92200A) | 92200-1021 | 2 |
| WASHER,SIGNAL LAMP (Ref # 92200B) | 92200-1520 | 2 |