

2000 ZR-7 PARTS DIAGRAM

Clutch

E1350

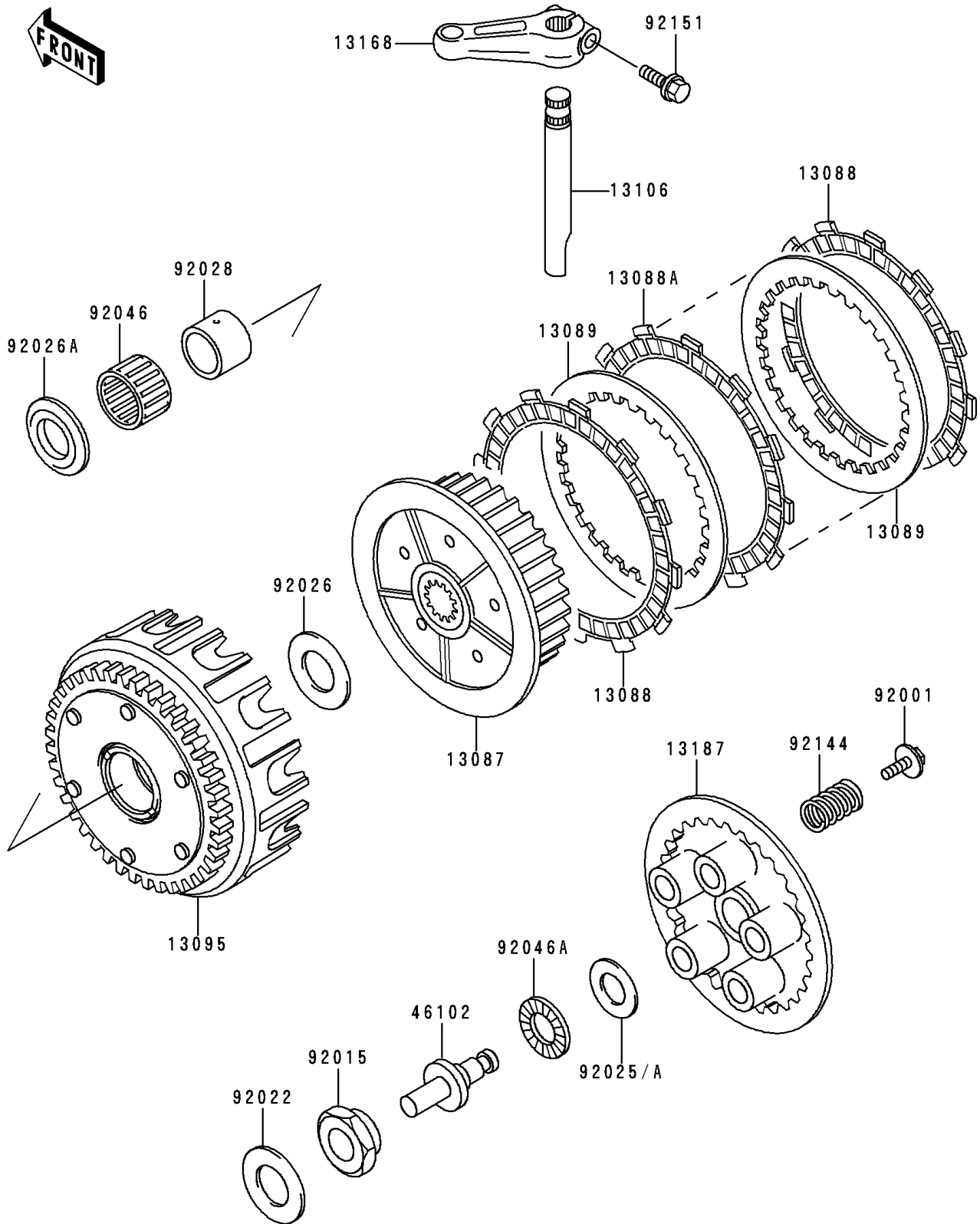

2000 ZR-7 PARTS LIST

Clutch

ITEM NAME	PART NUMBER	QUANTITY
HUB-CLUTCH (Ref # 13087)	13087-043	1
PLATE-FRICTION (Ref # 13088)	13088-1052	1
PLATE-FRICTION (Ref # 13088A)	13088-1107	1
PLATE-CLUTCH (Ref # 13089)	13089-1097	1
HOUSING-COMP-CLUTCH (Ref # 13095)	13095-1316	1
SHAFT-CLUTCH RELEASE (Ref # 13106)	13106-1124	1
LEVER,CLUTCH RELEASE (Ref # 13168)	13168-1547	1
PLATE-CLUTCH OPERATING (Ref # 13187)	13187-1014	1
ROD,CLUTCH (Ref # 46102)	46102-1313	1
BOLT,FLANGED,6X18 (Ref # 92001)	92001-1066	1
NUT,20MM (Ref # 92015)	92015-1555	1
WASHER,20.3X36X2.3 (Ref # 92022)	92022-1116	1
SHIM,15.3X27.5X0.90 (Ref # 92025)	92025-1136	1
SHIM,15.3X27.5X1.20 (Ref # 92025A)	92025-1137	1
SPACER,25.5X47X2.5 (Ref # 92026)	92026-022	1
SPACER,THRUST,T=5.5 (Ref # 92026A)	92026-116	1
BUSHING,25X32X23.6 (Ref # 92028)	92028-178	1
BEARING-NEEDLE,KTV323723 (Ref # 92046)	92046-028	1
BEARING-NEEDLE,AXK1102 (Ref # 92046A)	92046-1052	1
SPRING,CLUTCH (Ref # 92144)	92144-1889	1
BOLT,6X20 (Ref # 92151)	92151-1252	1