

# 2008 Mule 3010 Diesel 4X4 PARTS DIAGRAM

Headlight(s)

F2710

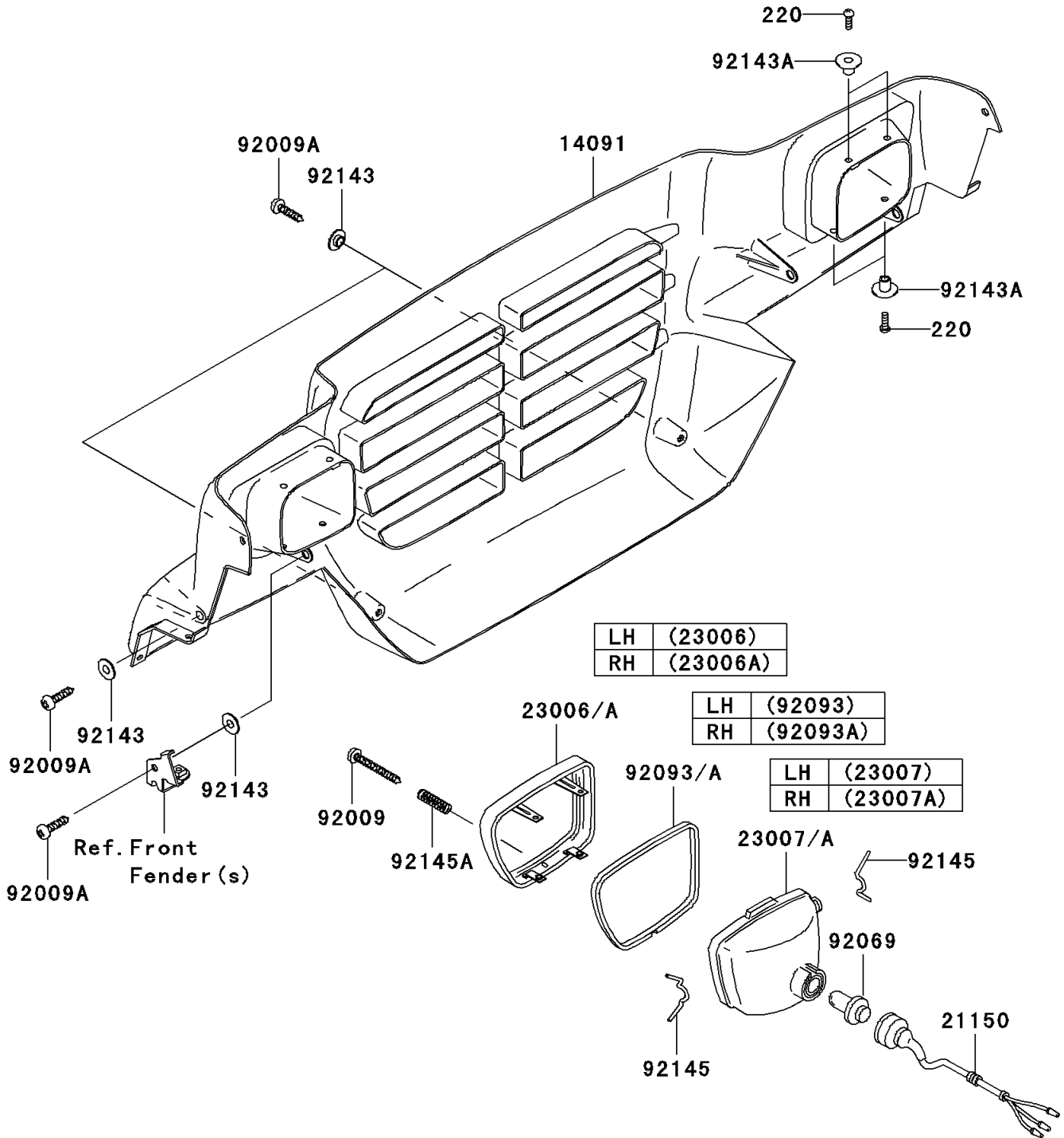

## 2008 Mule 3010 Diesel 4X4 PARTS LIST

### Headlight(s)

ITEM NAME	PART NUMBER	QUANTITY
COVER,FRONT GRIL,F.BLACK (Ref # 14091)	14091-7545-6Z	1
CORD-ASSY,HEAD LAMP (Ref # 21150)	21150-1060	2
RIM-LAMP,LH (Ref # 23006)	23006-1075	1
RIM-LAMP,RH (Ref # 23006A)	23006-1076	1
LENS-COMP,HEAD LAMP,LH (Ref # 23007)	23007-1354	1
LENS-COMP,HEAD LAMP,RH (Ref # 23007A)	23007-1355	1
SCREW,TAPPING,4X30 (Ref # 92009)	92009-1139	2
SCREW,6X16 (Ref # 92009A)	92009-1621	6
BULB,12V 30/30W (Ref # 92069)	92069-1080	2
SEAL,HEAD LAMP,LH (Ref # 92093)	92093-1481	1
SEAL,HEAD LAMP,RH (Ref # 92093A)	92093-1482	1
COLLAR (Ref # 92143)	92143-1087	6
COLLAR (Ref # 92143A)	92143-1234	8
SPRING (Ref # 92145)	92145-1190	4
SPRING (Ref # 92145A)	92145-1230	2
SCREW-PAN-CROSS,5X16 (Ref # 220)	220F0516	8