

## 1989 Concours (Canada Only) PARTS DIAGRAM

Electrical Equipment

F276U

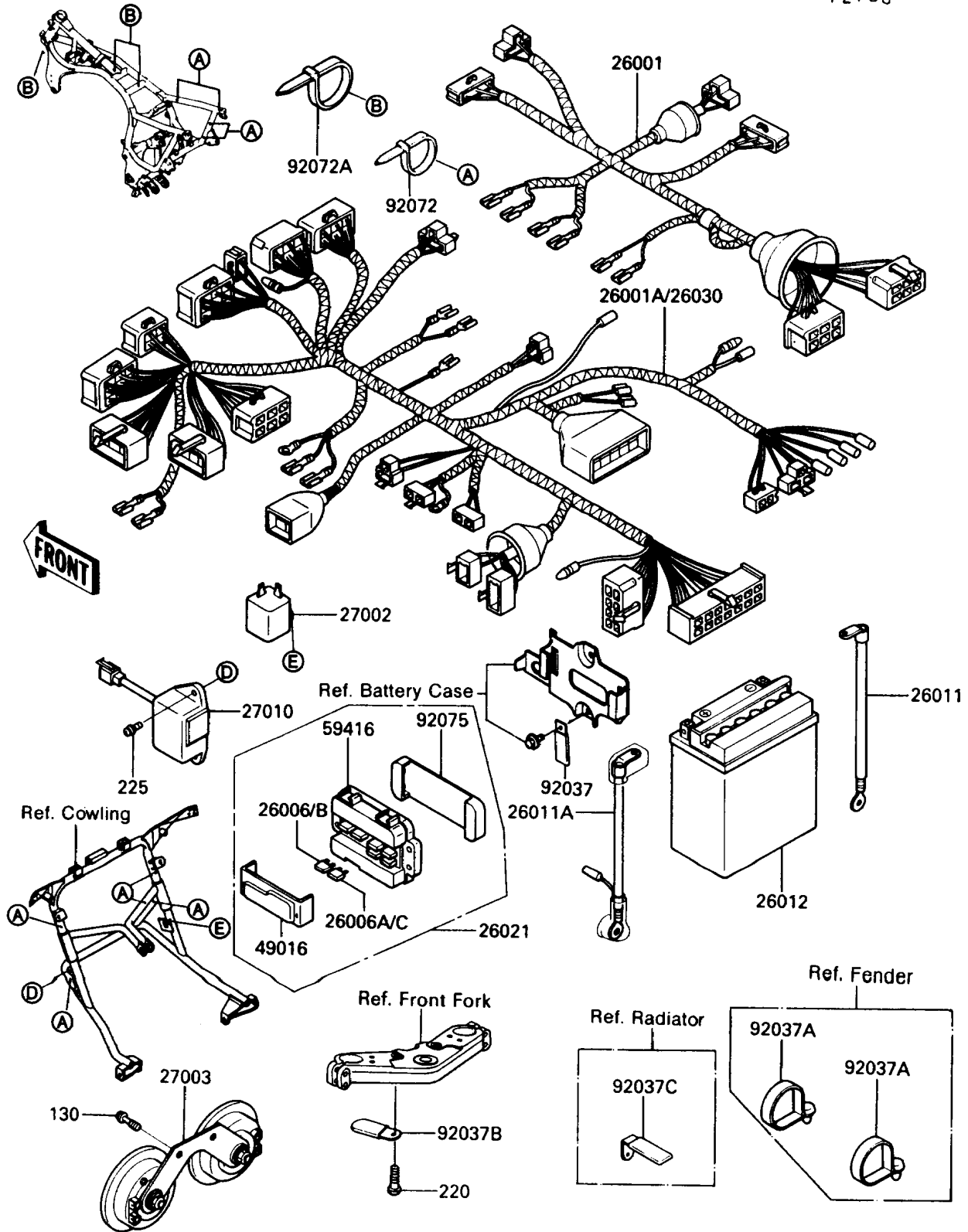

## 1989 Concours (Canada Only) PARTS LIST

### Electrical Equipment

ITEM NAME	PART NUMBER	QUANTITY
HARNESS,FR (Ref # 26001)	26001-1774	1
HARNESS,MAIN (Ref # 26001A)	26001-1838	1
FUSE,30A-G (Ref # 26006)	26006-1006	1
FUSE,10A-R (Ref # 26006A)	26006-1007	1
WIRE-LEAD,BATTERY(-) (Ref # 26011)	26011-1323	1
WIRE-LEAD,BATTERY(+) (Ref # 26011A)	26011-1358	1
BATTERY,12V 18AH,YB18L-A-TP (Ref # 26012)	26012-1183	1
RELAY-ASSY,TURN SIGNAL (Ref # 27002)	27002-1060	1
HORN,DOUBLE (Ref # 27003)	27003-1245	1
SWITCH,RESERV LIGHTING (Ref # 27010)	27010-1066	1
COVER-SEAL (Ref # 49016)	49016-1118	1
CASE-ELECTRIC (Ref # 59416)	59416-1060	1
CLAMP,WIRING HARNESS (Ref # 92037)	92037-1069	1
CLAMP,HOSE (Ref # 92037A)	92037-1163	1
CLAMP,WIRING HARNESS (Ref # 92037B)	92037-1539	1
CLAMP,HARNESS (Ref # 92037C)	92037-1564	1
BAND,L=185 (Ref # 92072)	92072-1195	1
BAND,L=365 (Ref # 92072A)	92072-1197	1
DAMPER,JUNCTION BOX (Ref # 92075)	92075-1688	1
BOLT-FLANGED,6X12 (Ref # 130)	130C0612	1
SCREW-PAN-CROS (Ref # 220)	220C0510	1
SCREW-PAN-WSP-CROS (Ref # 225)	225B0620	1