

1996 Concours (Canada Only) PARTS DIAGRAM

Carburetor

E1611

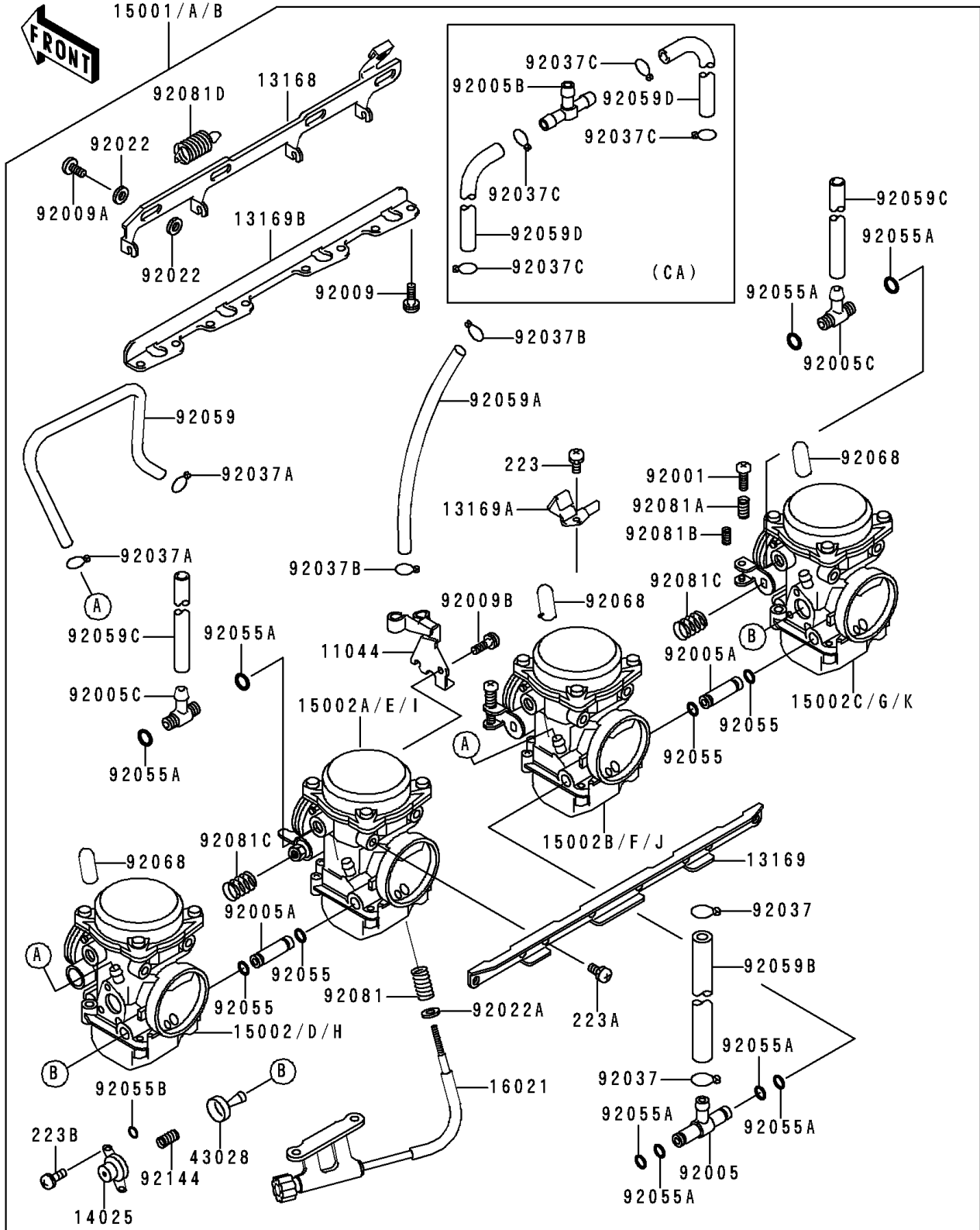

1996 Concours (Canada Only) PARTS LIST

Carburetor

| ITEM NAME | PART NUMBER | QUANTITY |
|--|-------------|----------|
| BRACKET,THROTTLE CABLE (Ref # 11044) | 11044-1546 | 1 |
| LEVER,STARTER (Ref # 13168) | 13168-1245 | 1 |
| PLATE,CARBURETOR STAY,UPP (Ref # 13169) | 13169-1869 | 1 |
| PLATE,STARTER CABLE (Ref # 13169A) | 13169-1871 | 1 |
| PLATE,CARBURETOR STAY,LWR,6MM (Ref # 13169B) | 13169-1873 | 1 |
| COVER,AIR CUT VALVE (Ref # 14025) | 14025-1903 | 2 |
| CARBURETOR-ASSY (Ref # 15001) | 15001-1247 | 1 |
| CARBURETOR,LH,OUTSIDE (Ref # 15002) | 15002-1346 | 1 |
| CARBURETOR,LH,INSIDE (Ref # 15002A) | 15002-1347 | 1 |
| CARBURETOR,RH,INSIDE (Ref # 15002B) | 15002-1348 | 1 |
| CARBURETOR,RH,OUTSIDE (Ref # 15002C) | 15002-1349 | 1 |
| SCREW-THROTTLE STOP (Ref # 16021) | 16021-1101 | 1 |
| DIAPHRAGM,AIR CUT VALVE (Ref # 43028) | 43028-1053 | 2 |
| SCREW-PAN-WS-CROS (Ref # 223) | 223C0420 | 1 |
| SCREW-PAN-WS-CROS (Ref # 223A) | 223C0510 | 8 |
| SCREW-PAN-WS-CROS (Ref # 223B) | 223D0408 | 4 |
| BOLT,THROTTLE ADJUST (Ref # 92001) | 92001-1998 | 3 |
| FITTING,FUEL,T-TYPE (Ref # 92005) | 92005-1108 | 1 |
| FITTING,FUEL,I-TYPE (Ref # 92005A) | 92005-1109 | 2 |
| FITTING,T-TYPE (Ref # 92005C) | 92005-1125 | 2 |
| SCREW,6X16 (Ref # 92009) | 92009-1129 | 8 |
| SCREW (Ref # 92009A) | 92009-1262 | 3 |
| SCREW,5X10 (Ref # 92009B) | 92009-1365 | 1 |
| WASHER,6.1X11X0.8,POLYACETAL (Ref # 92022) | 92022-1199 | 6 |
| WASHER,PLAIN,STOP SPRING (Ref # 92022A) | 92022-1480 | 1 |
| CLAMP,FUEL TUBE (Ref # 92037) | 92037-1075 | 2 |
| CLAMP,TUBE (Ref # 92037A) | 92037-1142 | 4 |
| CLAMP,TUBE (Ref # 92037B) | 92037-1477 | 2 |
| RING-O (Ref # 92055) | 92055-1004 | 4 |

1996 Concours (Canada Only) PARTS LIST

Carburetor

| ITEM NAME | PART NUMBER | QUANTITY |
|---|-------------|----------|
| RING-O,FUEL FITTING (Ref # 92055A) | 92055-1223 | 8 |
| RING-O (Ref # 92055B) | 92055-1245 | 2 |
| TUBE,3.5X6.5X180 (Ref # 92059) | 92059-1140 | 2 |
| TUBE,5X9X200 (Ref # 92059A) | 92059-1173 | 1 |
| TUBE,7.3X12.5X260 (Ref # 92059B) | 92059-1492 | 1 |
| TUBE,6.5X9.5X260 (Ref # 92059C) | 92059-1598 | 2 |
| PLUG,12X25 (Ref # 92068) | 92068-006 | 3 |
| SPRING,THROTTLE STOP SCREW (Ref # 92081) | 92081-1617 | 1 |
| SPRING,THROTTLE ADJUST UPP (Ref # 92081A) | 92081-1620 | 3 |
| SPRING,THROTTLE ADJUST LWR (Ref # 92081B) | 92081-1621 | 3 |
| SPRING,THROTTLE ADJUST CNT (Ref # 92081C) | 92081-1622 | 2 |
| SPRING,STARTER LEVER (Ref # 92081D) | 92081-1762 | 1 |
| SPRING,AIR CUT VALVE (Ref # 92144) | 92144-1072 | 2 |