

1996 Vulcan 800 Classic PARTS DIAGRAM

Headlight(s)

F2710

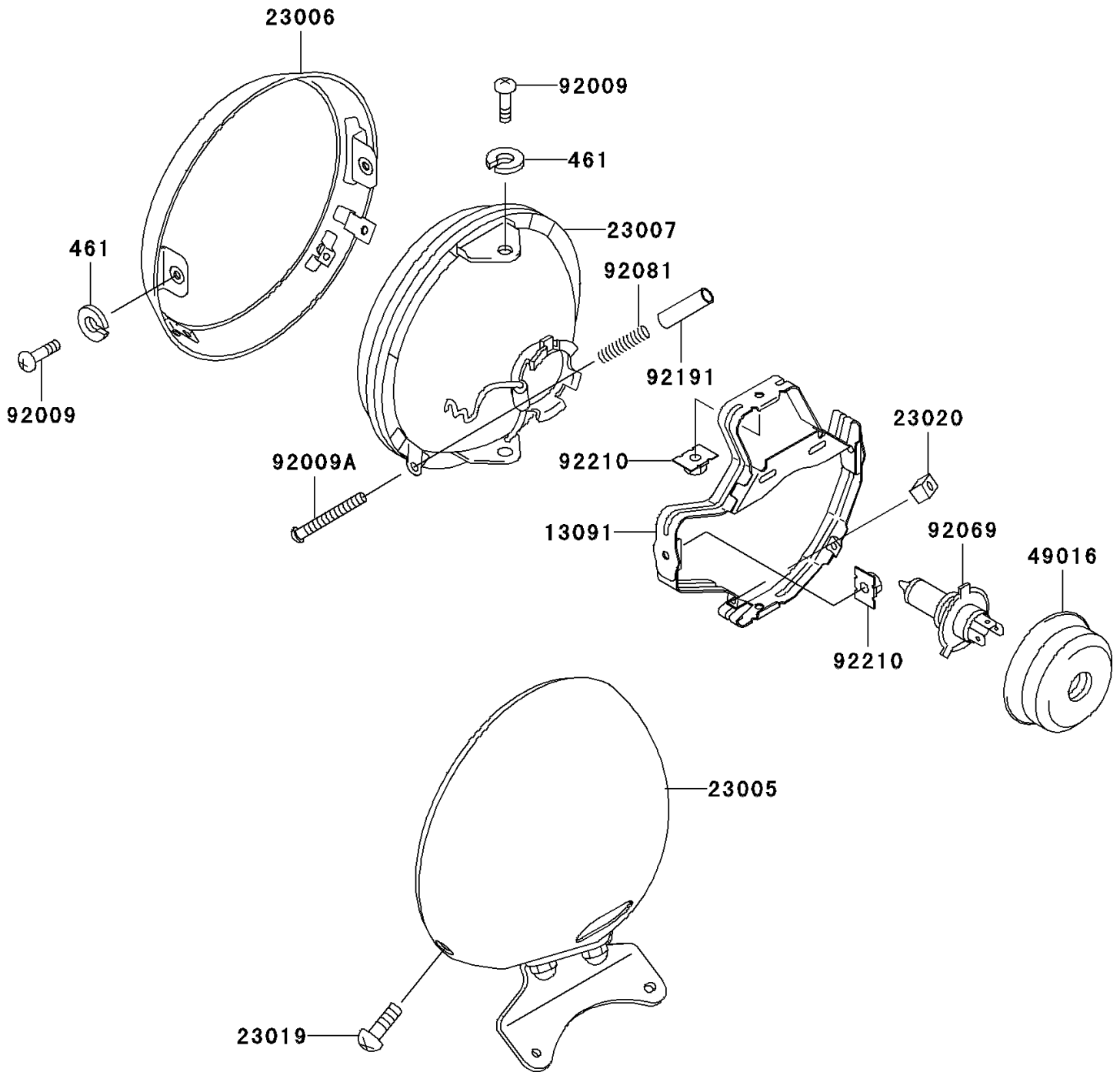

1996 Vulcan 800 Classic PARTS LIST

Headlight(s)

| ITEM NAME | PART NUMBER | QUANTITY |
|--|-------------|----------|
| WASHER-SPRING,5MM (Ref # 461) | 461F0500 | 4 |
| HOLDER,HEAD LAMP (Ref # 13091) | 13091-1948 | 1 |
| BODY-COMP-HEAD LAMP (Ref # 23005) | 23005-1152 | 1 |
| RIM-LAMP (Ref # 23006) | 23006-1071 | 1 |
| LENS-COMP,HEAD LAMP (Ref # 23007) | 23007-1338 | 1 |
| SCREW,SPECIAL,5X14 (Ref # 23019) | 23019-024 | 2 |
| NUT,4MM,FOCUS ADJUST (Ref # 23020) | 23020-018 | 2 |
| COVER-SEAL,HEAD LAMP (Ref # 49016) | 49016-1046 | 1 |
| SCREW,5X12 (Ref # 92009) | 92009-1296 | 4 |
| SCREW,FOCUS ADJUST,4X60 (Ref # 92009A) | 92009-1816 | 2 |
| BULB,12V 60/55W,H4 (Ref # 92069) | 92069-1002 | 1 |
| SPRING,HEAD LAMP LENS (Ref # 92081) | 92081-1103 | 2 |
| TUBE,3.5X4.5X19 (Ref # 92191) | 92191-1217 | 2 |
| NUT,SPECIAL,5MM (Ref # 92210) | 92210-1060 | 4 |