

# 1988 Vulcan 750 PARTS DIAGRAM

Front Bevel Gear

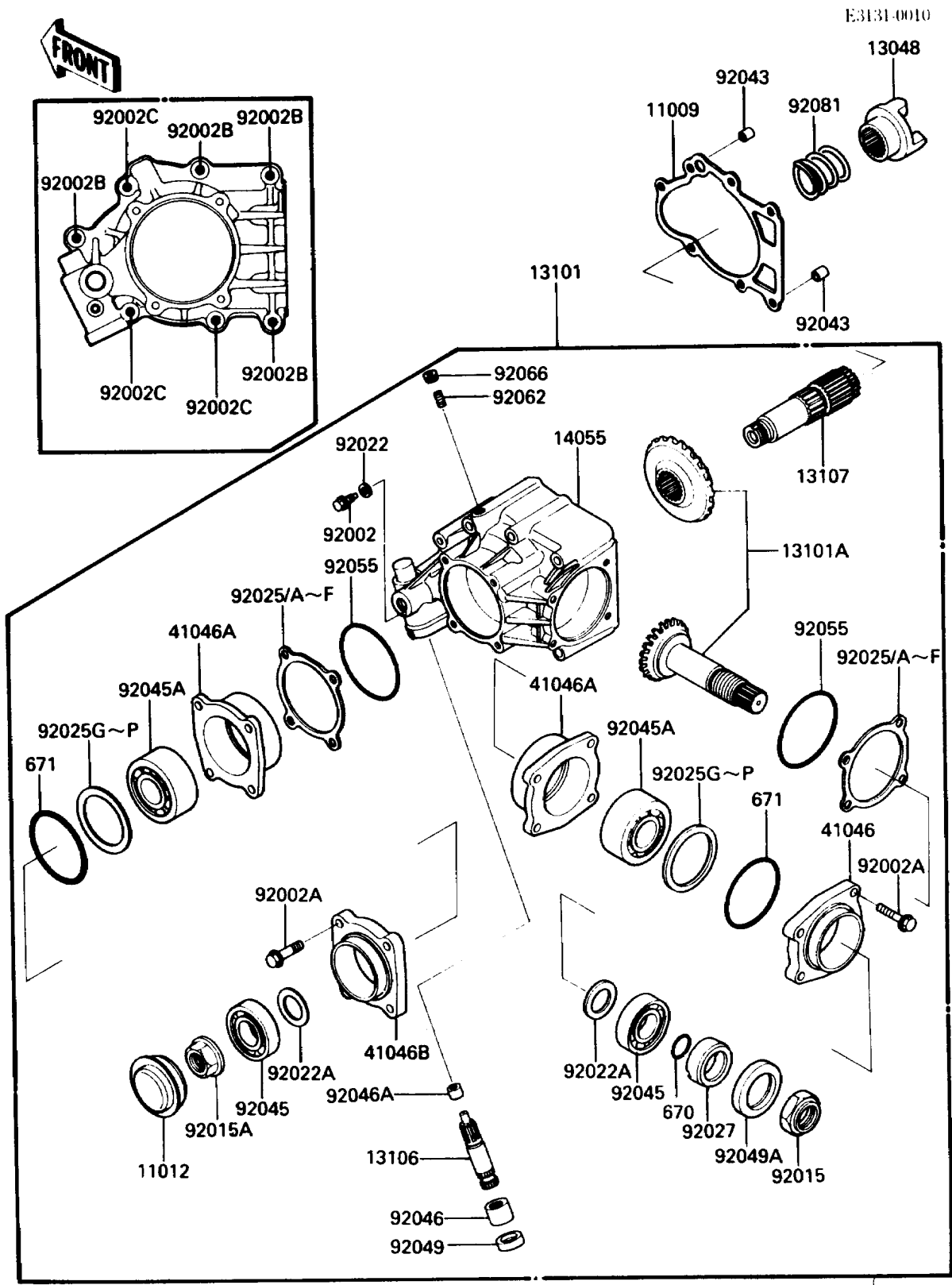

# 1988 Vulcan 750 PARTS LIST

## Front Bevel Gear

| ITEM NAME                               | PART NUMBER | QUANTITY |
|---|-------------|----------|
| GASKET,GEAR CASE (Ref # 11009)          | 11009-1510  | 1        |
| CAP,FRONT BEVEL (Ref # 11012)           | 11012-1672  | 1        |
| CAM-DAMPER (Ref # 13048)                | 13048-1058  | 1        |
| GEAR-ASSY,BEVEL,FR (Ref # 13101)        | 13101-1094  | 1        |
| GEAR-ASSY,BEVEL,FR (Ref # 13101A)       | 13101-5048  | 1        |
| SHAFT-CLUTCH RELEASE (Ref # 13106)      | 13106-1068  | 1        |
| SHAFT,BEVEL GEAR,FR (Ref # 13107)       | 13107-1166  | 1        |
| CASE-GEAR,BEVEL,FR (Ref # 14055)        | 14055-1068  | 1        |
| HOUSING-BEARING,BEVEL,FR (Ref # 41046)  | 41046-1072  | 1        |
| HOUSING-BEARING,BEVEL,FR (Ref # 41046A) | 41046-1073  | 2        |
| HOUSING-BEARING,BEVEL,FR (Ref # 41046B) | 41046-1090  | 1        |
| BOLT (Ref # 92002)                      | 92002-1357  | 1        |
| BOLT,6X32 (Ref # 92002A)                | 92002-1623  | 8        |
| BOLT,6X85 (Ref # 92002B)                | 92002-1624  | 4        |
| BOLT (Ref # 92002C)                     | 92002-1625  | 3        |
| NUT,25MM (Ref # 92015)                  | 92015-1480  | 1        |
| NUT (Ref # 92015A)                      | 92015-1543  | 1        |
| WASHER,6.1X12X1 (Ref # 92022)           | 92022-077   | 1        |
| WASHER (Ref # 92022A)                   | 92022-1719  | 2        |
| SHIM,T=0.10 (Ref # 92025)               | 92025-1258  | AR       |
| SHIM,T=0.15 (Ref # 92025A)              | 92025-1259  | AR       |
| SHIM,T=0.20 (Ref # 92025B)              | 92025-1260  | AR       |
| SHIM,T=0.30 (Ref # 92025C)              | 92025-1261  | AR       |
| SHIM,T=0.60 (Ref # 92025D)              | 92025-1262  | AR       |
| SHIM,T=0,90 (Ref # 92025E)              | 92025-1263  | AR       |
| SHIM,T=1.20 (Ref # 92025F)              | 92025-1264  | AR       |
| SHIM,52.5X61.5X0.12 (Ref # 92025G)      | 92025-1668  | AR       |
| SHIM,52.5X61.5X0.15 (Ref # 92025H)      | 92025-1669  | AR       |
| SHIM,52.5X61.5X0.18 (Ref # 92025I)      | 92025-1670  | AR       |

# 1988 Vulcan 750 PARTS LIST

## Front Bevel Gear

| ITEM NAME                              | PART NUMBER | QUANTITY |
|--|-------------|----------|
| SHIM,52.5X61.5X0.8 (Ref # 92025J)      | 92025-1671  | AR       |
| SHIM,52.5X61.5X0.9 (Ref # 92025K)      | 92025-1672  | AR       |
| SHIM,52.5X61.5X1.0 (Ref # 92025L)      | 92025-1673  | AR       |
| SHIM,52.5X61.5X1.1 (Ref # 92025M)      | 92025-1674  | AR       |
| SHIM,52.5X61.5X1.2 (Ref # 92025N)      | 92025-1675  | AR       |
| SHIM,52.5X61.5X1.3 (Ref # 92025O)      | 92025-1676  | AR       |
| SHIM,52.5X61.5X1.4 (Ref # 92025P)      | 92025-1677  | AR       |
| COLLAR (Ref # 92027)                   | 92027-1843  | 1        |
| PIN,DOWEL,6.3X8X14 (Ref # 92043)       | 92042-007   | 2        |
| BEARING-BALL,6205 (Ref # 92045)        | 92045-1115  | 2        |
| BEARING-BALL,5305SH2CD2 (Ref # 92045A) | 92045-1147  | 2        |
| BEARING-NEEDLE,7E-HK1412 (Ref # 92046) | 92046-037   | 1        |
| BEARING-NEEDLE,HK0709 (Ref # 92046A)   | 92046-1142  | 1        |
| SEAL-OIL,TC14244.8 (Ref # 92049)       | 92049-1037  | 1        |
| SEAL-OIL,TC35527 (Ref # 92049A)        | 92049-1038  | 1        |
| RING-O (Ref # 92055)                   | 92055-1306  | 2        |
| NOZZLE,BLACK (Ref # 92062)             | 92062-011   | 1        |
| PLUG,OIL LINE,1/8X7 (Ref # 92066)      | 92066-1227  | 1        |
| SPRING (Ref # 92081)                   | 92081-1552  | 1        |
| O RING,21MM (Ref # 670)                | 670B2021    | 1        |
| O RING,65MM (Ref # 671)                | 671B2565    | 2        |