

2003 Vulcan 1500 Drifter PARTS DIAGRAM

Muffler(s)

E1140

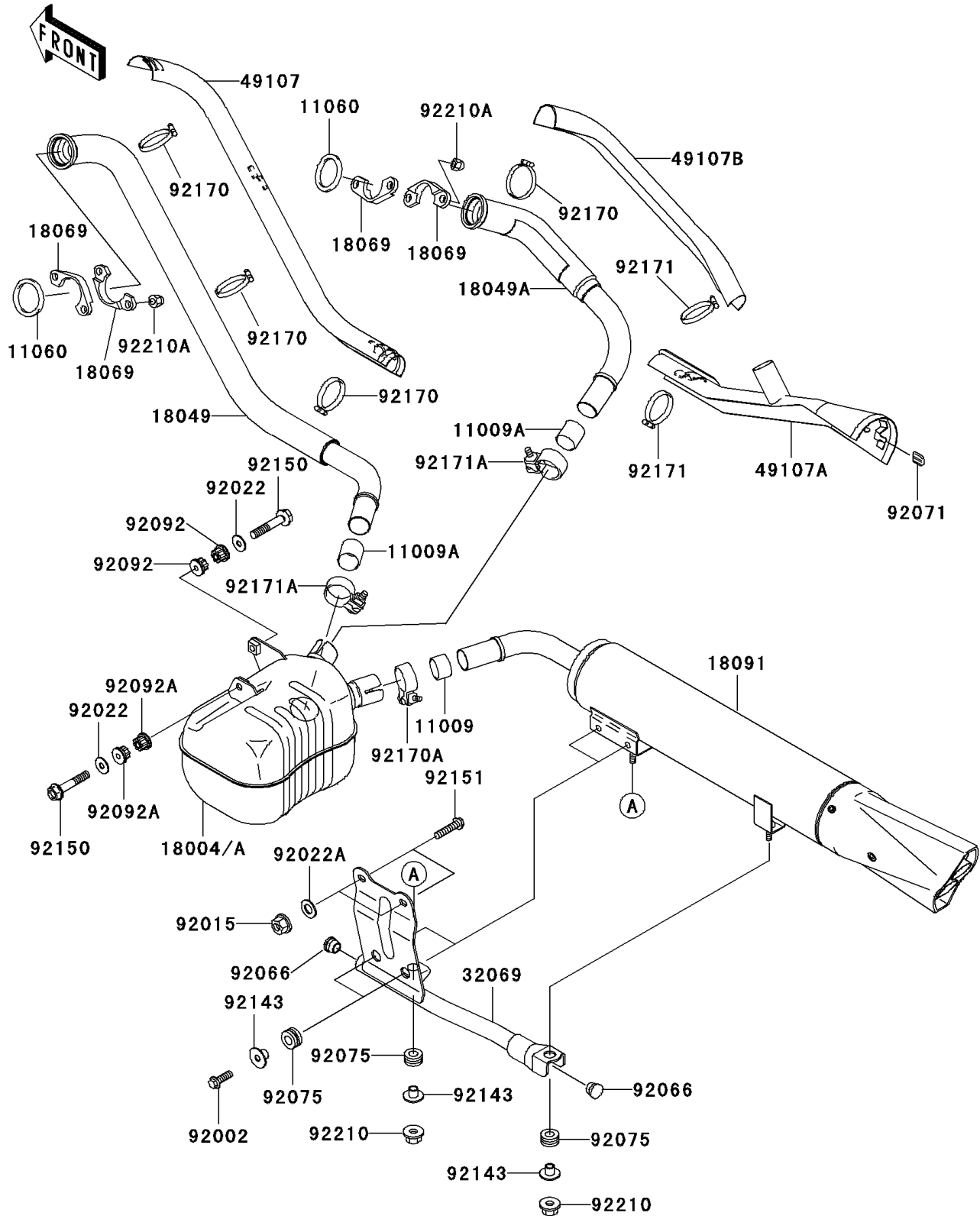

2003 Vulcan 1500 Drifter PARTS LIST

Muffler(s)

ITEM NAME	PART NUMBER	QUANTITY
GASKET,EXHAUST PIPE CONNECTING (Ref # 11009)	11009-1666	1
GASKET,EXHAUST PIPE CONNECTING (Ref # 11009A)	11009-1667	2
GASKET,EXHAUST PIPE (Ref # 11060)	11060-1119	2
PIPE-EXHAUST,FR (Ref # 18049)	18049-1906	1
PIPE-EXHAUST,RR (Ref # 18049A)	18049-1907	1
HOLDER-EXHAUST PIPE (Ref # 18069)	18069-1161	4
BODY-COMP-MUFFLER (Ref # 18091)	18091-0063	1
BRACKET-MUFFLER (Ref # 32069)	32069-1590	1
COVER-EXHAUST PIPE,FRONT (Ref # 49107)	49107-1169	1
COVER-EXHAUST PIPE,FR (Ref # 49107A)	49107-1170	1
COVER-EXHAUST PIPE,RR (Ref # 49107B)	49107-1171	1
BOLT,8X25 (Ref # 92002)	92002-1591	2
NUT,LOCK,FLANGED,8MM (Ref # 92015)	92015-1397	2
WASHER,10.5X30X2.3,BLACK (Ref # 92022)	92022-1302	2
WASHER,8.2X18X1.5 (Ref # 92022A)	92022-1964	2
PLUG (Ref # 92066)	92066-1520	2
GROMMET (Ref # 92071)	92071-1270	2
DAMPER (Ref # 92075)	92075-1898	4
BUSHING-RUBBER,MUFFLER (Ref # 92092)	92092-1013	2
BUSHING-RUBBER (Ref # 92092A)	92092-1081	2
COLLAR (Ref # 92143)	92143-1753	4
BOLT,10X55 (Ref # 92150)	92150-1749	2
BOLT,8X35 (Ref # 92151)	92151-1580	2
CLAMP (Ref # 92170)	92170-1964	4
CLAMP (Ref # 92170A)	92170-1994	1
CLAMP (Ref # 92171)	92171-0059	2
CLAMP (Ref # 92171A)	92171-1152	2
NUT,8MM (Ref # 92210)	92210-0076	2
NUT,CAP,8MM (Ref # 92210A)	92210-1132	4

2003 Vulcan 1500 Drifter PARTS LIST

Muffler(s)

ITEM NAME	PART NUMBER	QUANTITY
CHAMBER-PREMUFLER (Ref # 18004)	18004-1082	1
CHAMBER-PREMUFLER (Ref # 18004A)	18004-1084	1