

2008 Ultra 250X PARTS DIAGRAM

Pads

F3147

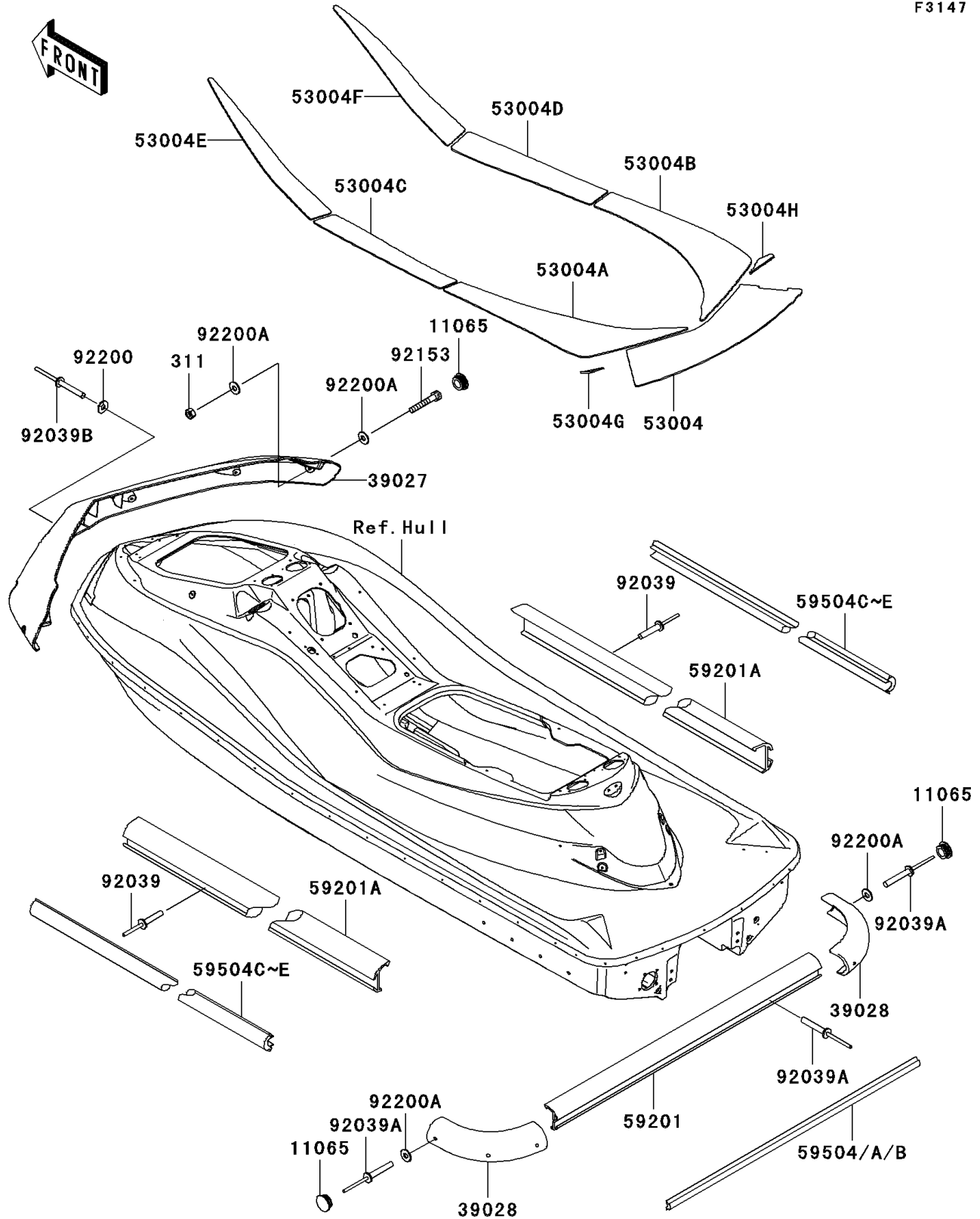

2008 Ultra 250X PARTS LIST

Pads

ITEM NAME	PART NUMBER	QUANTITY
CAP,F.BLACK (Ref # 11065)	11065-3707-6Z	8
BUMPER-FRONT,F.BLACK (Ref # 39027)	39027-3747-6Z	1
BUMPER-REAR,CORNER,F.BLACK (Ref # 39028)	39028-3752-6Z	2
MAT,FLOOR,RR (Ref # 53004)	53004-3886	1
MAT,FLOOR,MIDDLE,LH (Ref # 53004A)	53004-3888	1
MAT,FLOOR,MIDDLE,RH (Ref # 53004B)	53004-3889	1
MAT,FLOOR,FR,LH (Ref # 53004C)	53004-3890	1
MAT,FLOOR,FR,RH (Ref # 53004D)	53004-3891	1
MAT,FR,LH (Ref # 53004E)	53004-3892	1
MAT,FR,RH (Ref # 53004F)	53004-3893	1
MAT,RR,LH (Ref # 53004G)	53004-3897	1
MAT,RR,RH (Ref # 53004H)	53004-3898	1
BUMPER,RR,F.BLACK (Ref # 59201)	59201-3788-6Z	1
BUMPER,SIDE,F.BLACK (Ref # 59201A)	59201-3791-6Z	2
INSERT-BOAT FENDER,RR,F.SILVER (Ref # 59504)	59504-3732-AG	1
INSERT-BOAT FENDER,RR,S.RED (Ref # 59504B)	59504-3732-6B	1
INSERT-BOAT FENDER,SIDE,SILVER (Ref # 59504C)	59504-3733-AG	2
INSERT-BOAT FENDER,SIDE,S.RED (Ref # 59504E)	59504-3733-6B	2
RIVET (Ref # 92039)	92039-3771	28
RIVET (Ref # 92039A)	92039-3773	10
RIVET (Ref # 92039B)	92039-3781	4
BOLT,SOCKET,5X30 (Ref # 92153)	92153-3742	2
WASHER,5X12X1 (Ref # 92200)	92200-3795	4
WASHER,5X12X1 (Ref # 92200A)	92200-3796	10
NUT-HEX,5MM (Ref # 311)	311R0500	2