

2008 Ultra 250X PARTS DIAGRAM

Hull Front Fittings(B8F)

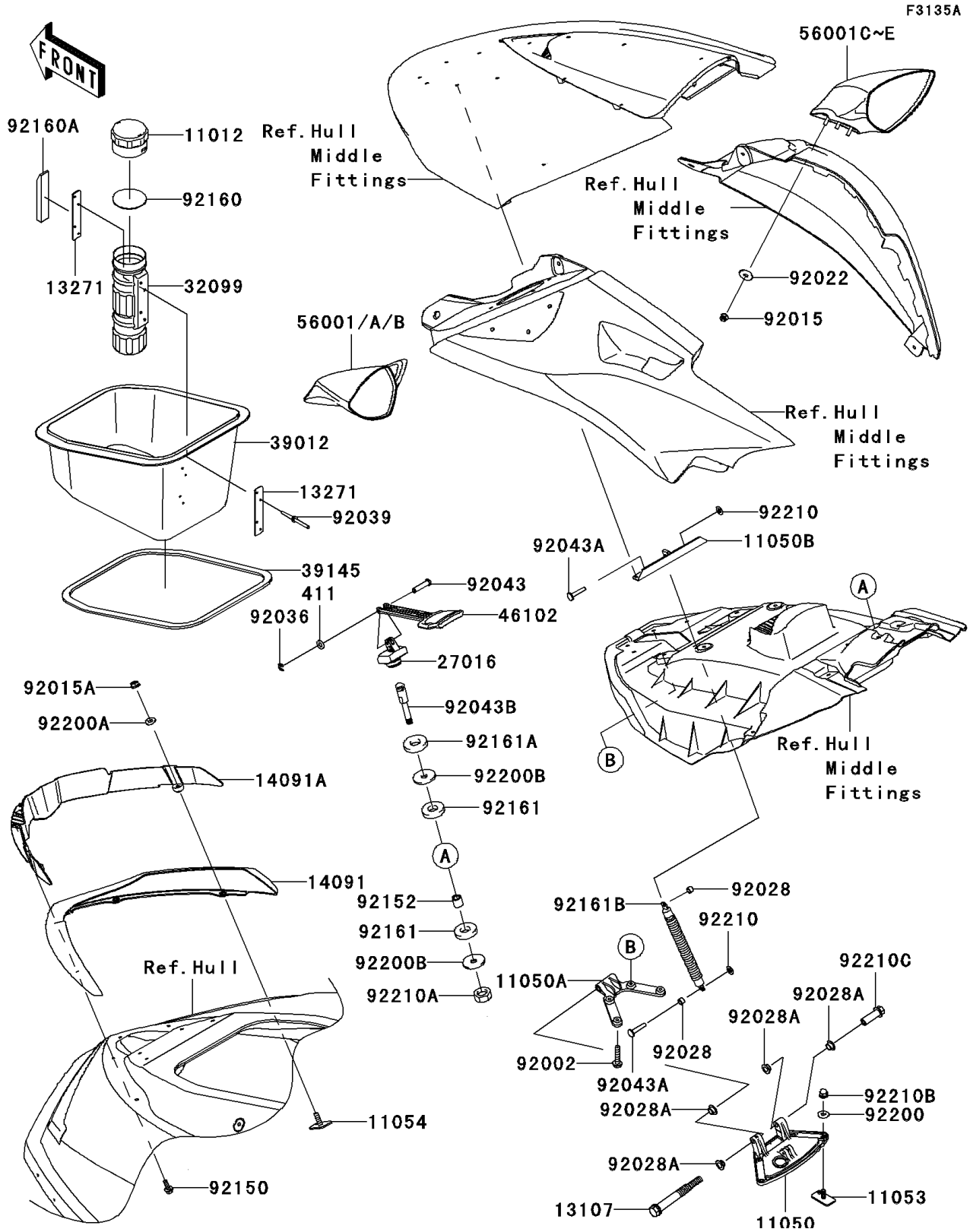

2008 Ultra 250X PARTS LIST

Hull Front Fittings(B8F)

ITEM NAME	PART NUMBER	QUANTITY
CAP,FIRE EXTINGUISHER (Ref # 11012)	11012-3766	1
BRACKET (Ref # 11050)	11050-3743	1
BRACKET (Ref # 11050A)	11050-3744	1
BRACKET (Ref # 11050B)	11050-3778	1
BRACKET (Ref # 11053)	11053-3776	4
BRACKET (Ref # 11054)	11054-3741	2
SHAFT,FRONT HINGE (Ref # 13107)	13107-3800	1
PLATE,FIRE EXTINGUISHER (Ref # 13271)	13271-3775	2
COVER,FR,TOP (Ref # 14091)	14091-3779	1
COVER,WATER PROTECT (Ref # 14091A)	14091-3788	1
LOCK-ASSY,HATCH (Ref # 27016)	27016-3759	1
CASE,FIRE EXTINGUISHER (Ref # 32099)	32099-3769	1
CASE-STORAGE (Ref # 39012)	39012-3744	1
TRIM-SEAL,L=1627 (Ref # 39145)	39145-3807	1
ROD,HATCH OPENER (Ref # 46102)	46102-3731	1
MIRROR-ASSY,LH,S.RED (Ref # 56001)	56001-3725-H1	1
MIRROR-ASSY,LH,BLUE (Ref # 56001A)	56001-3725-16F	1
MIRROR-ASSY,LH,L.GREEN (Ref # 56001B)	56001-3725-777	1
MIRROR-ASSY,RH,S.RED (Ref # 56001C)	56001-3726-H1	1
MIRROR-ASSY,RH,BLUE (Ref # 56001D)	56001-3726-16F	1
MIRROR-ASSY,RH,L.GREEN (Ref # 56001E)	56001-3726-777	1
BOLT,6X30 (Ref # 92002)	92002-3726	4
NUT,LOCK,6MM (Ref # 92015)	92015-3766	6
NUT,6MM (Ref # 92015A)	92015-3767	2
WASHER,6.5X20X1.5 (Ref # 92022)	92022-3710	6
BUSHING (Ref # 92028)	92028-3765	2
BUSHING (Ref # 92028A)	92028-3770	4
RING-SNAP (Ref # 92036)	92036-518	1
RIVET (Ref # 92039)	92039-3783	4

2008 Ultra 250X PARTS LIST

Hull Front Fittings(B8F)

ITEM NAME	PART NUMBER	QUANTITY
PIN,6X27.5 (Ref # 92043)	92043-3732	1
PIN,6X33 (Ref # 92043A)	92043-3748	2
PIN (Ref # 92043B)	92043-3760	1
BOLT,5X16 (Ref # 92150)	92150-3778	3
COLLAR,8.2X14X13.2 (Ref # 92152)	92152-3750	1
DAMPER (Ref # 92160)	92160-3814	1
DAMPER (Ref # 92160A)	92160-3821	1
DAMPER (Ref # 92161)	92161-3739	2
DAMPER (Ref # 92161A)	92161-3747	1
DAMPER,HATCH (Ref # 92161B)	92161-3778	1
WASHER,6.5X16X1.0 (Ref # 92200)	92200-3712	4
WASHER,6.5X14.5X1.5 (Ref # 92200A)	92200-3775	2
WASHER,8.5X32X2 (Ref # 92200B)	92200-3786	2
NUT,SPEED,6MM (Ref # 92210)	92210-3739	2
NUT,LOCK,8MM (Ref # 92210A)	92210-3742	1
NUT,CAP,6MM (Ref # 92210B)	92210-3785	4
NUT,8MM (Ref # 92210C)	92210-3795	1
WASHER-PLAIN,6MM (Ref # 411)	411S0600	1