

2023 KLX®300SM PARTS DIAGRAM

Transmission

E1361

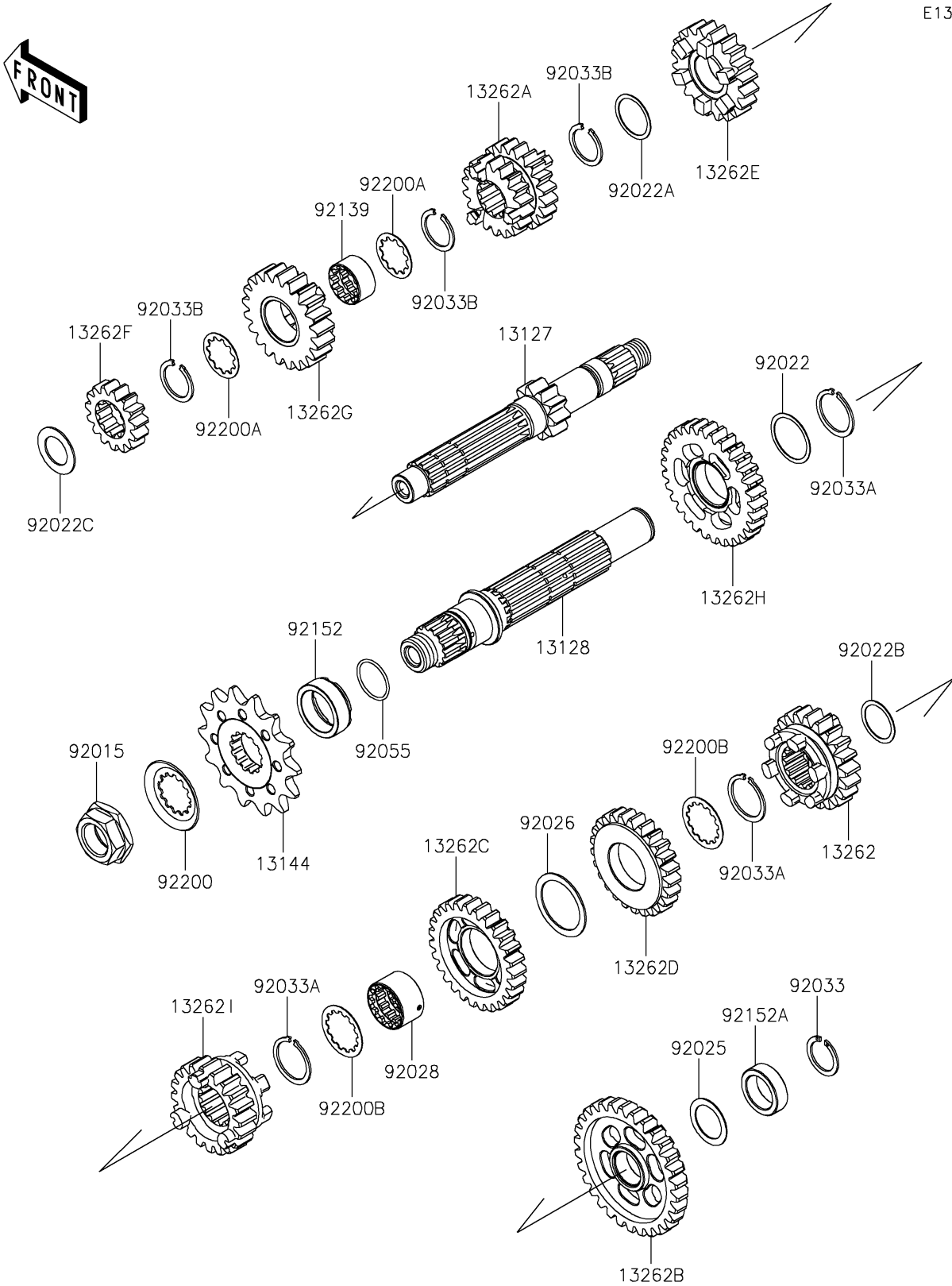

2023 KLX®300SM PARTS LIST

Transmission

| ITEM NAME | PART NUMBER | QUANTITY |
|--|-------------|----------|
| SHAFT-TRANSMISSION INPUT,10T (Ref # 13127) | 13127-0712 | 1 |
| SHAFT-TRANSMISSION OUTPUT (Ref # 13128) | 13128-0720 | 1 |
| SPROCKET-OUTPUT,14T (Ref # 13144) | 13144-0586 | 1 |
| GEAR,OUTPUT 5TH,21T (Ref # 13262) | 13262-0483 | 1 |
| GEAR,INPUT 3RD&4TH,18T&20T (Ref # 13262A) | 13262-0549 | 1 |
| GEAR,OUTPUT LOW,30T (Ref # 13262B) | 13262-0597 | 1 |
| GEAR,OUTPUT 3RD,27T (Ref # 13262C) | 13262-0598 | 1 |
| GEAR,OUTPUT 4TH,25T (Ref # 13262D) | 13262-0599 | 1 |
| GEAR,INPUT 5TH,20T (Ref # 13262E) | 13262-0600 | 1 |
| GEAR,INPUT 2ND,15T (Ref # 13262F) | 13262-1499 | 1 |
| GEAR,INPUT TOP,21T (Ref # 13262G) | 13262-1500 | 1 |
| GEAR,OUTPUT 2ND,30T (Ref # 13262H) | 13262-1501 | 1 |
| GEAR,OUTPUT TOP,20T (Ref # 13262I) | 13262-1502 | 1 |
| NUT,20MM (Ref # 92015) | 92015-1963 | 1 |
| WASHER,25.3X30X0.5 (Ref # 92022) | 92022-159 | 1 |
| WASHER,22.3X27X0.5 (Ref # 92022A) | 92022-198 | 1 |
| WASHER,20.5X25.5X0.5 (Ref # 92022B) | 92022-252 | 1 |
| WASHER,17.3X28X1 (Ref # 92022C) | 92022-255 | 1 |
| SHIM,T=0.7 (Ref # 92025) | 92025-1451 | 1 |
| SPACER,30X38X1.0 (Ref # 92026) | 92026-079 | 1 |
| BUSHING,OUTPUT 3RD&4TH GEAR (Ref # 92028) | 92028-1822 | 1 |
| RING-SNAP,18MM (Ref # 92033) | 92033-029 | 1 |
| RING-SNAP,25MM (Ref # 92033A) | 92033-1172 | 3 |
| RING-SNAP (Ref # 92033B) | 92033-1293 | 3 |
| RING-O,21.5X1.5 (Ref # 92055) | 92055-0196 | 1 |
| BUSHING,INPUT TOP GEAR (Ref # 92139) | 92139-0988 | 1 |
| COLLAR (Ref # 92152) | 92152-1350 | 1 |
| COLLAR,20X28X8.5 (Ref # 92152A) | 92152-1357 | 1 |
| WASHER (Ref # 92200) | 92200-0851 | 1 |

2023 KLX®300SM PARTS LIST

Transmission

| ITEM NAME | PART NUMBER | QUANTITY |
|------------------------------|-------------|----------|
| WASHER,INPUT (Ref # 92200A) | 92200-1370 | 2 |
| WASHER,OUTPUT (Ref # 92200B) | 92200-1371 | 2 |