

# 1997 Vulcan 1500 Classic PARTS DIAGRAM

Muffler(s)

E1140

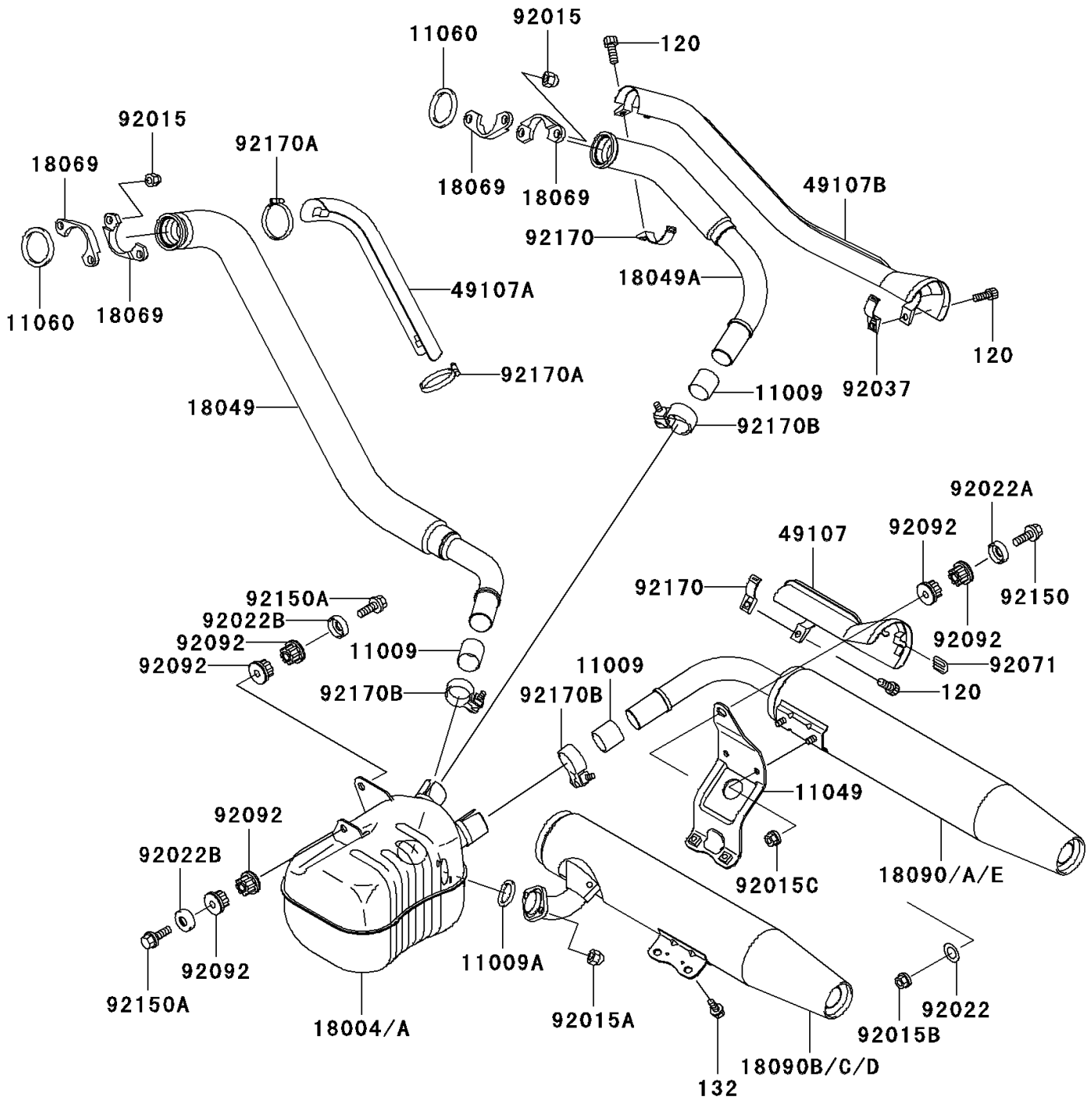

# 1997 Vulcan 1500 Classic PARTS LIST

## Muffler(s)

ITEM NAME	PART NUMBER	QUANTITY
GASKET,MUFFLER CONNECTING (Ref # 11009)	11009-1865	3
GASKET,EXHAUST HOLDER (Ref # 11009A)	11009-1894	1
BRACKET,MUFFLER (Ref # 11049)	11049-1540	1
GASKET,EXHAUST PIPE (Ref # 11060)	11060-1119	2
CHAMBER-PREMUFLER (Ref # 18004A)	18004-1080	1
PIPE-EXHAUST,FR (Ref # 18049)	18049-1887	1
PIPE-EXHAUST,RR (Ref # 18049A)	18049-1888	1
HOLDER-EXHAUST PIPE (Ref # 18069)	18069-1138	4
BODY-COMP-MUFFLER,FR,LWR (Ref # 18090D)	18090-1603	1
BODY-COMP-MUFFLER,RR,UPP (Ref # 18090E)	18090-1604	1
COVER-EXHAUST PIPE,FR (Ref # 49107)	49107-1103	1
COVER-EXHAUST PIPE (Ref # 49107A)	49107-1115	1
COVER-EXHAUST PIPE,RR (Ref # 49107B)	49107-1156	1
NUT,CAP,8MM (Ref # 92015)	92015-1371	4
NUT,8MM (Ref # 92015A)	92015-1402	2
NUT,10MM (Ref # 92015B)	92015-1649	1
NUT,8MM (Ref # 92015C)	92015-1936	2
WASHER,10.5X26X2.3 (Ref # 92022)	92022-044	1
WASHER,CUP TYPE (Ref # 92022A)	92022-1270	1
WASHER,10.5X30X2.3,BLACK (Ref # 92022B)	92022-1302	2
CLAMP,EXHAUST PIPE COVER (Ref # 92037)	92037-1613	1
GROMMET (Ref # 92071)	92071-1226	2
BUSHING-RUBBER,MUFFLER (Ref # 92092)	92092-1013	6
BOLT,FLANGED,10X57 (Ref # 92150)	92150-1227	1
BOLT,10X55 (Ref # 92150A)	92150-1749	2
CLAMP (Ref # 92170)	92170-1645	2
CLAMP (Ref # 92170A)	92170-1710	2
CLAMP (Ref # 92170B)	92170-1928	3
BOLT-SOCKET (Ref # 120)	120Z0620	3

# 1997 Vulcan 1500 Classic PARTS LIST

Muffler(s)

ITEM NAME	PART NUMBER	QUANTITY
BOLT-FLANGED-SMALL (Ref # 132)	132E0814	2