

# 1994 Vulcan 88 PARTS DIAGRAM

Clutch

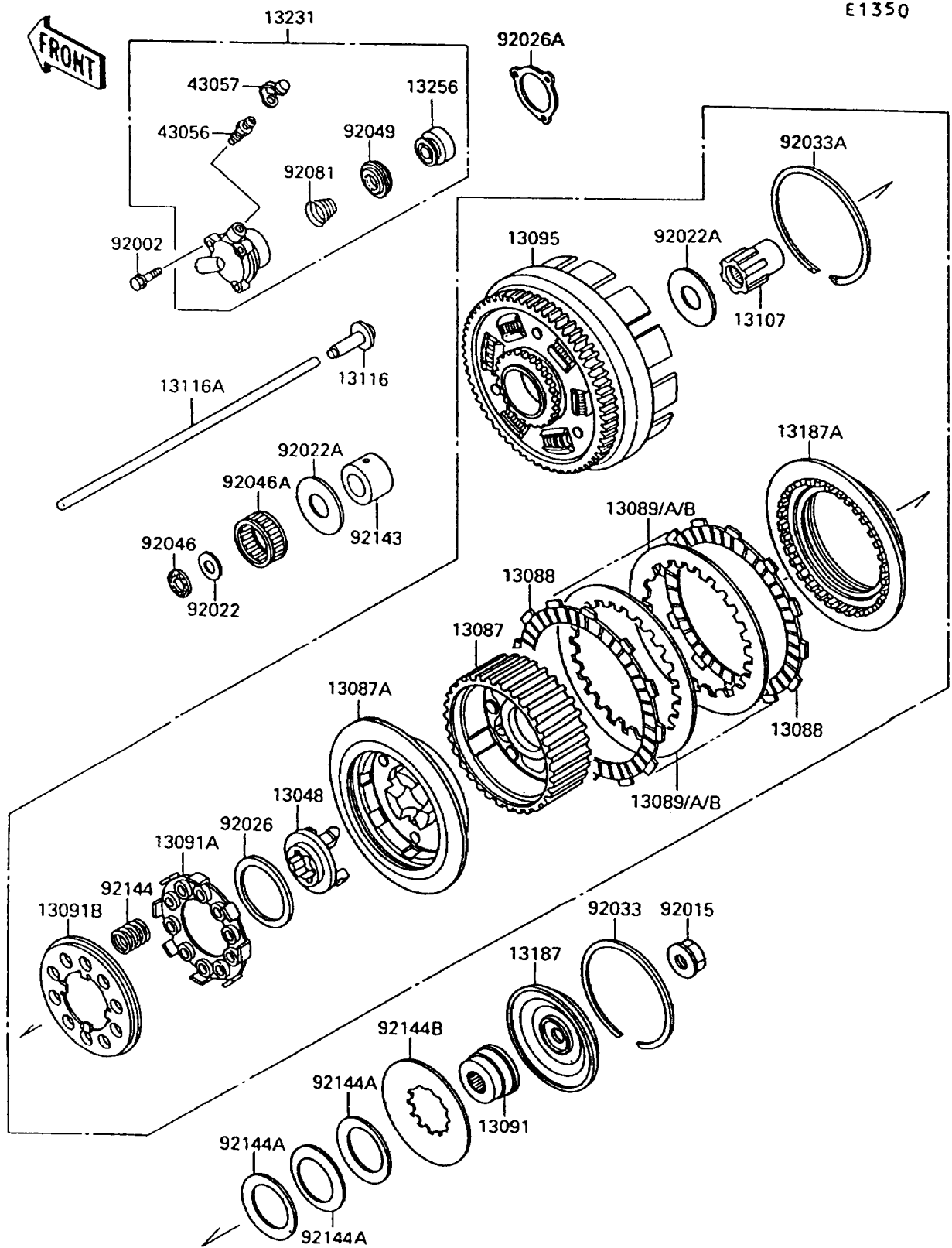

# 1994 Vulcan 88 PARTS LIST

## Clutch

| ITEM NAME                             | PART NUMBER | QUANTITY |
|---------------------------------------|-------------|----------|
| CAM-DAMPER (Ref # 13048)              | 13048-1007  | 1        |
| HUB-CLUTCH,OUTER (Ref # 13087)        | 13087-1103  | 1        |
| HUB-CLUTCH,INNER (Ref # 13087A)       | 13087-1110  | 1        |
| PLATE-FRICTION (Ref # 13088)          | 13088-1018  | 8        |
| PLATE-CLUTCH,T=2.0 (Ref # 13089)      | 13089-1075  | AR       |
| PLATE-CLUTCH,T=1.6 (Ref # 13089A)     | 13089-1080  | AR       |
| PLATE-CLUTCH,T=2.3 (Ref # 13089B)     | 13089-1081  | AR       |
| HOLDER,CLUTCH SPRING (Ref # 13091)    | 13091-1494  | 1        |
| HOLDER,DAMPER SPRING (Ref # 13091A)   | 13091-1495  | 1        |
| HOLDER,DAMPER SPRING (Ref # 13091B)   | 13091-1496  | 1        |
| HOUSING-COMP-CLUTCH (Ref # 13095)     | 13095-1168  | 1        |
| SHAFT,CLUTCH CAM DAMPER (Ref # 13107) | 13107-1237  | 1        |
| ROD-PUSH,CLUTCH (Ref # 13116)         | 13116-1102  | 1        |
| ROD-PUSH (Ref # 13116A)               | 13116-1132  | 1        |
| PLATE-CLUTCH OPERATING (Ref # 13187)  | 13187-1063  | 1        |
| PLATE-CLUTCH OPERATING (Ref # 13187A) | 13187-1066  | 1        |
| RELEASE-ASSY-CLUTCH (Ref # 13231)     | 13231-1064  | 1        |
| PISTON (Ref # 13256)                  | 13256-1052  | 1        |
| BREATHER-BRAKE (Ref # 43056)          | 43056-1052  | 1        |
| CAP-BREATHER (Ref # 43057)            | 43057-1001  | 1        |
| BOLT,6X25 (Ref # 92002)               | 92002-1612  | 3        |
| NUT,20MM (Ref # 92015)                | 92015-1461  | 1        |
| WASHER,15.1X29X1.0 (Ref # 92022)      | 92022-1463  | 1        |
| WASHER,25.3X56X2.0 (Ref # 92022A)     | 92022-1857  | 2        |
| SPACER,59X70X3.5 (Ref # 92026)        | 92026-1043  | 1        |
| SPACER,CLUTCH RELEASE (Ref # 92026A)  | 92026-1263  | 1        |
| RING-SNAP (Ref # 92033)               | 92033-1238  | 1        |
| RING-SNAP (Ref # 92033A)              | 92033-1239  | 1        |
| BEARING-NEEDLE,AXK1102 (Ref # 92046)  | 92046-1052  | 1        |

## 1994 Vulcan 88 PARTS LIST

### Clutch

| ITEM NAME                           | PART NUMBER | QUANTITY |
|-------------------------------------|-------------|----------|
| BEARING-NEEDLE (Ref # 92046A)       | 92046-1175  | 1        |
| SEAL-OIL,PISTON (Ref # 92049)       | 92049-1165  | 1        |
| SPRING,CLUTCH RELEASE (Ref # 92081) | 92081-1644  | 1        |
| COLLAR,INPUT SHAFT (Ref # 92143)    | 92143-1076  | 1        |
| SPRING,DAMPER (Ref # 92144)         | 92144-1187  | 10       |
| SPRING,LIMITER (Ref # 92144A)       | 92144-1188  | 3        |
| SPRING,CLUTCH (Ref # 92144B)        | 92144-1295  | 1        |