

1987 Vulcan 88 PARTS DIAGRAM

Carburetor Parts

E1612-0118

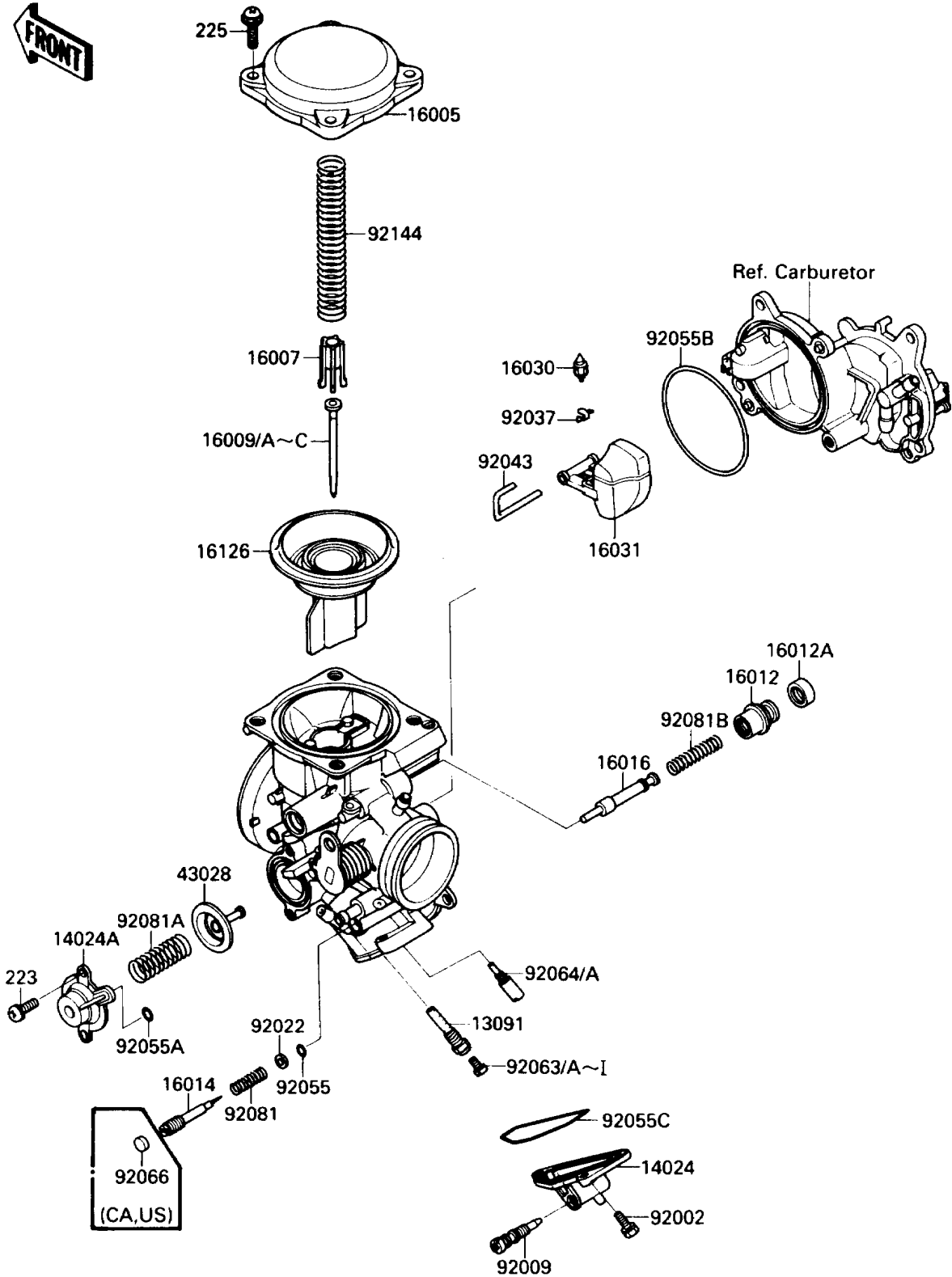

1987 Vulcan 88 PARTS LIST

Carburetor Parts

| ITEM NAME | PART NUMBER | QUANTITY |
|---------------------------------------|-------------|----------|
| HOLDER,NEEDLE JET (Ref # 13091) | 13091-1513 | 2 |
| COVER,DRAIN (Ref # 14024) | 14024-1608 | 2 |
| COVER,AIR CUT VALVE (Ref # 14024A) | 14025-1903 | 2 |
| TOP-CHAMBER,MIXING (Ref # 16005) | 16005-1054 | 2 |
| SEAT-SPRING,VALVE (Ref # 16007) | 16007-1117 | 2 |
| NEEDLE-JET,RR,N53T (Ref # 16009) | 16009-1361 | 1 |
| NEEDLE-JET,FR,N53S (Ref # 16009A) | 16009-1362 | 1 |
| NEEDLE-JET,RR,N53V (Ref # 16009B) | 16009-1363 | 1 |
| NEEDLE-JET,FR,N53U (Ref # 16009C) | 16009-1364 | 1 |
| CAP-STARTER PLUNGER (Ref # 16012) | 16012-1051 | 2 |
| CAP-STARTER PLUNGER (Ref # 16012A) | 16012-1052 | 2 |
| SCREW-PILOT AIR (Ref # 16014) | 16014-1054 | 2 |
| PLUNGER (Ref # 16016) | 16016-1071 | 2 |
| VALVE-FLOAT (Ref # 16030) | 16030-1007 | 2 |
| FLOAT (Ref # 16031) | 16031-1066 | 2 |
| VALVE,VACUUM (Ref # 16126) | 16126-1203 | 2 |
| DIAPHRAGM,AIR CUT VALVE (Ref # 43028) | 43028-1053 | 2 |
| BOLT,4X14 (Ref # 92002) | 92002-1761 | 4 |
| SCREW,DRAIN (Ref # 92009) | 92009-1434 | 2 |
| WASHER,PLAIN (Ref # 92022) | 92022-1003 | 2 |
| CLAMP,FLOAT VALVE (Ref # 92037) | 16044-007 | 2 |
| PIN,FLOAT (Ref # 92043) | 92043-1285 | 2 |
| RING-O,PILOT ADJUST (Ref # 92055) | 92055-1002 | 2 |
| RING-O (Ref # 92055A) | 92055-1245 | 2 |
| RING-O (Ref # 92055B) | 92055-1291 | 2 |
| RING-O,DRAIN COVER (Ref # 92055C) | 92055-1400 | 2 |
| JET-MAIN,#118 (Ref # 92063) | 92063-1071 | 2 |
| JET-MAIN,#118 (Ref # 92063A) | 92063-1071 | 2 |
| JET-MAIN,#120 (Ref # 92063B) | 92063-1072 | 2 |

1987 Vulcan 88 PARTS LIST

Carburetor Parts

| ITEM NAME | PART NUMBER | QUANTITY |
|--|-------------|----------|
| JET-MAIN,2ND,#122 (Ref # 92063C) | 92063-1073 | 2 |
| JET-MAIN,#110 (Ref # 92063D) | 92063-1114 | 2 |
| JET-MAIN,#108 (Ref # 92063E) | 92063-1116 | 2 |
| JET-MAIN,#112 (Ref # 92063F) | 92063-1117 | 1 |
| JET-MAIN,#112 (Ref # 92063G) | 92063-1117 | 2 |
| JET-MAIN,#115 (Ref # 92063H) | 92063-1118 | 1 |
| JET-MAIN,#115 (Ref # 92063I) | 92063-1118 | 2 |
| JET-PILOT,#42 (Ref # 92064) | 92064-1135 | 2 |
| JET-PILOT,#40 (Ref # 92064A) | 92064-1136 | 2 |
| PLUG,PILOT AIR SCREW,6.9X2 (Ref # 92066) | 92066-1051 | 2 |
| SPRING,PILOT ADJUST SCREW (Ref # 92081) | 92081-1002 | 2 |
| SPRING,AIR CUT VALVE (Ref # 92081A) | 92081-1719 | 2 |
| SPRING,STARTER PLUNGER (Ref # 92081B) | 92081-1761 | 2 |
| SPRING,VACUUM VALVE (Ref # 92144) | 92144-1219 | 2 |
| SCREW-PAN-WS-CROS (Ref # 223) | 223D0408 | 4 |
| SCREW-PAN-WSP-CROS (Ref # 225) | 225C0418 | 6 |