

1999 KX80 PARTS DIAGRAM

Front Fork

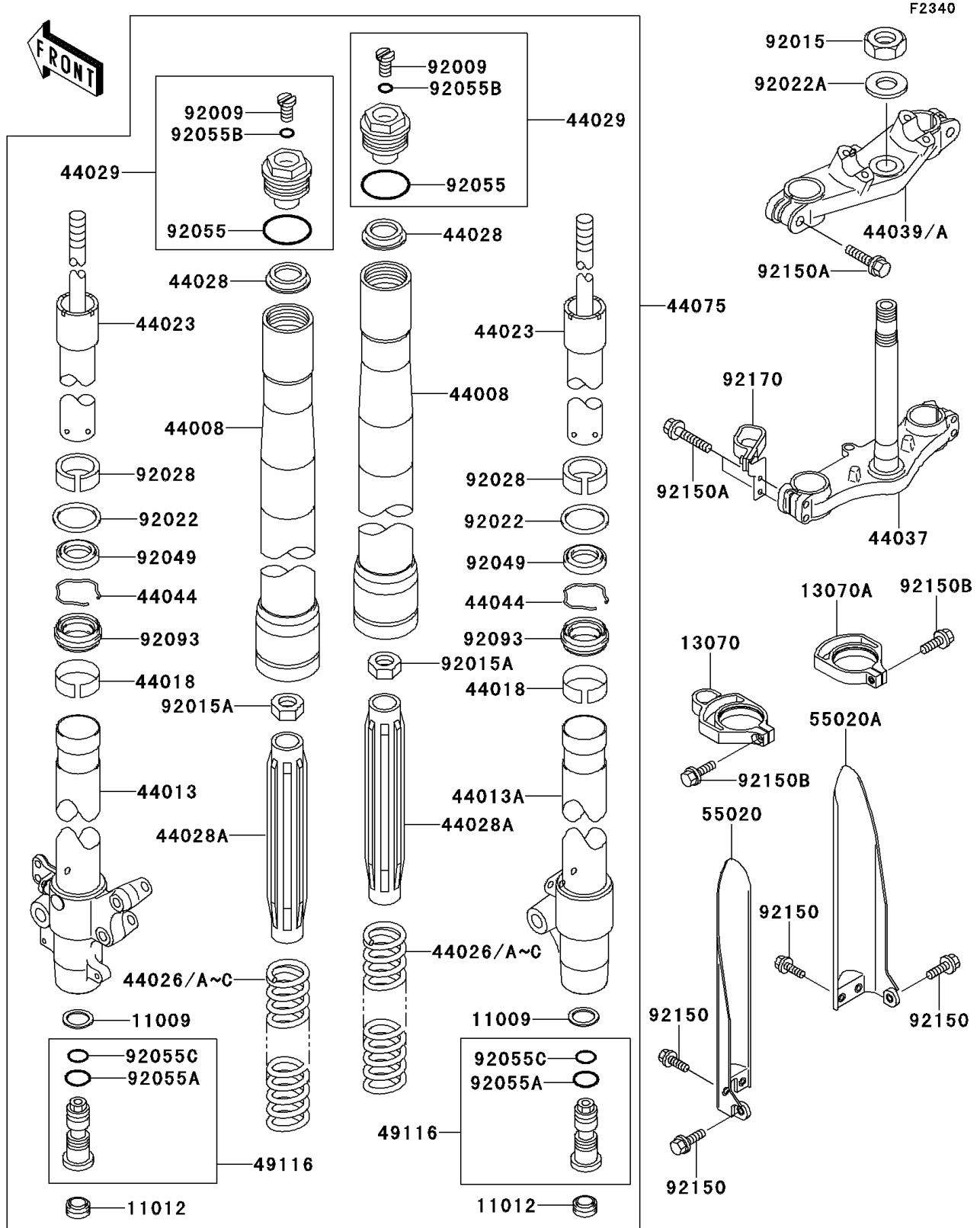

1999 KX80 PARTS LIST

Front Fork

| ITEM NAME | PART NUMBER | QUANTITY |
|---|---------------|----------|
| GASKET,FORK CYLINDER BOLT (Ref # 11009) | 11009-1592 | 2 |
| CAP (Ref # 11012) | 11012-1692 | 2 |
| GUIDE,PROTECTOR,LH,WHITE (Ref # 13070) | 13070-1310-RZ | 1 |
| GUIDE,PROTECTOR,RH,WHITE (Ref # 13070A) | 13070-1311-RZ | 1 |
| PIPE-FORK OUTER,A.N.GOLD (Ref # 44008) | 44008-1041-14 | 2 |
| PIPE-FORK INNER,LH (Ref # 44013) | 44013-1441 | 1 |
| PIPE-FORK INNER,RH (Ref # 44013A) | 44013-1442 | 1 |
| PISTON-FORK (Ref # 44018) | 44018-1058 | 2 |
| CYLINDER-SET-FORK (Ref # 44023) | 44023-1119 | 2 |
| SPRING-FRONT FORK,K=0.30 (Ref # 44026) | 44026-1635 | 2 |
| SPRING-FRONT FORK,K=0.27 (Ref # 44026A) | 44026-1671 | 2 |
| SPRING-FRONT FORK,K=0.28 (Ref # 44026B) | 44026-1672 | 2 |
| SPRING-FRONT FORK,K=0.29 (Ref # 44026C) | 44026-1673 | 2 |
| GUIDE-FORK SPRING (Ref # 44028) | 44028-1085 | 2 |
| GUIDE-FORK SPRING (Ref # 44028A) | 44028-1090 | 2 |
| SEAT-FORK SPRING (Ref # 44029) | 44029-1152 | 2 |
| HOLDER-FORK UNDER (Ref # 44037) | 44037-1360 | 1 |
| HOLDER-FORK UPPER (Ref # 44039) | 44039-1274 | 1 |
| RING-SNAP (Ref # 44044) | 44044-015 | 2 |
| DAMPER-SET-FORK,A.N.GOLD (Ref # 44075) | 44075-1054-14 | 1 |
| VALVE-ASSY,FORK (Ref # 49116) | 49116-1153 | 2 |
| GUARD,FORK,LH,WHITE (Ref # 55020) | 55020-1611-RZ | 1 |
| GUARD,FORK,RH,WHITE (Ref # 55020A) | 55020-1612-RZ | 1 |
| SCREW (Ref # 92009) | 92009-1568 | 2 |
| NUT,STEERING STEM,22MM (Ref # 92015) | 92015-1653 | 1 |
| NUT (Ref # 92015A) | 92015-1839 | 2 |
| WASHER,FRONT FORK (Ref # 92022) | 92022-1275 | 2 |
| WASHER,STEERING STEM (Ref # 92022A) | 92022-1873 | 1 |
| BUSHING (Ref # 92028) | 92028-1656 | 2 |

1999 KX80 PARTS LIST

Front Fork

| ITEM NAME | PART NUMBER | QUANTITY |
|--|-------------|----------|
| SEAL-OIL,FORK OUTER TUBE (Ref # 92049) | 92049-1394 | 2 |
| RING-O (Ref # 92055) | 92055-1123 | 2 |
| RING-O (Ref # 92055A) | 92055-1156 | 2 |
| RING-O (Ref # 92055B) | 92055-1441 | 2 |
| RING-O,FORK VALVE (Ref # 92055C) | 92055-1502 | 2 |
| SEAL,FORK OUTER TUBE (Ref # 92093) | 92093-1426 | 2 |
| BOLT,6X14 (Ref # 92150) | 92150-1340 | 6 |
| BOLT,FLANGED,8X35 (Ref # 92150A) | 92150-1499 | 6 |
| BOLT,5X16 (Ref # 92150B) | 92150-1802 | 2 |
| CLAMP (Ref # 92170) | 92170-1810 | 1 |