

## 2008 Vulcan® 1600 Nomad™ PARTS DIAGRAM

Footrests

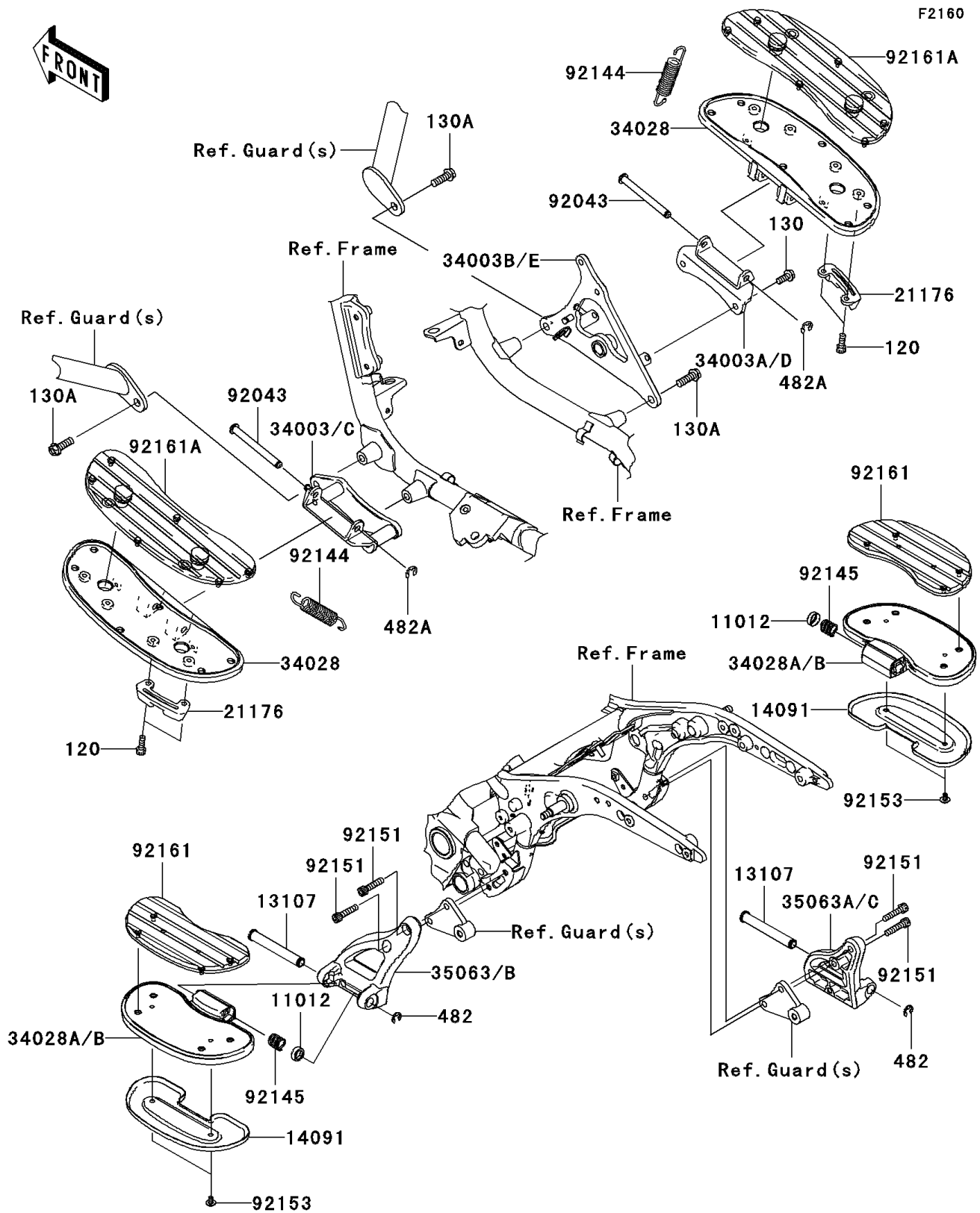

## 2008 Vulcan® 1600 Nomad™ PARTS LIST

### Footrests

ITEM NAME	PART NUMBER	QUANTITY
BOLT-SOCKET,6X16 (Ref # 120)	120S0616	1
BOLT-FLANGED,8X20 (Ref # 130)	130J0820	1
BOLT-FLANGED,10X30 (Ref # 130A)	130J1030	1
CIRCLIP-TYPE-E (Ref # 482)	482L0200	1
CIRCLIP-TYPE-E,8MM (Ref # 482A)	482L8000	1
CAP (Ref # 11012)	11012-1498	1
SHAFT,REAR STEP (Ref # 13107)	13107-0087	1
COVER,REAR STEP (Ref # 14091)	14091-0229	1
SENSOR,BANK (Ref # 21176)	21176-0021	1
HOLDER-STEP,FR,LH (Ref # 34003C)	34003-0061	1
HOLDER-STEP,FR,RH (Ref # 34003D)	34003-0062	1
HOLDER-STEP,FR,RH (Ref # 34003E)	34003-0063	1
STEP,FR (Ref # 34028)	34028-0011	1
STEP,RR (Ref # 34028B)	34028-0053	1
STAY,REAR STEP,LH (Ref # 35063B)	35063-0473	1
STAY,REAR STEP,RH (Ref # 35063C)	35063-0474	1
PIN,10X98.5 (Ref # 92043)	92043-1707	1
SPRING (Ref # 92144)	92144-1266	1
SPRING,REAR STEP (Ref # 92145)	92145-1130	1
BOLT,SOCKET,8X35 (Ref # 92151)	92151-1535	1
BOLT,SOCKET,6X10 (Ref # 92153)	92153-1096	1
DAMPER,REAR STEP (Ref # 92161)	92161-0145	1
DAMPER,FRONT STEP (Ref # 92161A)	92161-1325	1