

2008 Vulcan® 1600 Nomad™ PARTS DIAGRAM

Transmission

E1361

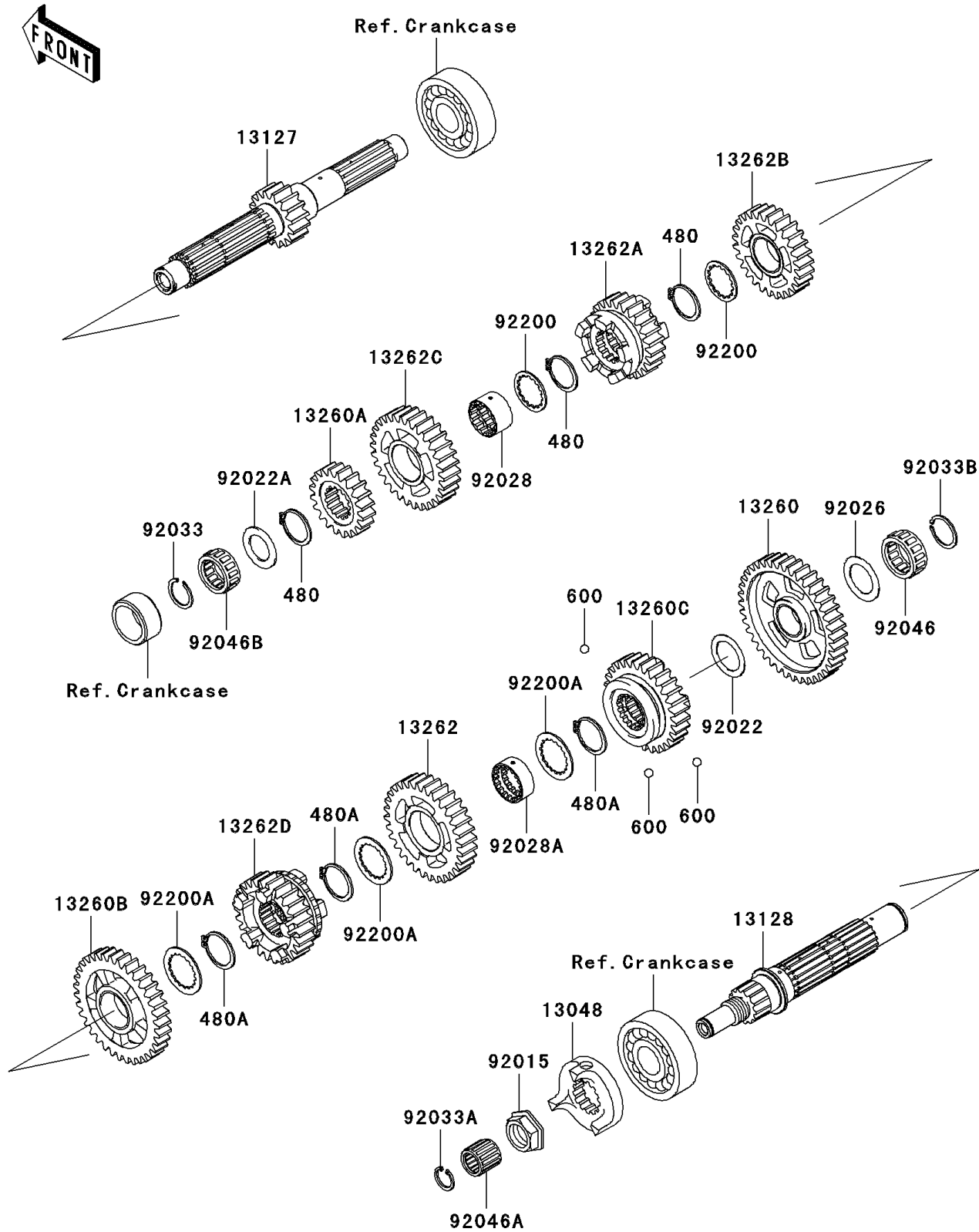

2008 Vulcan® 1600 Nomad™ PARTS LIST

Transmission

ITEM NAME	PART NUMBER	QUANTITY
CIRCLIP-TYPE-C,28MM (Ref # 480)	480J2800	1
CIRCLIP (Ref # 480A)	480J2900	1
BALL-STEEL,5/32" (Ref # 600)	600A0500	1
CAM-DAMPER (Ref # 13048)	13048-1086	1
SHAFT-TRANSMISSION INPUT (Ref # 13127)	13127-1288	1
SHAFT-TRANSMISSION OUTPUT (Ref # 13128)	13128-0002	1
GEAR,OUTPUT LOW,40T (Ref # 13260)	13260-1910	1
GEAR,INPUT 2ND,22T (Ref # 13260A)	13260-1914	1
GEAR,OUTPUT 2ND,35T (Ref # 13260B)	13260-1918	1
GEAR,OUTPUT 4TH,28T (Ref # 13260C)	13260-1920	1
GEAR,OUTPUT 3RD,31T (Ref # 13262)	13262-0093	1
GEAR,INPUT 3RD,26T (Ref # 13262A)	13262-1068	1
GEAR,INPUT 4TH,29T (Ref # 13262B)	13262-1069	1
GEAR,INPUT 5TH,32T (Ref # 13262C)	13262-1070	1
GEAR,OUTPUT 5TH,25T (Ref # 13262D)	13262-1072	1
NUT,20MM (Ref # 92015)	92015-1610	1
WASHER,25.5X36X1.0 (Ref # 92022)	92022-1855	1
WASHER,22.3X35X1.6 (Ref # 92022A)	92022-212	1
SPACER,25.5X38X1.0 (Ref # 92026)	92026-1536	1
BUSHING,INPUT TOP GEAR (Ref # 92028)	92028-1990	1
BUSHING,OUTPUT 3RD GEAR (Ref # 92028A)	92028-1991	1
RING-SNAP,20X25.5X1.2 (Ref # 92033)	92033-025	1
RING-SNAP (Ref # 92033A)	92033-032	1
RING-SNAP,25MM (Ref # 92033B)	92033-1172	1
BEARING-NEEDLE,TK253515 (Ref # 92046)	92046-1259	1
BEARING-NEEDLE,FWF-162222 (Ref # 92046A)	92046-1260	1
BEARING-NEEDLE,BN502250 (Ref # 92046B)	92046-1293	1
WASHER,28.5X34.0X1.5 (Ref # 92200)	92200-1240	1
WASHER,30.3X40X1.5 (Ref # 92200A)	92200-1381	1