

2008 Vulcan® 1600 Nomad™ PARTS DIAGRAM

Muffler(s)

E1140

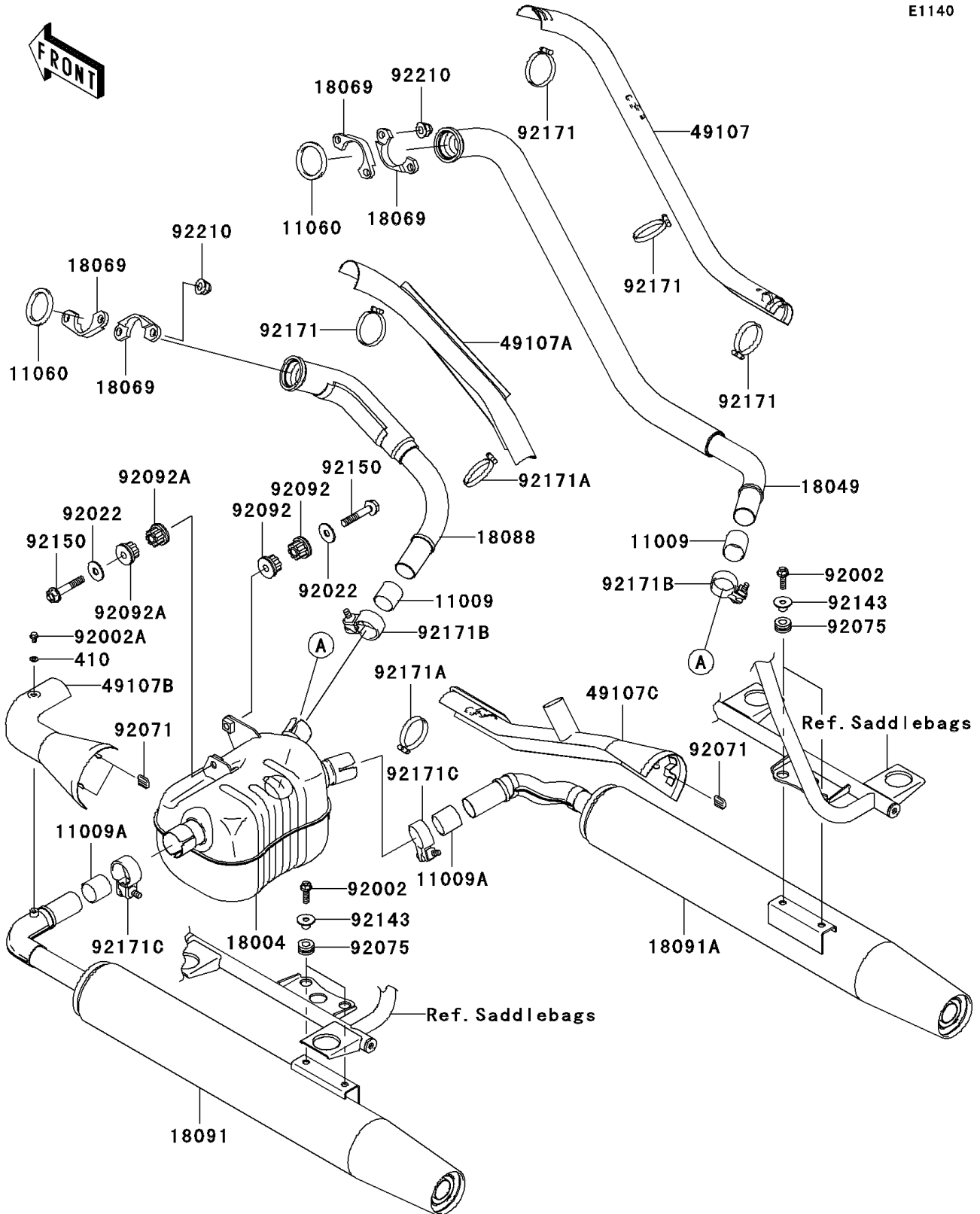

2008 Vulcan® 1600 Nomad™ PARTS LIST

Muffler(s)

ITEM NAME	PART NUMBER	QUANTITY
WASHER-PLAIN-SMALL,6MM (Ref # 410)	410S0600	1
GASKET,EXHAUST PIPE CONNECTING (Ref # 11009)	11009-1667	1
GASKET,MUFFLER CONNECTING (Ref # 11009A)	11009-1865	1
GASKET,EXHAUST PIPE (Ref # 11060)	11060-1119	1
CHAMBER-PREMUFLER (Ref # 18004)	18004-0004	1
PIPE-EXHAUST,FR (Ref # 18049)	18049-1906	1
HOLDER-EXHAUST PIPE (Ref # 18069)	18069-1161	1
PIPE-EXHAUST,RR (Ref # 18088)	18088-1100	1
BODY-COMP-MUFFLER (Ref # 18091)	18091-0199	1
BODY-COMP-MUFFLER (Ref # 18091A)	18091-0200	1
COVER-EXHAUST PIPE,FRONT (Ref # 49107)	49107-0015	1
COVER-EXHAUST PIPE,RR (Ref # 49107A)	49107-0055	1
COVER-EXHAUST PIPE,LH (Ref # 49107B)	49107-1158	1
COVER-EXHAUST PIPE,RH (Ref # 49107C)	49107-1180	1
BOLT,8X25 (Ref # 92002)	92002-1591	1
BOLT,6X8 (Ref # 92002A)	92002-1604	1
WASHER,10.5X30X2.3,BLACK (Ref # 92022)	92022-1302	1
GROMMET (Ref # 92071)	92071-1270	1
DAMPER (Ref # 92075)	92075-1898	1
BUSHING-RUBBER,MUFFLER (Ref # 92092)	92092-1013	1
BUSHING-RUBBER (Ref # 92092A)	92092-1081	1
COLLAR (Ref # 92143)	92143-1753	1
BOLT,10X55 (Ref # 92150)	92150-1749	1
CLAMP (Ref # 92171)	92171-0058	1
CLAMP (Ref # 92171A)	92171-0059	1
CLAMP,CHAMBER-EX PIPE (Ref # 92171B)	92171-0061	1
CLAMP,CHAMBER-MUFFLER (Ref # 92171C)	92171-0062	1
NUT,CAP,8MM (Ref # 92210)	92210-1132	1