

# 1998 KX500 PARTS DIAGRAM

Front Fork

F2340

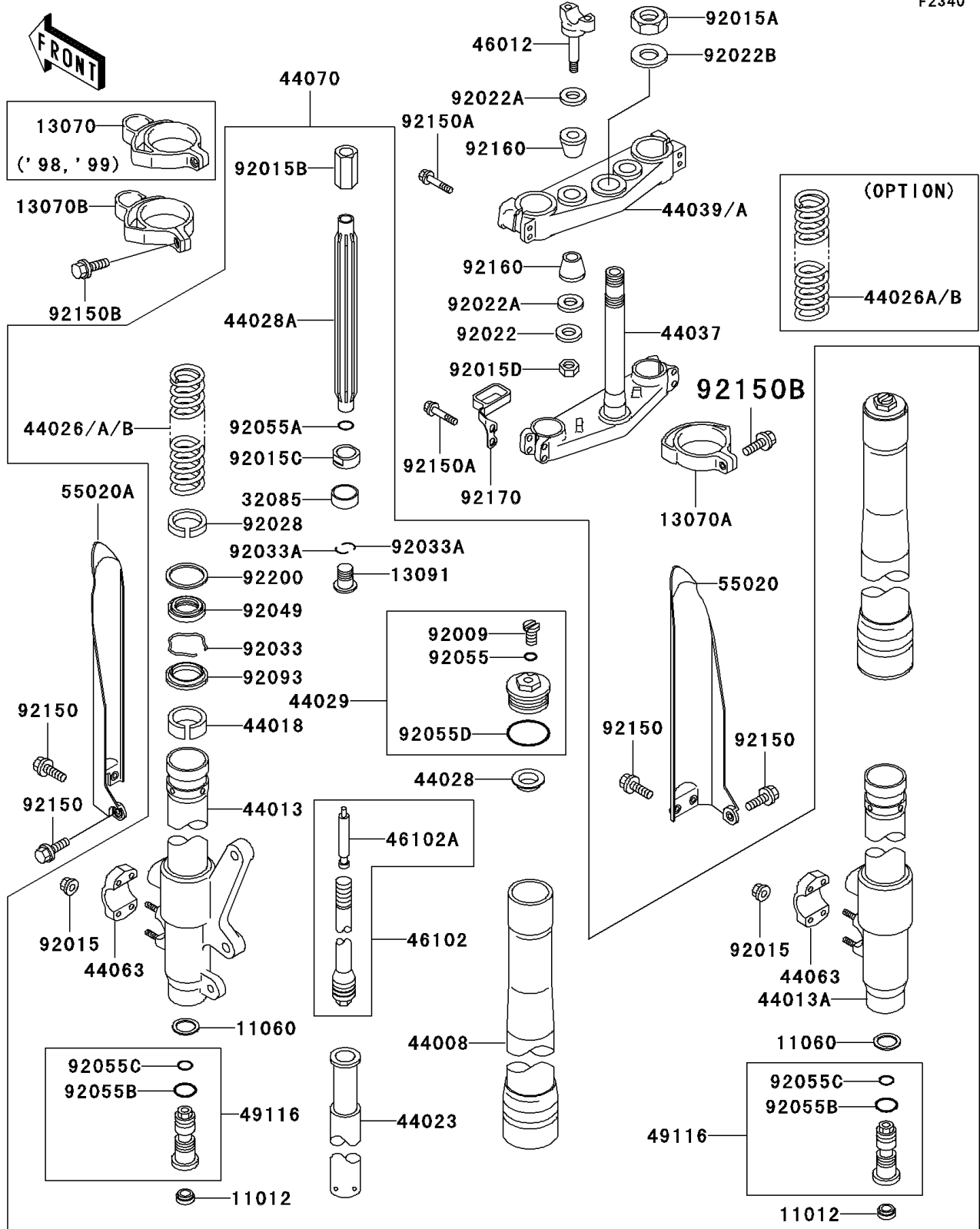

# 1998 KX500 PARTS LIST

## Front Fork

| ITEM NAME                               | PART NUMBER   | QUANTITY |
|---|---------------|----------|
| CAP (Ref # 11012)                       | 11012-1692    | 2        |
| GASKET (Ref # 11060)                    | 11060-1707    | 2        |
| GUIDE,PROTECTOR,LH,WHITE (Ref # 13070)  | 13070-1289-RZ | 1        |
| GUIDE,PROTECTOR,RH,WHITE (Ref # 13070A) | 13070-1290-RZ | 1        |
| HOLDER (Ref # 13091)                    | 13091-1651    | 2        |
| STOPPER (Ref # 32085)                   | 32085-1323    | 2        |
| PIPE-FORK OUTER,A.N.GOLD (Ref # 44008)  | 44008-1037-14 | 2        |
| PIPE-FORK INNER,LH (Ref # 44013)        | 44013-1413    | 1        |
| PIPE-FORK INNER,RH (Ref # 44013A)       | 44013-1414    | 1        |
| PISTON-FORK,INNER PIPE (Ref # 44018)    | 44018-1059    | 2        |
| CYLINDER-COMP-FORK (Ref # 44023)        | 44023-1114    | 2        |
| SPRING-FRONT FORK,K=0.40 (Ref # 44026)  | 44026-1620    | 2        |
| SPRING-FRONT FORK,K=0.39 (Ref # 44026A) | 44026-1623    | 2        |
| SPRING-FRONT FORK,K=0.41 (Ref # 44026B) | 44026-1624    | 2        |
| GUIDE-FORK SPRING (Ref # 44028)         | 44028-1097    | 2        |
| GUIDE-FORK SPRING (Ref # 44028A)        | 44028-1100    | 2        |
| SEAT-FORK SPRING (Ref # 44029)          | 44029-1159    | 2        |
| HOLDER-FORK UNDER (Ref # 44037)         | 44037-1354    | 1        |
| HOLDER-FORK UPPER (Ref # 44039)         | 44039-1269    | 1        |
| HOLDER-FRONT AXLE (Ref # 44063)         | 44063-1060    | 2        |
| DAMPER-ASSY,FORK,A.N.GOLD (Ref # 44070) | 44070-1551-14 | 1        |
| HOLDER-HANDLE,LWR (Ref # 46012)         | 46012-1264    | 2        |
| ROD,FORK,ASSY (Ref # 46102)             | 46102-1401    | 2        |
| ROD,FORK,INNER (Ref # 46102A)           | 46102-1403    | 2        |
| VALVE-ASSY,FORK (Ref # 49116)           | 49116-1150    | 2        |
| GUARD,FORK,RH,WHITE (Ref # 55020)       | 55020-1493-RZ | 1        |
| GUARD,FORK,LH,WHITE (Ref # 55020A)      | 55020-1554-RZ | 1        |
| SCREW (Ref # 92009)                     | 92009-1568    | 2        |
| NUT,FLANGED,6MM (Ref # 92015)           | 92015-1078    | 8        |

# 1998 KX500 PARTS LIST

## Front Fork

| ITEM NAME                              | PART NUMBER | QUANTITY |
|--|-------------|----------|
| NUT,STEERING STEM,22MM (Ref # 92015A)  | 92015-1653  | 1        |
| NUT (Ref # 92015B)                     | 92015-1872  | 2        |
| NUT (Ref # 92015C)                     | 92015-1945  | 2        |
| NUT,LOCK,10MM (Ref # 92015D)           | 92015-1962  | 2        |
| WASHER,10.2X28X2 (Ref # 92022)         | 92022-1088  | 2        |
| WASHER (Ref # 92022A)                  | 92022-1737  | 4        |
| WASHER,STEERING STEM (Ref # 92022B)    | 92022-1873  | 1        |
| BUSHING (Ref # 92028)                  | 92028-1755  | 2        |
| RING-SNAP (Ref # 92033)                | 92033-1264  | 2        |
| RING-SNAP (Ref # 92033A)               | 92033-1271  | 4        |
| SEAL-OIL,FORK OUTER TUBE (Ref # 92049) | 92049-1440  | 2        |
| RING-O (Ref # 92055)                   | 92055-1441  | 2        |
| RING-O (Ref # 92055A)                  | 92055-1442  | 2        |
| RING-O,FORK VALVE (Ref # 92055B)       | 92055-1547  | 2        |
| RING-O,FORK VALVE (Ref # 92055C)       | 92055-1548  | 2        |
| RING-O (Ref # 92055D)                  | 92055-1549  | 2        |
| SEAL,FORK OUTER TUBE (Ref # 92093)     | 92093-1392  | 2        |
| BOLT,6X12 (Ref # 92150)                | 92150-1435  | 6        |
| BOLT,FLANGED,8X40 (Ref # 92150A)       | 92150-1516  | 8        |
| BOLT,5X16 (Ref # 92150B)               | 92150-1802  | 2        |
| DAMPER,HANDLE HOLDER (Ref # 92160)     | 92160-1544  | 4        |
| CLAMP,HOSE (Ref # 92170)               | 92170-1604  | 1        |
| WASHER (Ref # 92200)                   | 92200-1006  | 2        |