

2021 BRUTE FORCE® 300 PARTS DIAGRAM

Front Bevel Gear

E3131

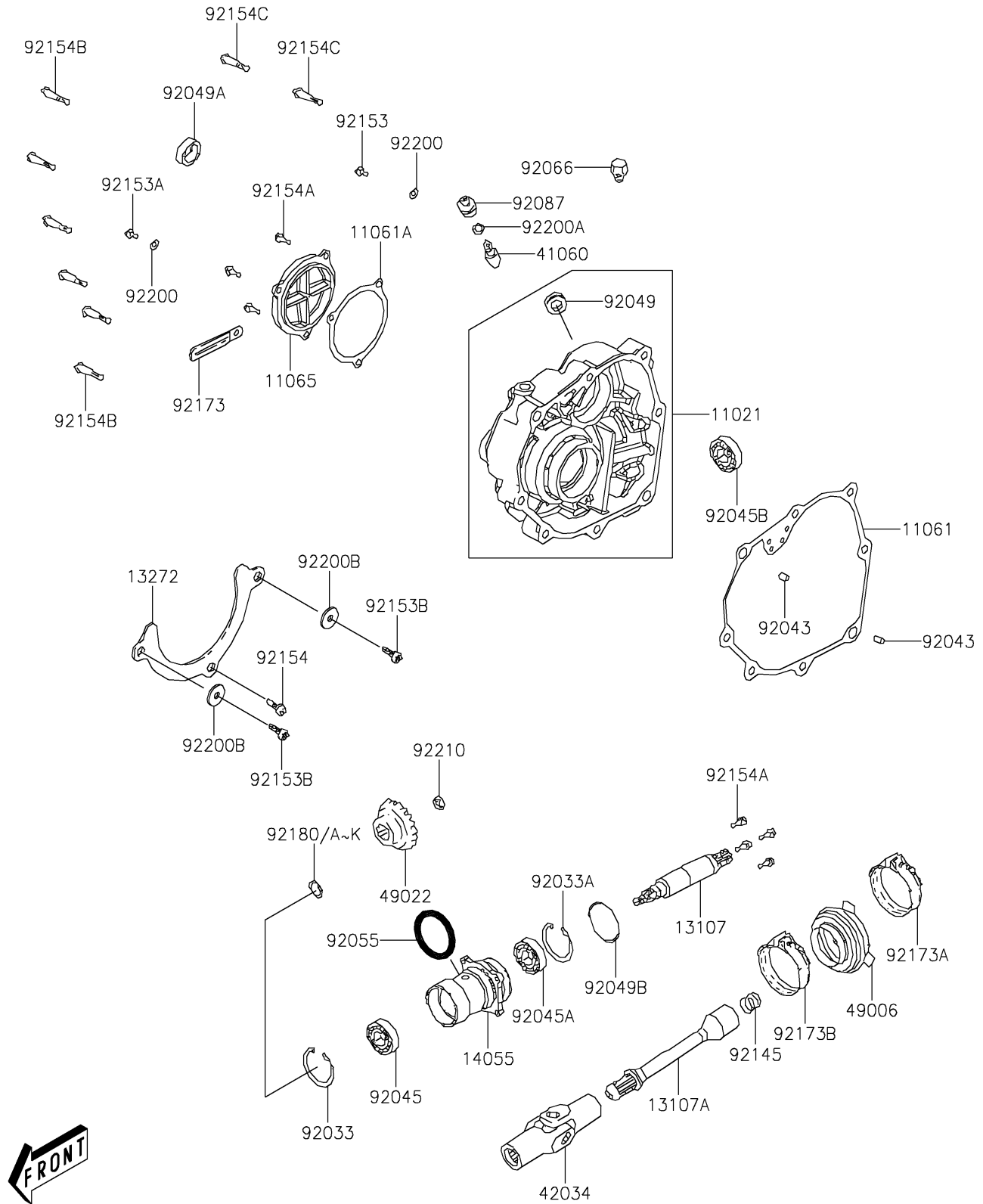

2021 BRUTE FORCE® 300 PARTS LIST

Front Bevel Gear

ITEM NAME	PART NUMBER	QUANTITY
CASE-ASSY,MISSION (Ref # 11021)	11021-Y001	1
GASKET,MISSION CASE (Ref # 11061)	11061-Y030	1
GASKET,CAP (Ref # 11061A)	11061-Y031	1
CAP (Ref # 11065)	11065-Y012	1
SHAFT,FINAL (Ref # 13107)	13107-Y009	1
SHAFT,PROPELLER (Ref # 13107A)	13107-Y010	1
PLATE (Ref # 13272)	13272-Y008	1
CASE-GEAR (Ref # 14055)	14055-Y003	1
GEAR-METER SCREW (Ref # 41060)	41060-Y001	1
COUPLING (Ref # 42034)	42034-Y001	1
BOOT (Ref # 49006)	49006-Y003	1
GEAR-BEVEL,DRIVEN (Ref # 49022)	49022-Y007	1
RING-SNAP (Ref # 92033)	92033-Y020	1
RING-SNAP (Ref # 92033A)	92033-Y021	1
PIN,10X16 (Ref # 92043)	92043-Y013	1
BEARING-BALL,63/22 (Ref # 92045)	92045-0139	1
BEARING-BALL,62/28 (Ref # 92045A)	92045-Y021	1
BEARING-BALL,6009 (Ref # 92045B)	92045-Y022	1
SEAL-OIL,12X18X3 (Ref # 92049)	92049-Y013	1
SEAL-OIL,14X28X7 (Ref # 92049A)	92049-Y014	1
SEAL-OIL,28X59X7 (Ref # 92049B)	92049-Y015	1
RING-O (Ref # 92055)	92055-Y026	1
PLUG,DRAIN (Ref # 92066)	92066-Y003	1
BUSHING-METER GEAR (Ref # 92087)	92087-Y001	1
SPRING,PROPELLER SHAFT (Ref # 92145)	92145-Y028	1
BOLT,FLANGE,8X12 (Ref # 92153)	92153-Y031	1
BOLT,FLANGE,8X16 (Ref # 92153A)	92153-Y032	1
BOLT,SOCKET,6X12 (Ref # 92153B)	92153-Y059	1
BOLT,SOCKET,6X10 (Ref # 92154)	92154-Y003	1

2021 BRUTE FORCE® 300 PARTS LIST

Front Bevel Gear

ITEM NAME	PART NUMBER	QUANTITY
BOLT,6X20 (Ref # 92154A)	92154-Y057	1
BOLT,FLANGE,8X40 (Ref # 92154B)	92154-Y113	1
BOLT,FLANGE,8X45 (Ref # 92154C)	92154-Y136	1
CLAMP (Ref # 92173)	92173-Y004	1
CLAMP (Ref # 92173A)	92173-Y006	1
CLAMP (Ref # 92173B)	92173-Y007	1
SHIM,DRIVE,A,T=0.6 (Ref # 92180)	92180-Y001	1
SHIM,DRIVE,B,T=0.65 (Ref # 92180A)	92180-Y002	1
SHIM,DRIVE,C,T=0.7 (Ref # 92180B)	92180-Y003	1
SHIM,DRIVE,D,T=0.75 (Ref # 92180C)	92180-Y004	1
SHIM,DRIVE,E,T=0.8 (Ref # 92180D)	92180-Y005	1
SHIM,DRIVE,F,T=0.85 (Ref # 92180E)	92180-Y006	1
SHIM,DRIVE,G,T=0.9 (Ref # 92180F)	92180-Y007	1
SHIM,DRIVE,H,T=0.95 (Ref # 92180G)	92180-Y008	1
SHIM,DRIVE,I,T=1.0 (Ref # 92180H)	92180-Y009	1
SHIM,DRIVE,J,T=1.05 (Ref # 92180I)	92180-Y010	1
SHIM,DRIVE,K,T=1.1 (Ref # 92180J)	92180-Y011	1
SHIM,DRIVE,L,T=1.15 (Ref # 92180K)	92180-Y012	1
WASHER,8MM (Ref # 92200)	92200-Y010	1
WASHER,8MM (Ref # 92200A)	92200-Y027	1
WASHER,21X6.2X2 (Ref # 92200B)	92200-Y063	1
NUT (Ref # 92210)	92210-Y040	1