

2017 Versys-X 300 ABS PARTS DIAGRAM

Crankcase

E1411

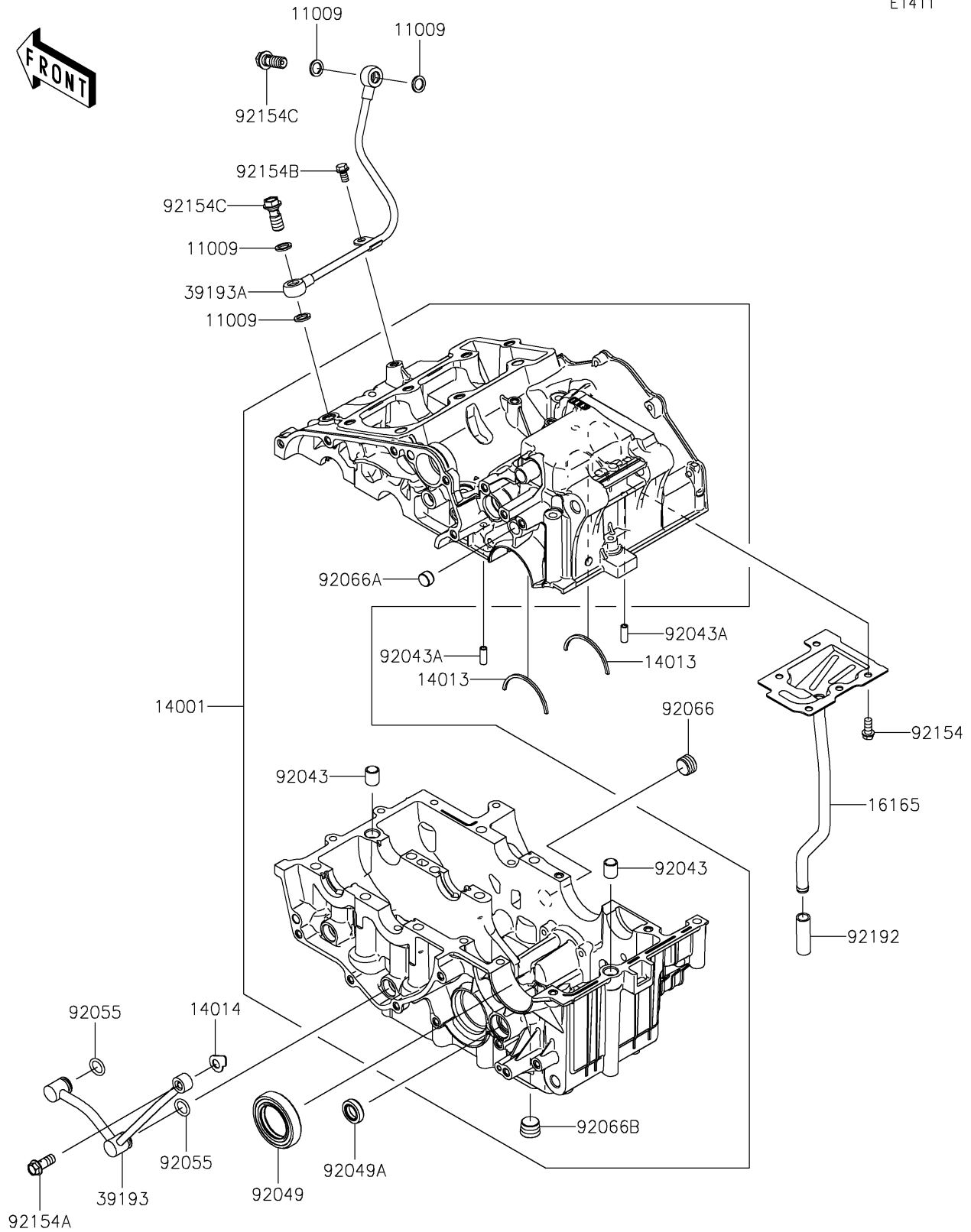

2017 Versys-X 300 ABS PARTS LIST

Crankcase

| ITEM NAME | PART NUMBER | QUANTITY |
|-----------------------------------|-------------|----------|
| GASKET,10X14.5X1.5 (Ref # 11009) | 11009-1105 | 1 |
| SET-CRANKCASE (Ref # 14001) | 14001-0688 | 1 |
| RING-POSITION (Ref # 14013) | 14013-004 | 1 |
| PLATE-POSITION (Ref # 14014) | 14014-0565 | 1 |
| SEPARATOR (Ref # 16165) | 16165-0013 | 1 |
| PIPE-OIL (Ref # 39193) | 39193-0571 | 1 |
| PIPE-OIL,CASE-HEAD (Ref # 39193A) | 39193-0583 | 1 |
| PIN,12X14 (Ref # 92043) | 92043-0963 | 1 |
| PIN,3.5X6X16 (Ref # 92043A) | 92043-1309 | 1 |
| SEAL-OIL,32X52X10 (Ref # 92049) | 92049-0731 | 1 |
| SEAL-OIL (Ref # 92049A) | 92049-1559 | 1 |
| RING-O,11.8X2.4 (Ref # 92055) | 92055-0733 | 1 |
| PLUG,PT3/8X10 (Ref # 92066) | 92066-0003 | 1 |
| PLUG (Ref # 92066A) | 92066-1110 | 1 |
| PLUG,PT3/8X12 (Ref # 92066B) | 92066-1252 | 1 |
| BOLT,FLANGED,6X14 (Ref # 92154) | 92154-0777 | 1 |
| BOLT,FLANGED,8X20 (Ref # 92154A) | 92154-0957 | 1 |
| BOLT,FLANGED,6X10 (Ref # 92154B) | 92154-2343 | 1 |
| BOLT,BANJO,10X23 (Ref # 92154C) | 92154-2560 | 1 |
| TUBE,9X12X38 (Ref # 92192) | 92192-0225 | 1 |