

1993 KX125 PARTS DIAGRAM

Clutch

E1350

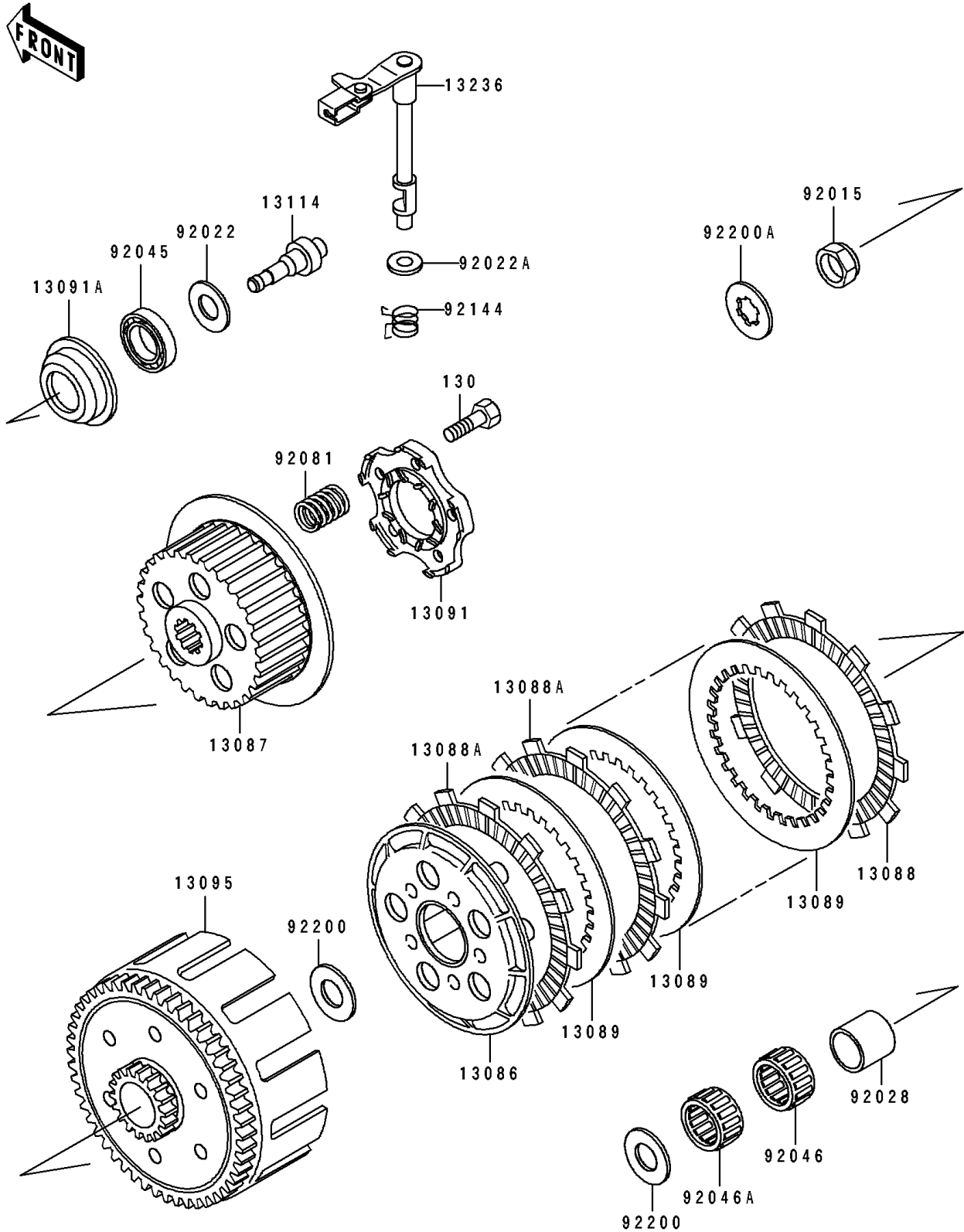

1993 KX125 PARTS LIST

Clutch

ITEM NAME	PART NUMBER	QUANTITY
WHEEL-CLUTCH (Ref # 13086)	13086-1062	1
HUB-CLUTCH (Ref # 13087)	13087-1120	1
PLATE-FRICTION (Ref # 13088)	13088-1090	6
PLATE-FRICTION (Ref # 13088A)	13088-1101	2
PLATE-CLUTCH (Ref # 13089)	13089-1094	7
HOLDER,CLUTCH SPRING (Ref # 13091)	13091-1502	1
HOLDER,CLUTCH PUSHER (Ref # 13091A)	13091-1712	1
HOUSING-COMP-CLUTCH (Ref # 13095)	13095-1258	1
PUSHER-CLUTCH (Ref # 13114)	13114-1063	1
LEVER-COMP,RELEASE (Ref # 13236)	13236-1230	1
NUT,16MM (Ref # 92015)	92015-1820	1
WASHER,10.2X14.5X1.0 (Ref # 92022)	92022-1181	1
WASHER,12.3X20X0.5 (Ref # 92022A)	92022-269	1
BUSHING,17X22X25.3 (Ref # 92028)	92028-1588	1
BEARING-BALL,6000 (Ref # 92045)	92045-1225	1
BEARING-NEEDLE,K22X26X13 (Ref # 92046)	92046-1130	1
BEARING-NEEDLE,K22X26X11 (Ref # 92046A)	92046-1198	1
SPRING,CLUTCH (Ref # 92081)	92081-155	5
SPRING,CLUTCH RELEASE (Ref # 92144)	92144-1287	1
WASHER,17.3X30X2.0 (Ref # 92200)	92200-1030	2
WASHER (Ref # 92200A)	92200-1054	1
BOLT-FLANGED,6X25 (Ref # 130)	130G0625	5