

2017 Versys 650 ABS PARTS DIAGRAM

Cowling(FHF/FHFA)

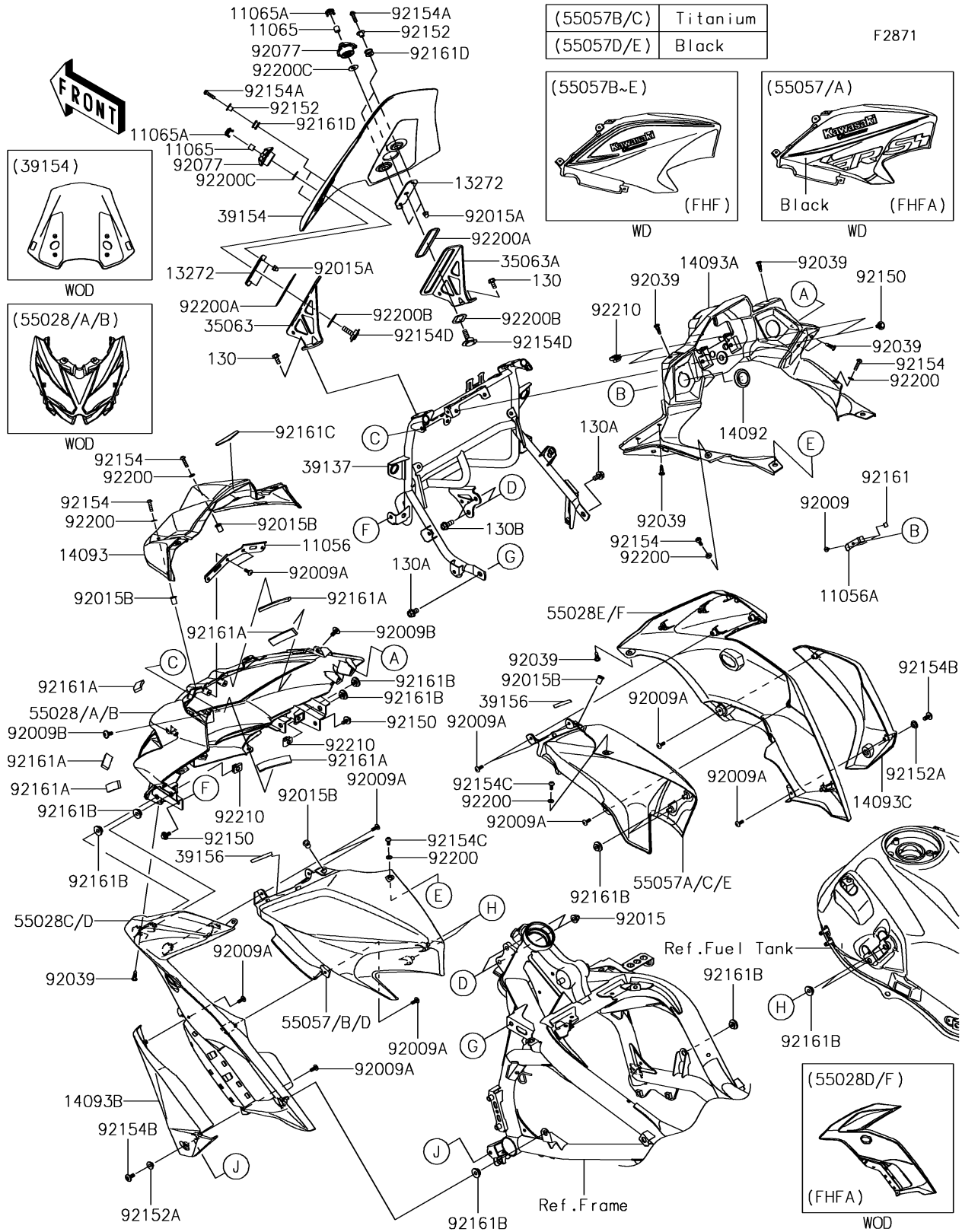

2017 Versys 650 ABS PARTS LIST

Cowling(FHF/FHFA)

ITEM NAME	PART NUMBER	QUANTITY
BRACKET,HEAD LAMP (Ref # 11056)	11056-3975	1
BRACKET,CAP COVER (Ref # 11056A)	11056-4313	2
CAP (Ref # 11065)	11065-0156	2
CAP,KNOB (Ref # 11065A)	11065-0734	2
PLATE,WINDSHIELD (Ref # 13272)	13272-2333	2
COVER,DC SOCKET (Ref # 14092)	14092-0214	2
COVER,METER,UPP (Ref # 14093)	14093-0093	1
COVER,METER (Ref # 14093A)	14093-0094	1
COVER,RADIATOR,LH (Ref # 14093B)	14093-0095	1
COVER,RADIATOR RH (Ref # 14093C)	14093-0096	1
STAY,WINDSHIELD,LH (Ref # 35063)	35063-1321	1
STAY,WINDSHIELD,RH (Ref # 35063A)	35063-1322	1
STAY-COMP,UPP COWL. (Ref # 39137)	39137-0669	1
WINDSHIELD (Ref # 39154)	39154-0361	1
PAD,6X70 (Ref # 39156)	39156-1920	2
COWLING,UPP,C.L.GREEN (Ref # 55028)	55028-0514-51P	1
COWLING,SIDE,LH,M.S.BLACK (Ref # 55028D)	55028-0515-660	1
COWLING,SIDE,RH,M.S.BLACK (Ref # 55028F)	55028-0516-660	1
COWLING,TANK SIDE,LH,M.S.BLACK (Ref # 55057)	55057-5352-660	1
COWLING,TANK SIDE,RH,M.S.BLACK (Ref # 55057A)	55057-5353-660	1
SCREW,TAPPING,4X8 (Ref # 92009)	92009-1155	2
SCREW,TAPPING,5X14 (Ref # 92009A)	92009-1197	12
SCREW,6X14 (Ref # 92009B)	92009-1662	2
NUT,CAP,8MM (Ref # 92015)	92015-1151	2
NUT,LOCK,FLANGE CAP,5MM (Ref # 92015A)	92015-1263	4
NUT,WELL,5MM (Ref # 92015B)	92015-1757	4
RIVET (Ref # 92039)	92039-0709	8
BOLT-FLANGED,6X14 (Ref # 130)	130BA0614	4
BOLT-FLANGED,8X14 (Ref # 130A)	130BA0814	2

2017 Versys 650 ABS PARTS LIST

Cowling(FHF/FHFA)

ITEM NAME	PART NUMBER	QUANTITY
BOLT-FLANGED,8X20 (Ref # 130B)	130BA0820	2
KNOB,ADJUSTERS (Ref # 92077)	92077-0034	2
BOLT,FLANGED,6X14 (Ref # 92150)	92150-1689	4
COLLAR (Ref # 92152)	92152-0092	4
COLLAR,6.5X10X5.6 (Ref # 92152A)	92152-0445	2
BOLT,SOCKET,5X20 (Ref # 92154)	92154-0216	4
BOLT,SOCKET,5X20 (Ref # 92154A)	92154-0919	4
BOLT,SOCKET,6X14 (Ref # 92154B)	92154-0932	2
BOLT,SOCKET,5X12 (Ref # 92154C)	92154-1421	2
BOLT,PLATE,8X30 (Ref # 92154D)	92154-1438	2
DAMPER (Ref # 92161)	92161-0816	4
DAMPER,15X70X5 (Ref # 92161A)	92161-1380	6
DAMPER (Ref # 92161B)	92161-1531	10
DAMPER,10X65X2 (Ref # 92161C)	92161-1758	1
DAMPER (Ref # 92161D)	92161-1938	4
WASHER,NYLON,5.3X11.5X0.5 (Ref # 92200)	92200-0006	6
WASHER (Ref # 92200A)	92200-0801	2
WASHER,23.5X32X1 (Ref # 92200B)	92200-0802	2
WASHER,8.2X20X1 (Ref # 92200C)	92200-1751	2
NUT,CLIP,6MM (Ref # 92210)	92210-0933	4