

2008 Z1000 PARTS DIAGRAM

Cowling

F2871

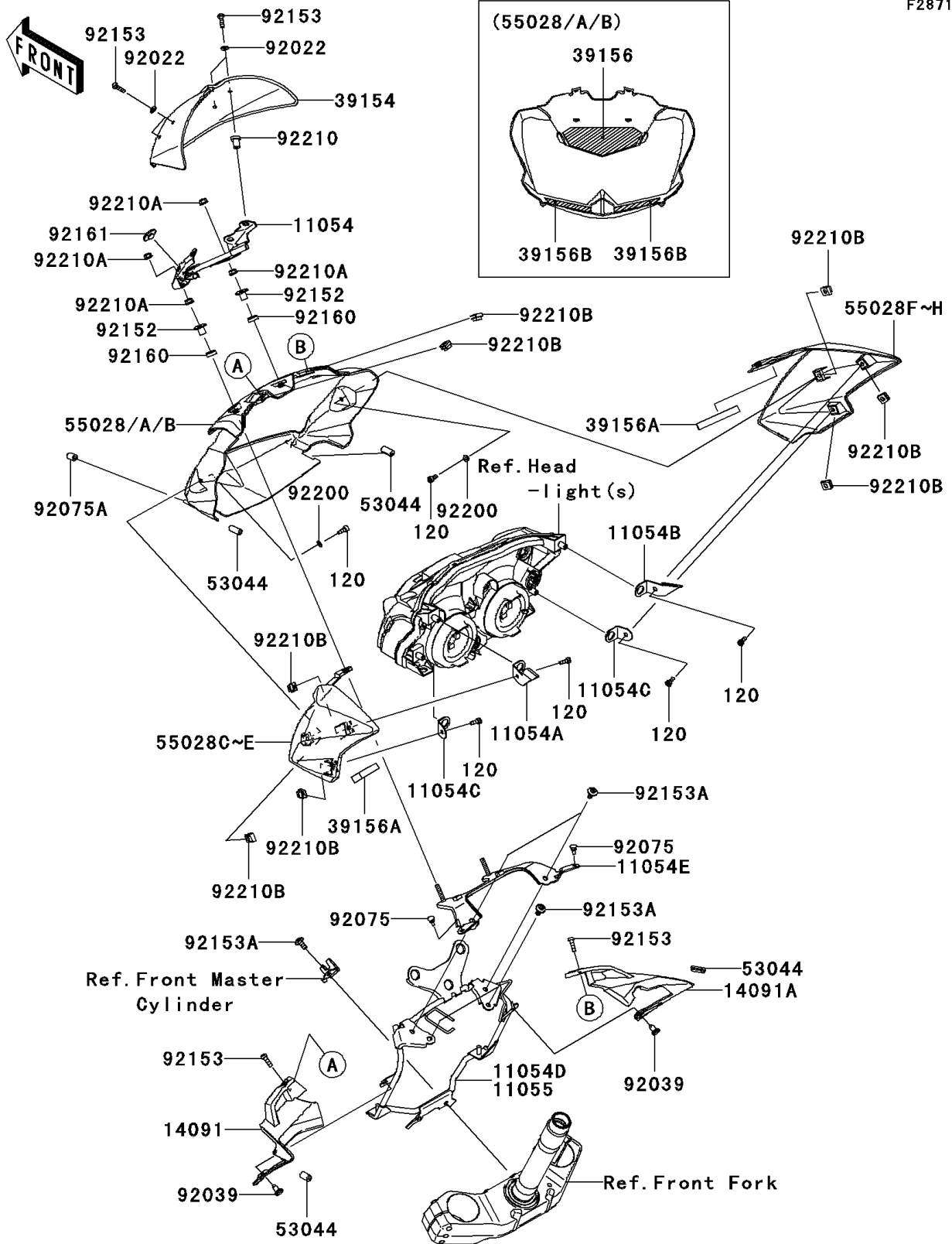

2008 Z1000 PARTS LIST

Cowling

ITEM NAME	PART NUMBER	QUANTITY
BRACKET,WINDSHIELD (Ref # 11054)	11054-0844	1
BRACKET,HEAD LAMP,UPP,LH (Ref # 11054A)	11054-0871	1
BRACKET,HEAD LAMP,UPP,RH (Ref # 11054B)	11054-0872	1
BRACKET,HEAD LAMP,LWR (Ref # 11054C)	11054-0873	2
BRACKET,UPP COWLING (Ref # 11054E)	11054-1880	1
BRACKET,METER (Ref # 11055)	11055-0089	1
COVER,INNER,LH (Ref # 14091)	14091-0569	1
COVER,INNER,RH (Ref # 14091A)	14091-0663	1
WINDSHIELD (Ref # 39154)	39154-0020	1
PAD,UPP COWLING (Ref # 39156)	39156-0338	1
PAD,UPP COWLING (Ref # 39156A)	39156-0339	2
PAD,UPP COWLING (Ref # 39156B)	39156-0340	2
TRIM,L=20 (Ref # 53044)	53044-0021	4
WASHER,NYLON,5.3X11.5X1.5 (Ref # 92022)	92022-1521	4
RIVET (Ref # 92039)	92039-1286	2
DAMPER (Ref # 92075)	92075-1808	2
DAMPER,SIDE COVER (Ref # 92075A)	92075-1964	2
COLLAR (Ref # 92152)	92152-1074	2
BOLT,SOCKET,5X18 (Ref # 92153)	92153-0370	6
BOLT,SOCKET,6X14 (Ref # 92153A)	92153-1612	6
DAMPER (Ref # 92160)	92160-3754	2
DAMPER,RUBBER (Ref # 92161)	92161-1200	1
WASHER,NYLON,5.3X11.5X0.5 (Ref # 92200)	92200-1480	2
NUT,5MM (Ref # 92210)	92210-0001	4
NUT,6X1.0 (Ref # 92210A)	92210-0241	4
NUT,5MM (Ref # 92210B)	92210-1266	8
BOLT-SOCKET,5X12 (Ref # 120)	120CB0512	6
COWLING,UPP,CNT,P.C.WHITE (Ref # 55028A)	55028-0102-667	1
COWLING,UPP,CNT,L.GREEN (Ref # 55028B)	55028-0102-777	1

2008 Z1000 PARTS LIST

Cowling

ITEM NAME	PART NUMBER	QUANTITY
COWLING,UPP,LH,P.C.WHITE (Ref # 55028D)	55028-0103-667	1
COWLING,UPP,LH,L.GREEN (Ref # 55028E)	55028-0103-777	1
COWLING,UPP,RH,P.C.WHITE (Ref # 55028G)	55028-0104-667	1
COWLING,UPP,RH,L.GREEN (Ref # 55028H)	55028-0104-777	1