

2003 KLX400R PARTS DIAGRAM

Clutch

E1350

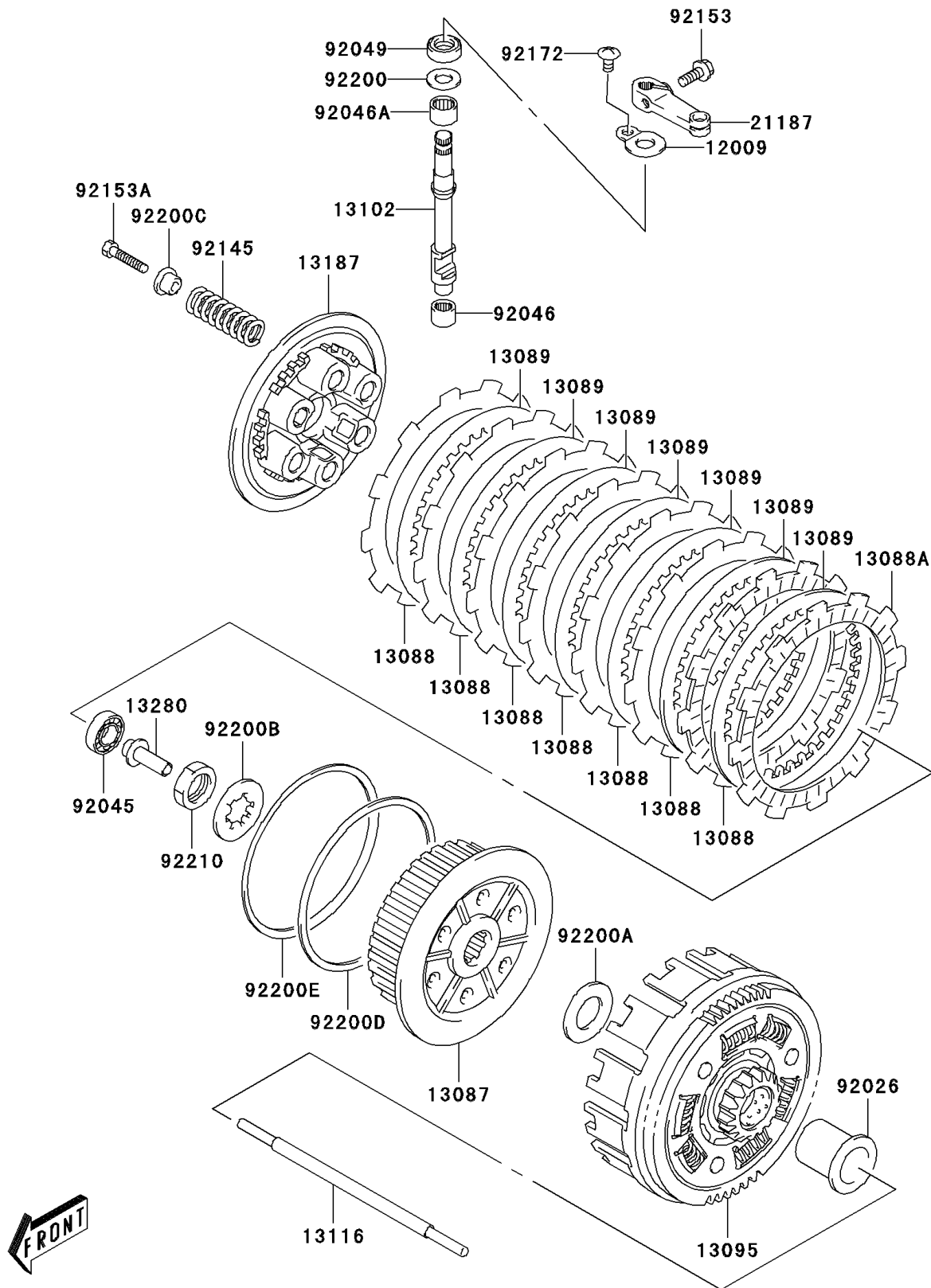

2003 KLX400R PARTS LIST

Clutch

| ITEM NAME | PART NUMBER | QUANTITY |
|---|-------------|----------|
| RETAINER-VALVE SPRING (Ref # 12009) | 12009-S003 | 1 |
| HUB-CLUTCH (Ref # 13087) | 13087-S005 | 1 |
| PLATE-FRICTION,NO.1 (Ref # 13088) | 13088-S003 | 7 |
| PLATE-FRICTION,NO.2 (Ref # 13088A) | 13088-S004 | 1 |
| PLATE-CLUTCH (Ref # 13089) | 13089-S003 | 7 |
| HOUSING-COMP-CLUTCH (Ref # 13095) | 13095-S008 | 1 |
| RELEASE-COMP-CLUTCH (Ref # 13102) | 13102-S003 | 1 |
| ROD-PUSH (Ref # 13116) | 13116-S004 | 1 |
| PLATE-CLUTCH OPERATING (Ref # 13187) | 13187-S004 | 1 |
| HOLDER,CLUTCH PUSH (Ref # 13280) | 13280-S025 | 1 |
| ARM-ASSY,CLUTCH RELEASE (Ref # 21187) | 21187-S004 | 1 |
| SPACER (Ref # 92026) | 92026-S094 | 1 |
| BEARING-BALL,12X28X8 (Ref # 92045) | 92045-S004 | 1 |
| BEARING-NEEDLE,CAM SHAFT,LOW (Ref # 92046) | 92046-S014 | 1 |
| BEARING-NEEDLE,CAM SHAFT,UPP (Ref # 92046A) | 92046-S015 | 1 |
| SEAL-OIL,10X20X6 (Ref # 92049) | 92049-S018 | 1 |
| SPRING,CLUTCH (Ref # 92145) | 92145-S100 | 6 |
| BOLT (Ref # 92153) | 92153-S001 | 1 |
| BOLT (Ref # 92153A) | 92153-S082 | 6 |
| SCREW (Ref # 92172) | 92172-S092 | 1 |
| WASHER,10X20X1.0 (Ref # 92200) | 92200-S061 | 1 |
| WASHER,CLUTCH (Ref # 92200A) | 92200-S131 | 1 |
| WASHER,CLUTCH (Ref # 92200B) | 92200-S144 | 1 |
| WASHER,CLUTCH SPRING (Ref # 92200C) | 92200-S153 | 6 |
| WASHER (Ref # 92200D) | 92200-S185 | 1 |
| WASHER (Ref # 92200E) | 92200-S186 | 1 |
| NUT,CLUTCH (Ref # 92210) | 92210-S103 | 1 |