

1991 Bayou 300 4X4 PARTS DIAGRAM

Crankcase

E1411

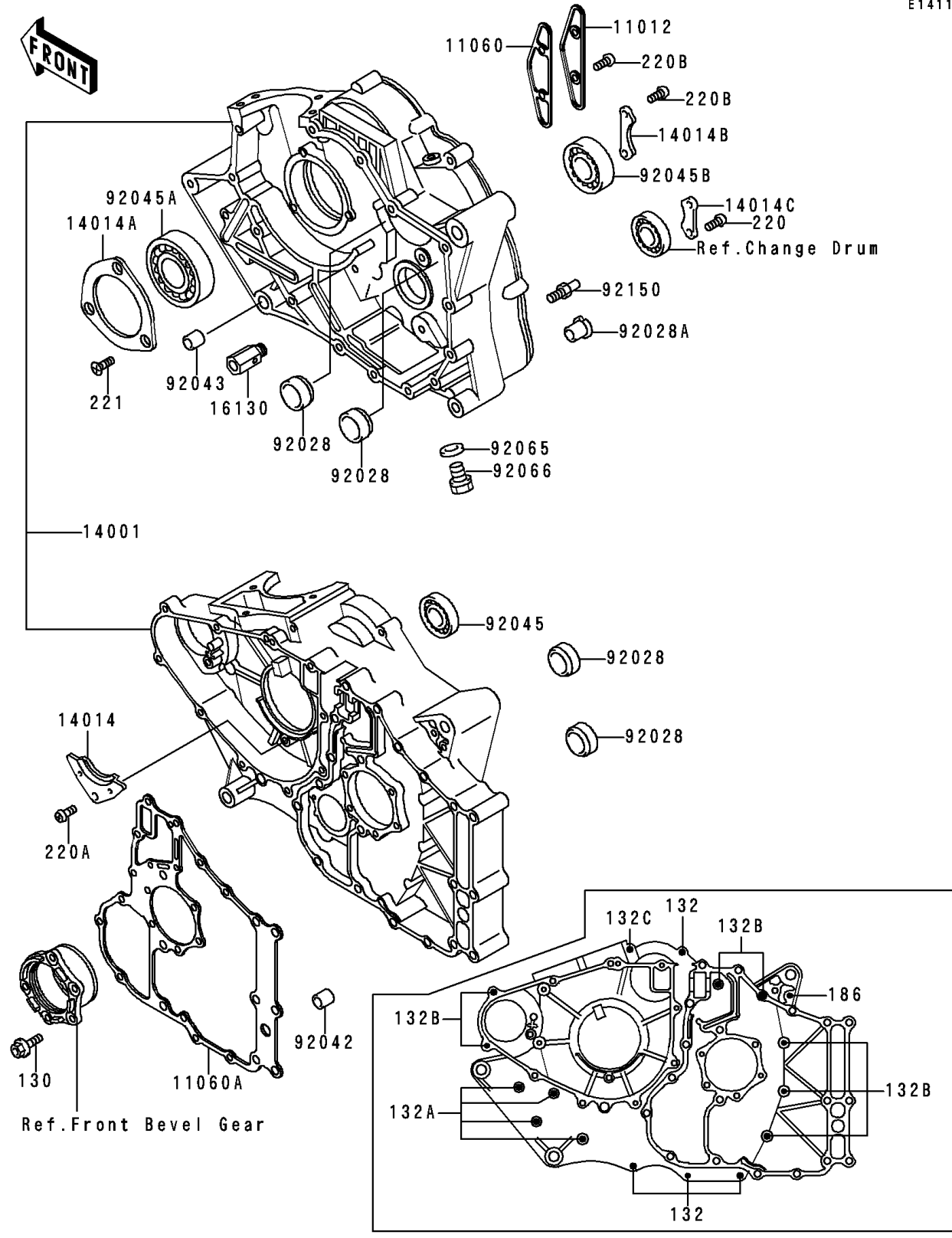

1991 Bayou 300 4X4 PARTS LIST

Crankcase

| ITEM NAME | PART NUMBER | QUANTITY |
|---|-------------|----------|
| BOLT-FLANGED,6X20 (Ref # 130) | 130P0620 | 5 |
| BOLT-FLANGED-SMALL (Ref # 132) | 132Y0635 | 4 |
| BOLT-FLANGED-SMALL (Ref # 132A) | 132Y0655 | 5 |
| BOLT-FLANGED-SMALL (Ref # 132B) | 132Y0665 | 7 |
| BOLT-FLANGED-SMALL (Ref # 132C) | 132Y0685 | 1 |
| BOLT-UPSET-WP (Ref # 186) | 186D0614 | 1 |
| SCREW-PAN-CROS,6X10 (Ref # 220) | 220B0610 | 2 |
| SCREW-PAN-CROS,6X12 (Ref # 220A) | 220B0612 | 1 |
| SCREW-PAN-CROS,6X14 (Ref # 220B) | 220B0614 | 4 |
| SCREW-CSK-CROS,6X16 (Ref # 221) | 221B0616 | 3 |
| CAP (Ref # 11012) | 11012-1643 | 1 |
| GASKET,OIL LINE CAP (Ref # 11060) | 11060-1228 | 1 |
| GASKET,GEAR CASE (Ref # 11060A) | 11060-1229 | 1 |
| SET-CRANKCASE (Ref # 14001) | 14001-5325 | 1 |
| PLATE-POSITION,CAM CHAIN (Ref # 14014) | 14014-035 | 1 |
| PLATE-POSITION,CRANK BEARING (Ref # 14014A) | 14014-1004 | 1 |
| PLATE-POSITION (Ref # 14014B) | 14014-1069 | 1 |
| PLATE-POSITION,CHANGE DRUM (Ref # 14014C) | 14014-1070 | 1 |
| VALVE-ASSY-RELIEF (Ref # 16130) | 16130-1001 | 1 |
| BUSHING,23X30X13 (Ref # 92028) | 92028-132 | 4 |
| BUSHING (Ref # 92028A) | 92028-1386 | 1 |
| PIN,DOWEL,12X14 (Ref # 92042) | 92042-031 | 1 |
| PIN,11.5X14X14 (Ref # 92043) | 92043-1279 | 2 |
| BEARING-BALL,6004TMB (Ref # 92045) | 92045-1118 | 2 |
| BEARING-BALL (Ref # 92045A) | 92045-1172 | 1 |
| BEARING-BALL (Ref # 92045B) | 92045-1173 | 1 |
| GASKET,12X22X2,DRAIN PLUG (Ref # 92065) | 92065-097 | 1 |
| PLUG,OIL DRAIN,12X15 (Ref # 92066) | 92066-1174 | 1 |
| BOLT,RETURN SPRING (Ref # 92150) | 92150-1106 | 1 |