

# 1989 Bayou 300 PARTS DIAGRAM

Crankshaft

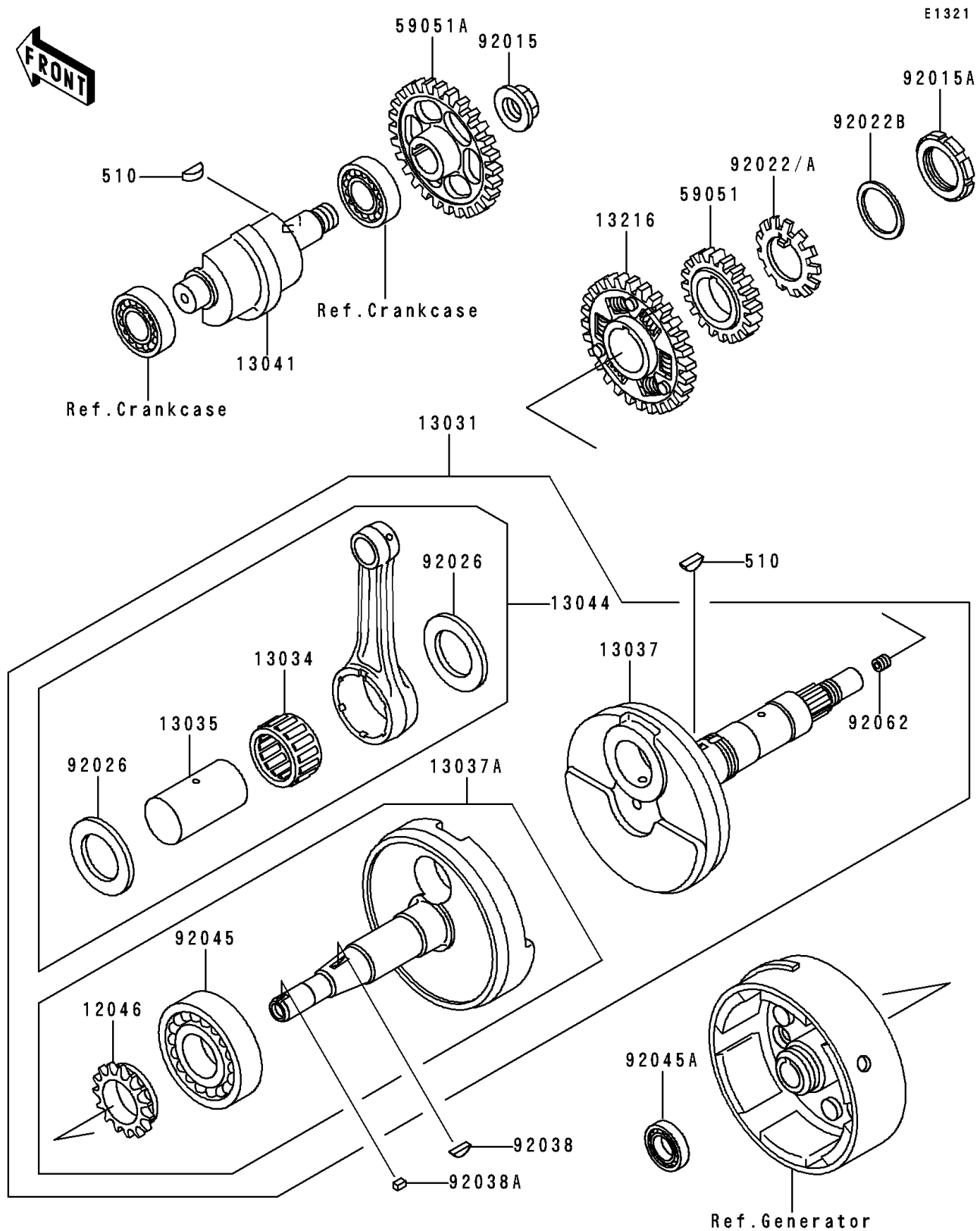

# 1989 Bayou 300 PARTS LIST

## Crankshaft

| ITEM NAME                                  | PART NUMBER | QUANTITY |
|--|-------------|----------|
| KEY-WOODRUFF (Ref # 510)                   | 510A5100    | 2        |
| SPROCKET,16T (Ref # 12046)                 | 12046-1038  | 1        |
| CRANKSHAFT-COMP (Ref # 13031)              | 13031-1254  | 1        |
| BEARING-BIG END,PK32X43X22.4 (Ref # 13034) | 13034-1061  | 1        |
| PIN-CRANK (Ref # 13035)                    | 13035-1067  | 1        |
| CRANKSHAFT,RH (Ref # 13037)                | 13037-1268  | 1        |
| CRANKSHAFT,LH (Ref # 13037A)               | 13037-5075  | 1        |
| BALANCER (Ref # 13041)                     | 13041-1066  | 1        |
| SET-CONNECTING ROD (Ref # 13044)           | 13044-5066  | 1        |
| GEAR-COMP,BALANCER (Ref # 13216)           | 13216-1072  | 1        |
| GEAR-SPUR,OIL PUMP,36T (Ref # 59051)       | 59051-1140  | 1        |
| GEAR-SPUR,BALANCER,44T (Ref # 59051A)      | 59051-1141  | 1        |
| NUT,16MM (Ref # 92015)                     | 92015-1465  | 1        |
| NUT,PUMP GEAR,30MM (Ref # 92015A)          | 92015-1511  | 1        |
| WASHER,TOOTHED (Ref # 92022A)              | 92022-1986  | 1        |
| WASHER,30.3X38X0.5 (Ref # 92022B)          | 92022-1987  | 1        |
| SPACER,32X51.5X1.2 (Ref # 92026)           | 92026-1232  | 2        |
| KEY,WOODRUFF (Ref # 92038)                 | 92038-001   | 1        |
| KEY,SUNK (Ref # 92038A)                    | 92038-1051  | 1        |
| BEARING-BALL,#6306 (Ref # 92045)           | 92045-037   | 1        |
| BEARING-BALL,#6903C3 (Ref # 92045A)        | 92045-1131  | 1        |
| NOZZLE (Ref # 92062)                       | 92062-1056  | 1        |