

1986 KDX80 PARTS DIAGRAM

Carburetor(KDX80-C1/C2/C3)

E1611-0229

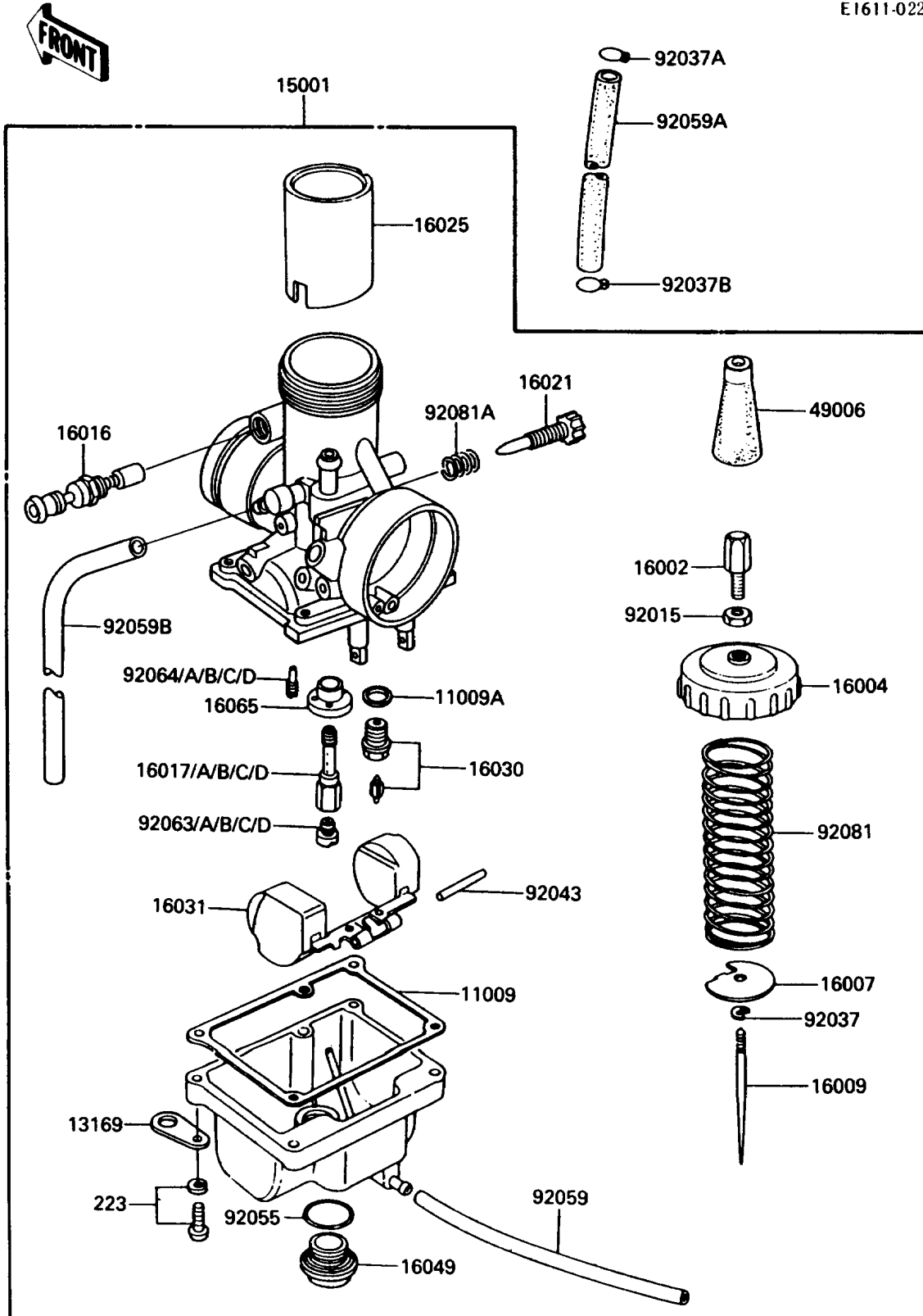

1986 KDX80 PARTS LIST

Carburetor(KDX80-C1/C2/C3)

| ITEM NAME | PART NUMBER | QUANTITY |
|--|-------------|----------|
| GASKET,FLOAT CHAMBER (Ref # 11009) | 11009-1147 | 1 |
| GASKET,FLOAT VALVE SEAT (Ref # 11009A) | 16029-004 | 1 |
| PLATE,TUBE CLAMP (Ref # 13169) | 13169-1226 | 1 |
| CARBURETOR (Ref # 15001) | 16001-1926 | 1 |
| ADJUSTER-CABLE (Ref # 16002) | 16002-017 | 1 |
| CAP-CHAMBER (Ref # 16004) | 16004-025 | 1 |
| SEAT-SPRING,THROTTLE VALVE (Ref # 16007) | 16007-023 | 1 |
| NEEDLE-JET,5I14 (Ref # 16009) | 16009-1220 | 1 |
| PLUNGER,STARTER (Ref # 16016) | 16016-1052 | 1 |
| JET-NEEDLE,O-6 (Ref # 16017) | 16017-1228 | 1 |
| JET-NEEDLE,P-0 (Ref # 16017A) | 16017-1229 | 1 |
| JET-NEEDLE,O-8 (Ref # 16017B) | 16017-1230 | 1 |
| JET-NEEDLE,O-4 (Ref # 16017C) | 16017-1231 | 1 |
| JET-NEEDLE,O-2 (Ref # 16017D) | 16017-1232 | 1 |
| SCREW-THROTTLE STOP (Ref # 16021) | 16021-1104 | 1 |
| VALVE-THROTTLE,CA2.0 (Ref # 16025) | 16025-1107 | 1 |
| VALVE-FLOAT,#2.6 (Ref # 16030) | 16030-1004 | 1 |
| FLOAT (Ref # 16031) | 16031-1005 | 1 |
| COVER-MAIN JET (Ref # 16049) | 16049-1001 | 1 |
| HOLDER,JET NEEDLE (Ref # 16065) | 16065-1020 | 1 |
| BOOT,CABLE ADJUSTER (Ref # 49006) | 16036-007 | 1 |
| NUT,ADJUST LOCK (Ref # 92015) | 16003-006 | 1 |
| CLAMP,E-TYPE (Ref # 92037) | 16008-010 | 1 |
| CLAMP,TUBE (Ref # 92037A) | 92037-147 | 1 |
| CLAMP (Ref # 92037B) | 92037-1712 | 1 |
| PIN,FLOAT (Ref # 92043) | 16032-003 | 1 |
| RING-O,MAIN JET COVER (Ref # 92055) | 92055-1061 | 1 |
| TUBE,3X5X300 (Ref # 92059) | 92059-1018 | 1 |
| TUBE,5.3X10.5X150 (Ref # 92059A) | 92059-1129 | 1 |

1986 KDX80 PARTS LIST

Carburetor(KDX80-C1/C2/C3)

| ITEM NAME | PART NUMBER | QUANTITY |
|---|-------------|----------|
| TUBE,3X5X320 (Ref # 92059B) | 92059-1430 | 1 |
| JET-MAIN,#190 (Ref # 92063) | 92063-021 | 1 |
| JET-MAIN,#200 (Ref # 92063A) | 92063-022 | 1 |
| JET-MAIN,#210 (Ref # 92063B) | 92063-023 | 1 |
| JET-MAIN,#220 (Ref # 92063C) | 92063-024 | 1 |
| JET-MAIN,#230 (Ref # 92063D) | 92063-025 | 1 |
| JET-PILOT,#35 (Ref # 92064) | 92064-1023 | 1 |
| JET-PILOT,#30 (Ref # 92064A) | 92064-1030 | 1 |
| JET-PILOT,#25 (Ref # 92064B) | 92064-1038 | 1 |
| JET-PILOT,#45 (Ref # 92064C) | 92064-1060 | 1 |
| JET-PILOT,#40 (Ref # 92064D) | 92064-1104 | 1 |
| SPRING,THROTTLE VALVE (Ref # 92081) | 16006-023 | 1 |
| SPRING,THROTTLE STOP SCREW (Ref # 92081A) | 16022-005 | 1 |
| SCREW-PAN-WS-CROS (Ref # 223) | 223B0416 | 4 |