

2000 KDX200 PARTS DIAGRAM

Clutch

E1350

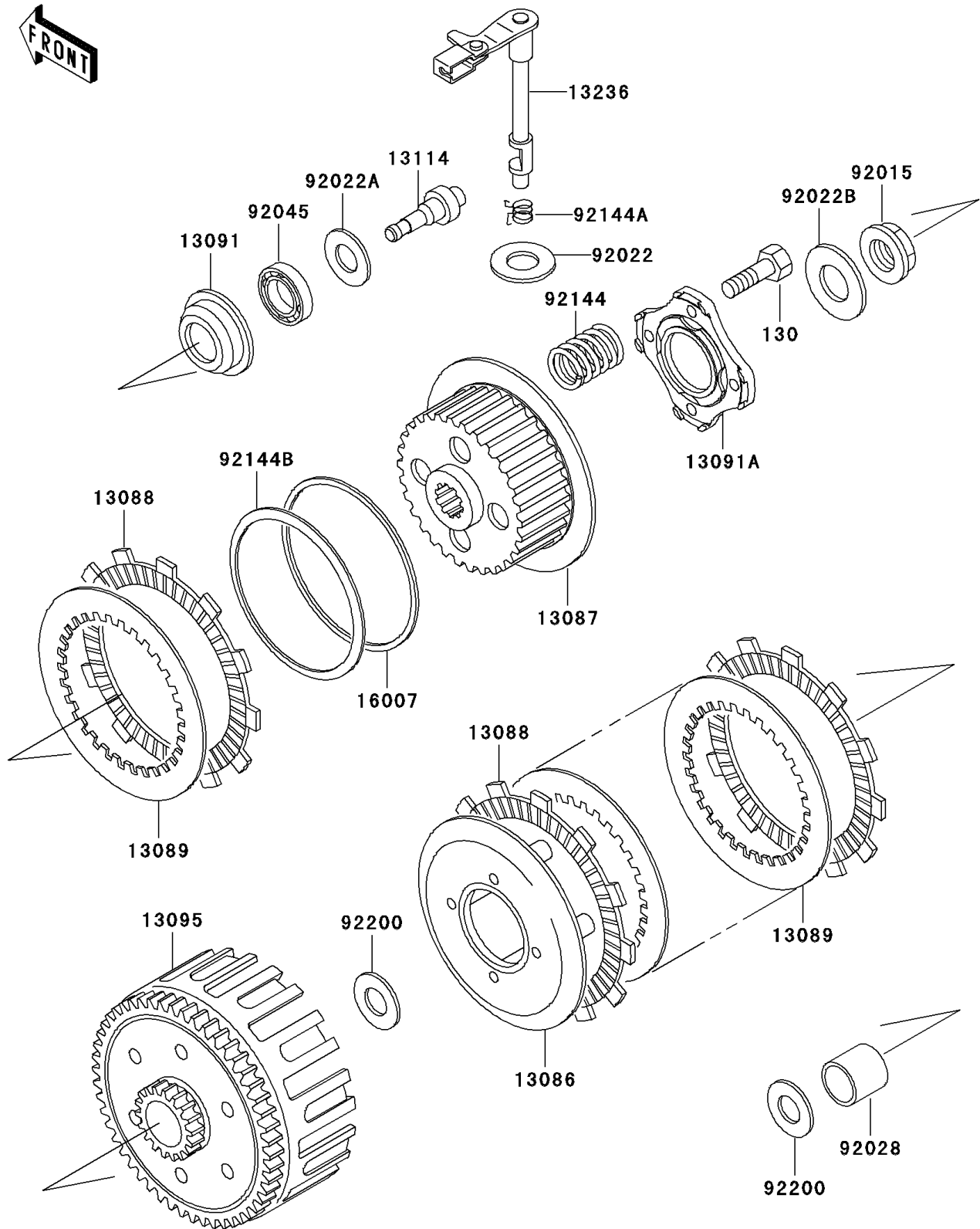

2000 KDX200 PARTS LIST

Clutch

| ITEM NAME | PART NUMBER | QUANTITY |
|---|-------------|----------|
| BOLT-FLANGED (Ref # 130) | 130Y0625 | 1 |
| WHEEL-CLUTCH (Ref # 13086) | 13086-1069 | 1 |
| HUB-CLUTCH (Ref # 13087) | 13087-1158 | 1 |
| PLATE-FRICTION (Ref # 13088) | 13088-1085 | 1 |
| PLATE-CLUTCH (Ref # 13089) | 13089-1076 | 1 |
| HOLDER,CLUTCH PUSHER (Ref # 13091) | 13091-1712 | 1 |
| HOLDER,CLUTCH SPRING (Ref # 13091A) | 13091-1872 | 1 |
| HOUSING-COMP-CLUTCH (Ref # 13095) | 13095-1287 | 1 |
| PUSHER-CLUTCH (Ref # 13114) | 13114-1067 | 1 |
| LEVER-COMP,CLUTCH RELEASE (Ref # 13236) | 13236-1264 | 1 |
| SEAT-SPRING (Ref # 16007) | 16007-1162 | 1 |
| NUT,16MM (Ref # 92015) | 92015-1581 | 1 |
| WASHER,12.5X21X1.2 (Ref # 92022) | 92022-072 | 1 |
| WASHER,10.2X14.5X1.0 (Ref # 92022A) | 92022-1181 | 1 |
| WASHER,16.3X29X1.75 (Ref # 92022B) | 92022-1356 | 1 |
| BUSHING,20X25X26.85 (Ref # 92028) | 92028-1388 | 1 |
| BEARING-BALL,6000 (Ref # 92045) | 92045-1225 | 1 |
| SPRING,CLUTCH (Ref # 92144) | 92144-1160 | 1 |
| SPRING,CLUTCH RELEASE (Ref # 92144A) | 92144-1287 | 1 |
| SPRING (Ref # 92144B) | 92144-1522 | 1 |
| WASHER,20.3X30X2.3 (Ref # 92200) | 92200-1238 | 1 |